

BL-SERIES ORCHARD BLOWER OWNER'S MANUAL

BL-Series Orchard Blower

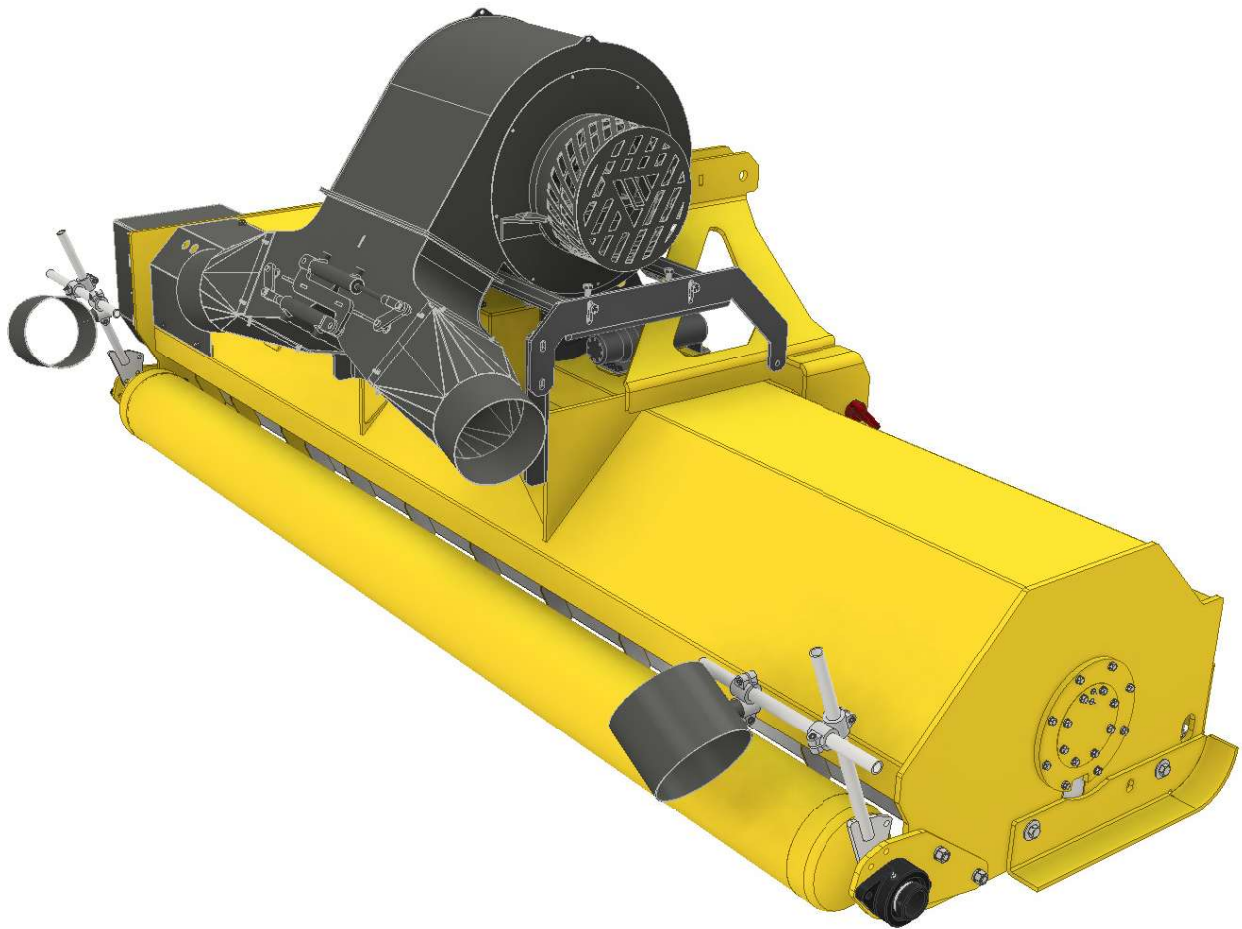

VALLEY TOOL
MANUFACTURING COMPANY

PO Box 220 | 2507 Tully Road | Hughson, CA 95326 | 800-426-5615
www.valleytoolmfg.com

Table Of Contents

Introduction

Thank You	1
Warranty	2

Safety

Operational Safety	3-4
Maintenance Safety	4

Installation

Installation on LP Version 2	5
Installation on Sanitizer	6
Installation on LP Version 3	7

Basic Operation

Hook Up Procedure	8
Starting Procedure	8
Running Your Attachment	8
Shut Down Procedure	8

Adjustments & Maintenance

Belt Tension	9-10
Blower Height Adjustments	10
Cleaning The Blower	10
Lubrication	10

CALIFORNIA PROPOSITION 65



WARNING: Cancer and Reproductive Harm - www.P65Warnings.ca.gov.



ADVERTENCIA: Cáncer y Daño Reproductivo - www.65Warnings.ca.gov.

Thank You

Dear Customer,

Thank you for purchasing a Vrisimo attachment. This manual has been prepared to acquaint you with the operation, adjustment and maintenance of your new attachment. It was carefully designed and manufactured under the highest industrial standards to give you years of dependable service. Read this manual carefully and fully understand the operation of the machine before attempting to operate it. Vrisimo Flail Mowers & Shredders reserves the right to make changes in design and specifications, and/or to make additions to or improvements in its product without imposing any obligation upon itself to install them on its products previously manufactured. If at any time you require additional information, consult your authorized dealer or the customer service department.



PO Box 220 | 2507 Tully Road | Hughson, CA 95326

1-800-426-5615

www.valleytoolmfg.com

ATTENTION

The safety of the operator was one of the primary concerns of Vrisimo Flail Mowers & Shredders when designing this attachment. Shielding, simple adjustments and other safety features were built into this attachment whenever possible. Be sure you and the people working for you read and understand this manual. All machinery should be operated only by responsible persons who have been trained to operate in a safe manner and have read and understand this manual.

IMPORTANT TO PURCHASER

Customer Ownership Registration

Prior to acceptance of the equipment, thoroughly check off the pre-delivery checklist with the sales representative. Be sure you fully understand the operation, adjustment and safety rules as outlined in this manual.

Vrisimo Flail Mowers & Shredders is solely owned by Valley Tool and Manufacturing.

Have industrial applications? Own a skid steer or mini excavator? For our full line of industrial equipment visit: www.valleytoolmfg.com

Warranty

For a period of 12 months from date of delivery of product to the original user/owner, Valley Tool & Mfg. warrants each product to be free from manufacturing defects, subject to the limitations contained in this policy.

This warranty does not apply to defect caused, in whole or in part, by unreasonable use while in the possession of the user, including, but not limited to: failure to properly set up product; failure to provide reasonable and necessary maintenance; normal wear; routine tune ups or adjustments; improper handling or accidents; operation at speed or load conditions contrary to published specification; improper or insufficient lubrication; improper storage. This warranty is also not a guarantee that the performance of each product will meet the expectations of the purchaser.

Valley Tool & Mfg. shall not be liable for consequential damages of any kind, including, but not limited to: consequential labor costs or transportation charges in connection with the replacement or repair of defective parts; lost time or expense which may have accrued because of said defects. In no event shall Valley Tool & Mfg. total liability hereunder exceed the product purchase price.

Valley Tool & Mfg. makes no warranty with respect to trade accessories or any components or accessory of the product which was not manufactured by Valley Tool & Mfg., including any purchased components of any kind. These are subject to the warranties of their respective manufacturers. The warranty will be considered void if the product or any part of the product is modified or repaired in any way not expressly authorized by Valley Tool & Mfg., or if closed components are disassembled prior to return. Closed components include, but are not limited to: gearboxes, hydraulic pumps, motors, cylinders, and actuators.

Our obligation under the warranty is expressly limited, at our option, to the replacement or repair at Valley Tool & Mfg., of Hughson CA, or at a service facility designated by us, or such part or parts as inspection shall disclose to have been defective. We are not responsible for unauthorized repairs or replacements. Warranty must be pre-approved. Authorized parts will be sent to dealer UPS at no charge. Any implied or statutory warranties, including any warranty merchantability or fitness for a particular purpose, are expressly limited to the duration of this written warranty. We make no other express or implied warranty, nor is anyone authorized to make any on our behalf. This warranty cannot be extended, broadened, or changed except in writing by an authorized officer of Valley Tool & Mfg. No warranty will be processed without the timely registration of the signed "Delivery Report".

Travel time of mechanics and transportation of the product to the authorized service dealer for warranty work are the responsibility of the attachment owner.

Valley Tool & Mfg offers the most reasonable and dealer -friendly return policy in the market. We will accept returns within 30 days of original receipt. All returns must be approved by Valley Tool & Mfg and a return authorization number must be issued prior to return shipment. Returns must be received in "like-new" condition and with all of the original factory packaging including manuals. Additional charges will apply if an item is received that is not in "like-new" condition or that is not in original factory packaging. After a return has been fully inspected by our staff, refunds will issued less shipping charges and any other possible damage fees. Please allow up to 30 business days for your account refund credit to be processed.

Please direct all return-related questions to sales@valleytoolmfg.com.

Safety

Failure to heed any of these warnings may result in personal injury or death.

A. Operational Safety

Before operating this machinery read the owner's manual thoroughly.

Do NOT operate this machine without proper training. It is the Owner's responsibility to ensure all Operators are properly trained in the appropriate language.

Use OSHA approved eye, ear and head protection to protect the Operator from flying debris and noise.

Avoid wearing loose clothing as it can inadvertently be drawn into moving parts. Never use drugs or alcohol before or during operation of this machine.

Only operate this machine when it is in good working order on an appropriate power unit that is in good working order, and with all guards and safety devices in place and functioning.

Be aware of the machine's weight and its effect on the stability of the power unit.

Use flashing warning lights when operating on highways, except when prohibited by law.

Always inspect area to be worked to ensure that the jobsite is free from obstacles and debris that could injure the operator or damage the machine.

Operate at a safe speed (typically 0-5 mph) in consideration of the local terrain, moving slower when operating on or near slopes, ditches or drop-offs.

Avoid running the machine along the ground in rocky areas as this could create dangerous discharge.

Keep bystanders and children clear of the work area during operation as debris can be discharged in a dangerous manner. The minimum safe distance from discharge is 100 ft.

Never allow children or other persons to ride on this machine.

Be aware that this machine may be wider than the power unit, and caution should be used to avoid clipping or running over trees, signs or posts that may be in the way of the machine.

Avoid operation that would allow hydraulic lines to be pinched or severed. In the event of a hydraulic leak, hydraulic fluid may have sufficient force to penetrate skin. Hydraulic injection injury requires immediate medical attention.

Be aware of the risks of equipment and grass fires. To mitigate those risks:

- Do not smoke or have an open flame in the work area.
- Do not operate in areas that have been freshly burned or are still burning.
- Do not allow clippings/debris to collect near hydraulic components or bearings.
- Avoid areas with high fire risk: dry grass, brush or trees.

Operation of this machine should be stopped immediately if the Operator's vision becomes obscured by the discharge of debris and dust. Also avoid operating this machine in unusually foggy or dusty conditions or at night.

Keep away from the machine until all the energy has dissipated. This includes the complete stopping of the drum's rotation as well as the dissipation of pressure in the hydraulic lines.

In the event that a failure does occur during operation or if the machine begins to produce excessive noise or vibration, shut the machine down immediately and repair before continued use.

In addition to the design and configuration of equipment, hazard control and accident prevention are dependent upon the awareness, concern and prudence and requires suitable training of personnel involved in the operation, transport, maintenance and storage of equipment.

B. Maintenance Safety

Before performing maintenance on this machine read the owner's manual thoroughly.

Maintenance should only be performed by properly trained individuals. It is the owner's responsibility to ensure all individuals involved in maintaining the machine are properly trained in the appropriate language.

Be sure to inspect all safety devices before each use. If safety devices are worn in such a way that they can no longer properly perform their guarding function contact your nearest Vrisimo dealer for replacements.

Maintain all safety decals and make sure they are visible to the operator. If decals are worn, contact your nearest Vrisimo dealer for replacements.

Wear gloves and eye protection and exercise care when handling blades as they can be sharp. Also be alert to worn or damaged surfaces that could have sharp edges.

Disengage PTO, shut off engine and allow all movement to stop before leaving the operator's position to adjust, lubricate, clean or unclog the machine. Do not try to uncouple hydraulic hoses unless the pressure has adequately dissipated.

Before working on or underneath the machine, place wheel chocks in front and back of power unit's tires or treads and under each end of the attachment to prevent accidental lowering of the machine. Also, remove the ignition key from the power unit and allow all movement to stop before beginning work.

Installation Procedure

A. Installation on LP Version 2 (2005-2021)

1. Install rear brackets.
2. Remove yoke from gearbox.
 - a. Shorten top shaft by 6" and add a keyway.
3. Install frame rails. Match drill using $\frac{1}{2}$ " drill bit. Center punch to match frame rails. *Recommend using HSS Silver and Deming 135° Split Point.*
4. Install 6-spline adapter assembly. Place belt over pulley. Add top shaft.
5. Install blower assembly on frame. Place belt over blower pulley.
6. Tension belt using 4X jack screws.
7. Lock frame using slide bolts. Install guards.
8. Install end-duct assembly on left and right sides.
9. Install hose on each side

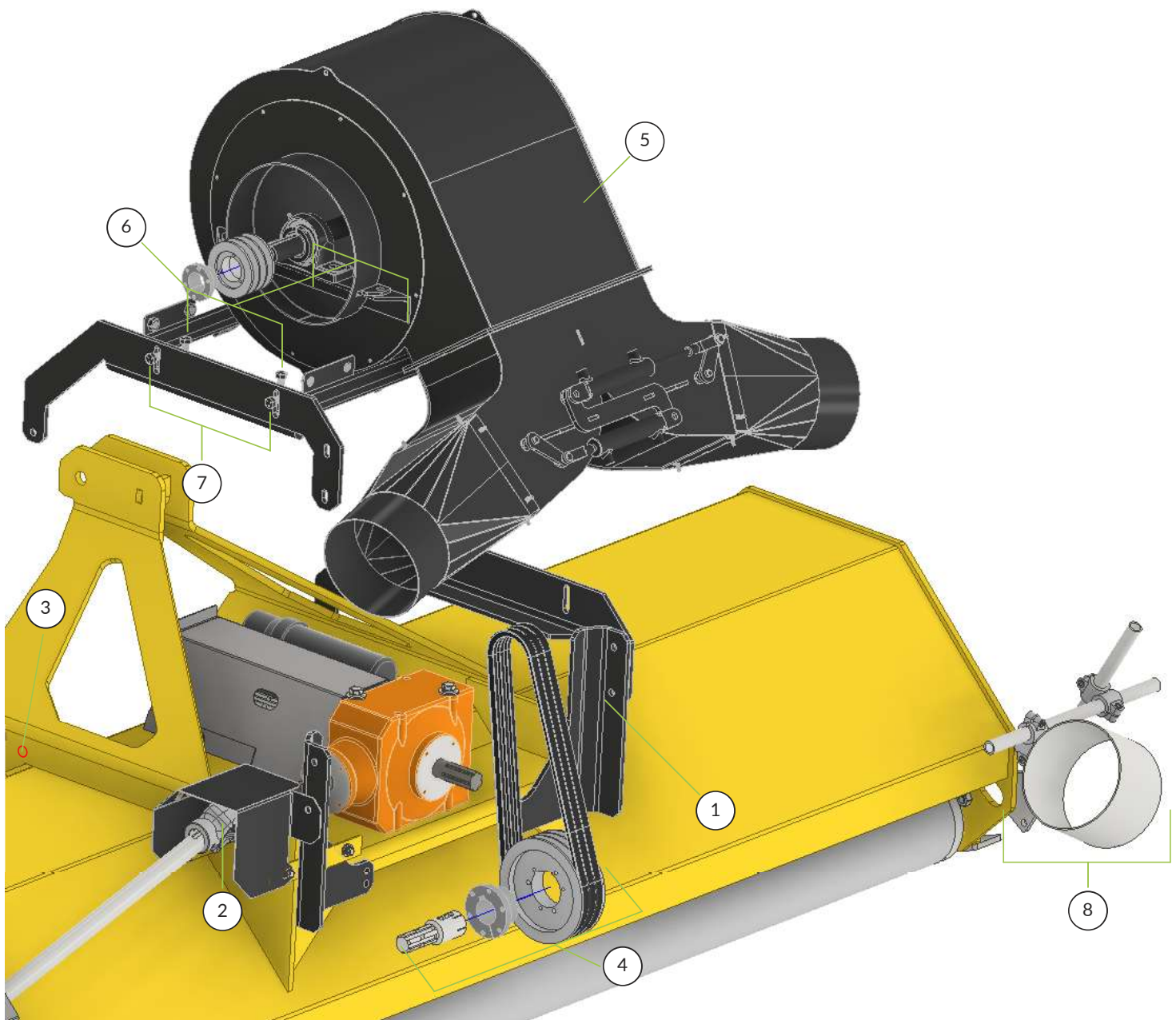

Installation Procedure

B. Installation on Sanitizer

1. Install rear brackets.
2. Remove yoke from gearbox.
 - a. Shorten top shaft by 6" and add a keyway.
3. Install frame rails. Match drill using $\frac{1}{2}$ " drill bit. Center punch to match frame rails. *Recommend using HSS Silver and Deming 135° Split Point.*
4. Install 6-spline adapter assembly. Place belt over pulley. Add top shaft.
5. Install blower assembly on frame. Place belt over blower pulley.
6. Tension belt using 4X jack screws.
7. Lock frame using slide bolts. Install guards.
8. Install end-duct assembly on left and right sides.
9. Install hose on each side

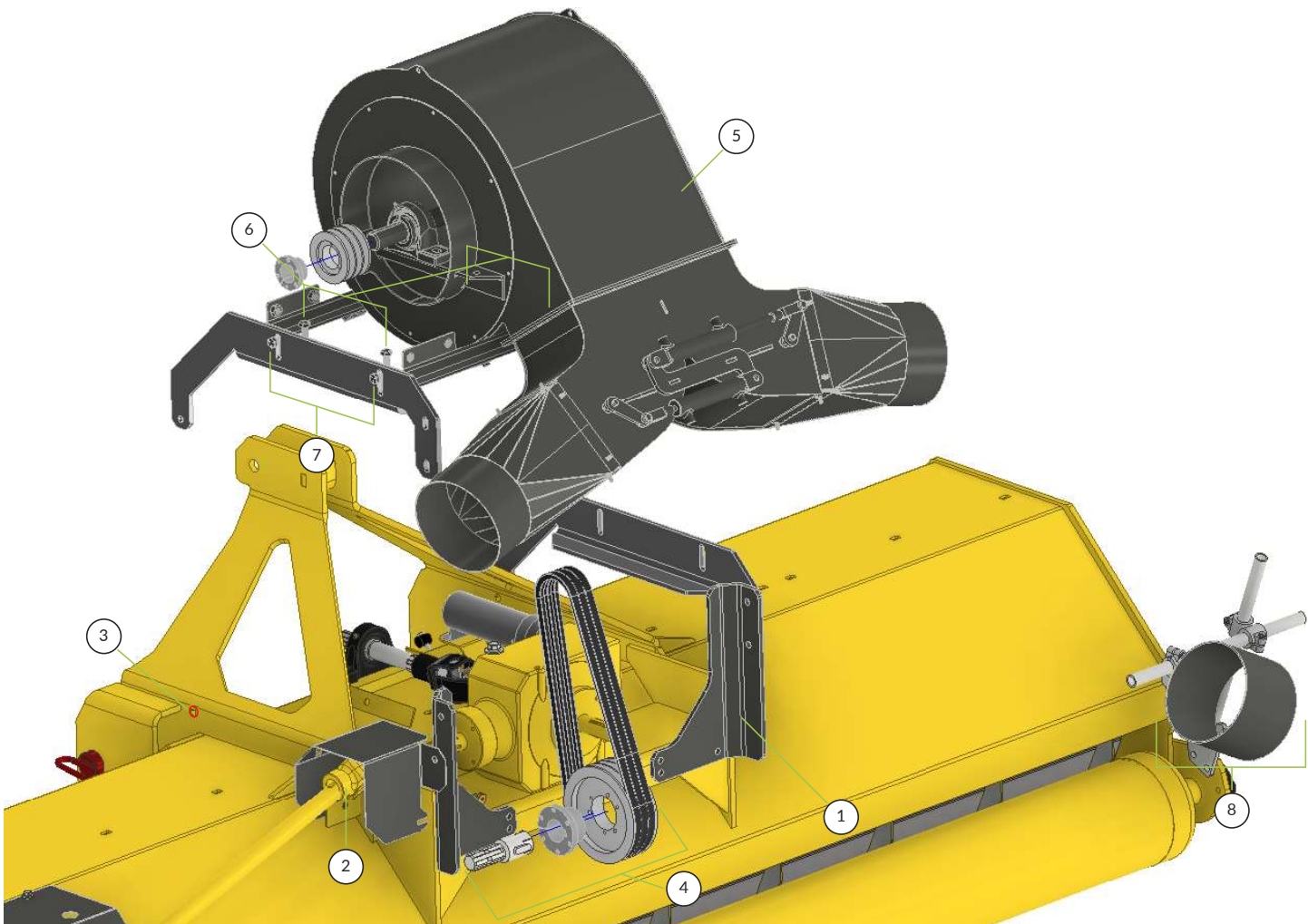

Installation Procedure

C. Installation on LP Version 3 (2022+)

1. Install rear brackets.
2. Remove yoke from gearbox.
3. Install frame rails.
4. Install 6-spline adapter assembly. Place belt over pulley. Add top shaft.
5. Install blower assembly on frame. Place belt over blower pulley.
6. Tension belt using 4X jack screws.
7. Lock frame using slide bolts. Install guards.
8. Install end-duct assembly on left and right sides.
9. Install hose on each side

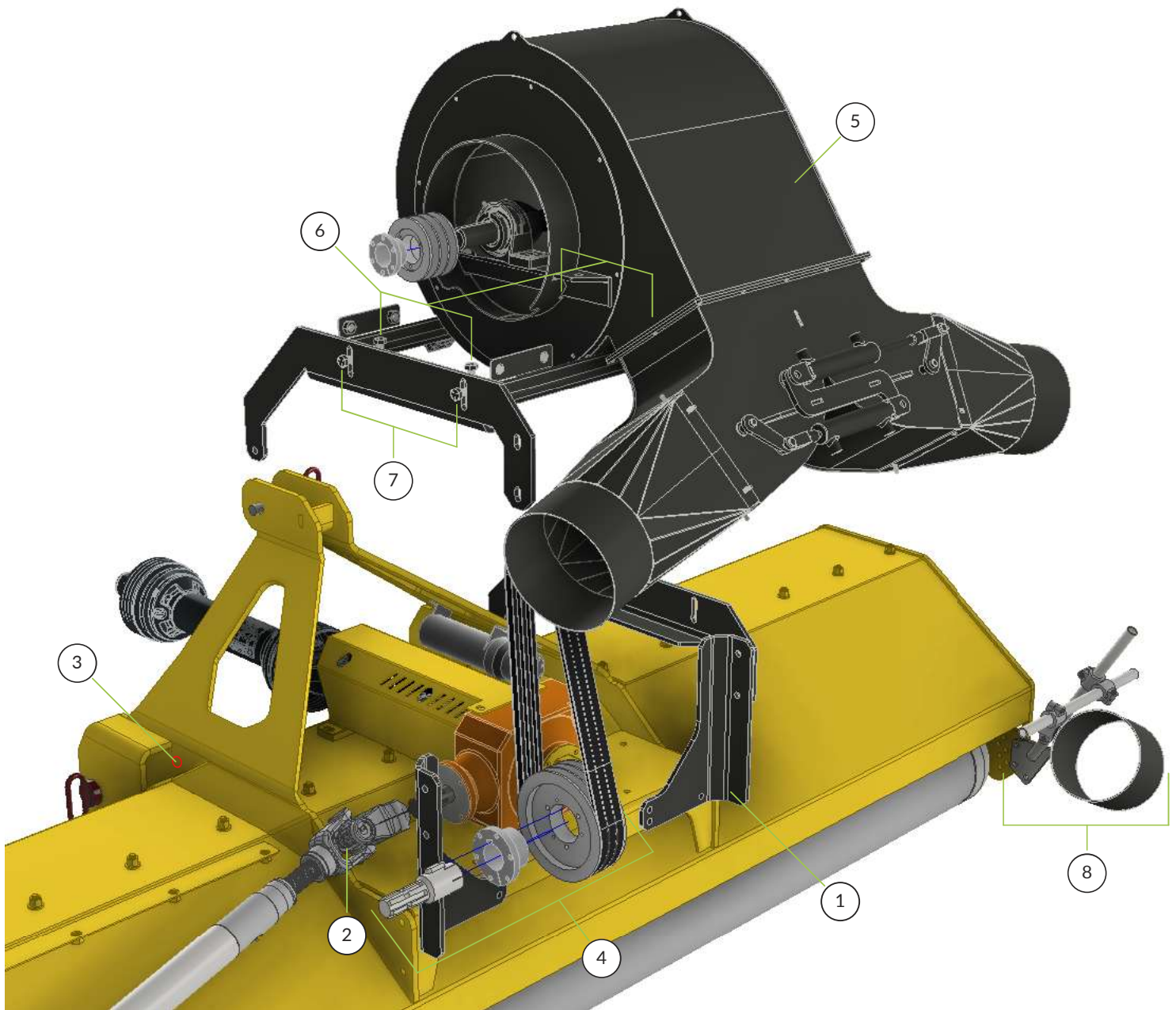

A. Hook Up Procedure

1. Align tractor with implement. Attach lower lift arms.
2. Attach upper 3-point arm. Adjust length for desired approach angle.
3. Install PTO, tube attached to mower, bar attached to tractor.
4. Connect hydraulic lines to tractor remotes. Typical install will require two remotes, one for each nozzle control cylinder.
5. With the attachment and PTO line connected check the drive shaft through the entire lifting range checking for binding, bottoming, uncoupling, or attachment contact.

B. Starting Procedure

1. Start engine and set throttle to idle. Never engage the PTO with the motor above idle speed.
2. With the motor at low RPM engage the PTO output.
3. Slowly bring the throttle up to 540 PTO RPM. If the Attachment produces excessive noise or vibration, disengage the PTO and shut down the Power Unit immediately. Determine the cause of the problem and correct it before continuing with its operation.
4. Check functionality of each nozzle control cylinder.
5. Attachment is ready for operation.

C. Running Your Attachment

1. Determine ground speed based on terrain and material being cut. This will typically fall within the 0-5 mph range.
2. Adjust the hitch to the approximate desired cutting height.
3. Adjust blower nozzles to achieve desired effect
4. Make sure PTO is properly attached.

D. Shut Down Procedure

1. Shut off Power Unit and set parking brake, wait for the attachment to stop rotating.
2. Disengage the PTO drive and position it for storage or transport (See the "Storage and Transport" section for details on proper storage).
3. Visually inspect the PTO shaft, all the bearings and gearbox for excessive heat or leaks.

Adjustments & Maintenance

Note: Before performing maintenance, ensure all motion has stopped and that the Power Unit is powered down with ignition key removed. Before working on or underneath the machine, place blocks on both sides of the Power Unit's tires and underneath both ends of the machine to prevent accidental lowering of the machine.

Wear components such as belts and bearings may wear at different rates. Each should be inspected for wear independently.

A. Belt Tension

1. Belt adjustment is achieved by raising and lowering the blower assembly in the blower support frame.
 - a. To adjust belt, loosen frame bolts and use jack screws to raise or lower blower assembly to desired tension.
 - b. There are 4 jack screws used to adjust height, turn counterclockwise to lower and clockwise to raise.
 - c. Adjustment of left or right side more than the other can be used to adjust pulley angle as required.
 - d. Use a straight edge to ensure pulleys are in line.

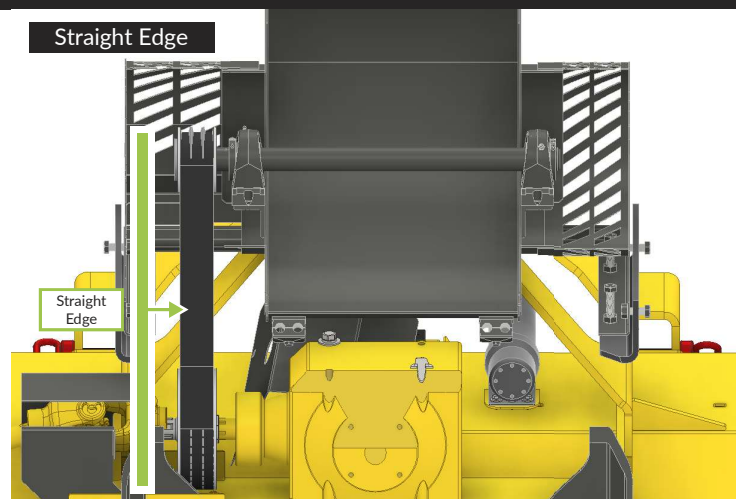
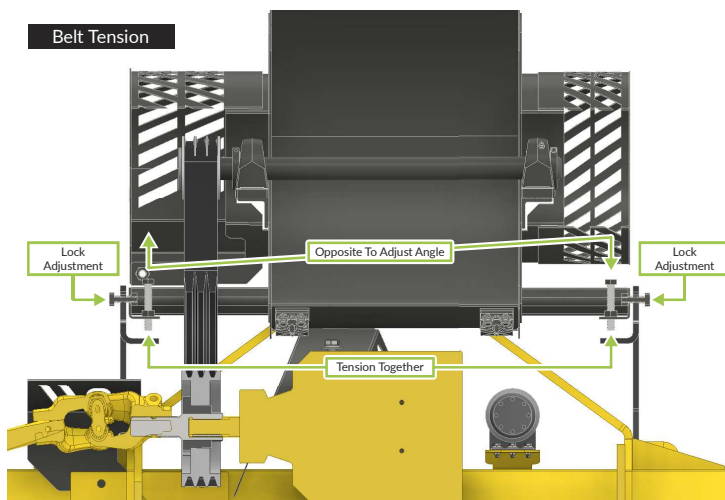

2. Run-In

- a. Check tension after 2 hours of operation from first startup.
- b. Add tension as required using instructions above.

3. Routine Tensioning

- a. Check tension every 10 hours of operation or before startup each day.
- b. Belt will stretch over time.
- c. Operating with loose belt will cause excess heat and result in belt failure.

4. Belt Life

- a. Replace belt when worn, cracked, or damaged.
- b. Protect from sunlight when stored for extended period
- c. Life can be extended by removing tension during storage.

Adjustments & Maintenance

Tension Diagram

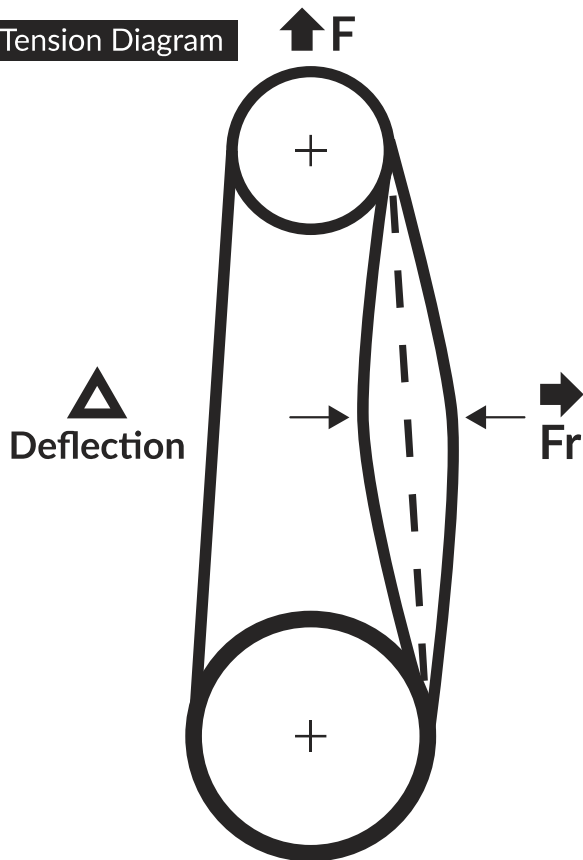

	NEW	USED
F =	480 - 514 lbf.	412 - 446 lbf.
Δ =	¼" Deflection	¼" Deflection
Fr =	5.5 - 5.9 lbf.	4.8 - 5.2 lbf.

B. Blower Height Adjustments

1. The output nozzle height of the blower can be adjusted by sliding nozzle support tube to desired position.

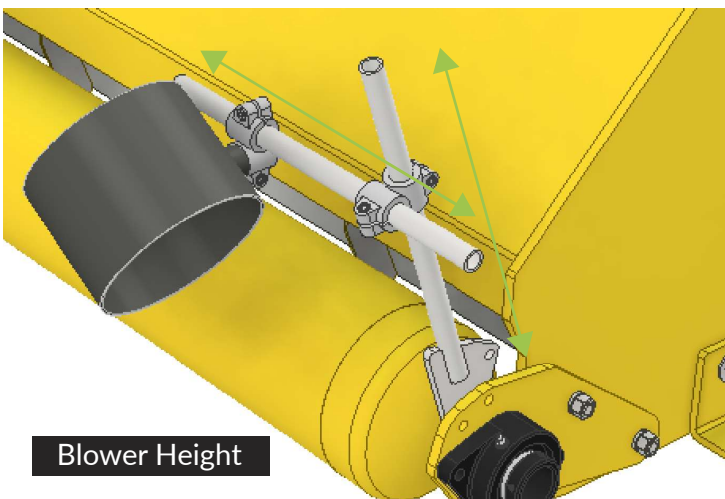

Blower Height

C. Cleaning The Blower

1. Check for excessive grease in bearing areas on the pulley side of the blower. Make sure that grease is not allowed to get into the belt areas.
2. Clean any clippings from the gearbox areas, pulley areas and anywhere else that is prone to excessive heat where fire can start.
3. Clean the inside of the blower with a pressure washer make sure the inside of the blower is kept free from mud and compact grass. Keep in mind that mud built up on the blower fan can cause imbalance.
4. Preserve damaged decals or replace them if they are unreadable. Decal kits can be obtained from your local Vrisimo dealer.

D. Lubrication

Valley Tool recommends greasing with **NGLI 2 ISO VG460**. Any lithium based NGLI Grade 2 grease that is ISO 460 VG and of high quality will work. DO NOT use grease designed for tractor pins and bushings.

Lubrication Schedule

LUBRICATION	FLUID	INTERVAL HRS
U-Joints	NGLI 2 ISO VG460	10
Bearings Flange	NGLI 2 ISO VG460	10

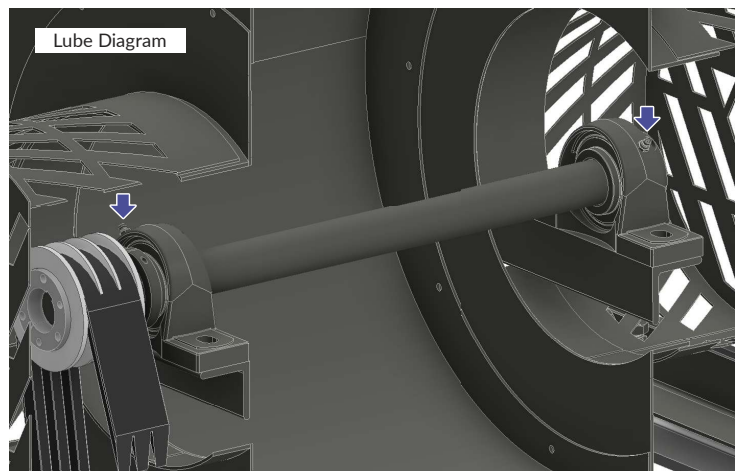

Lube Diagram

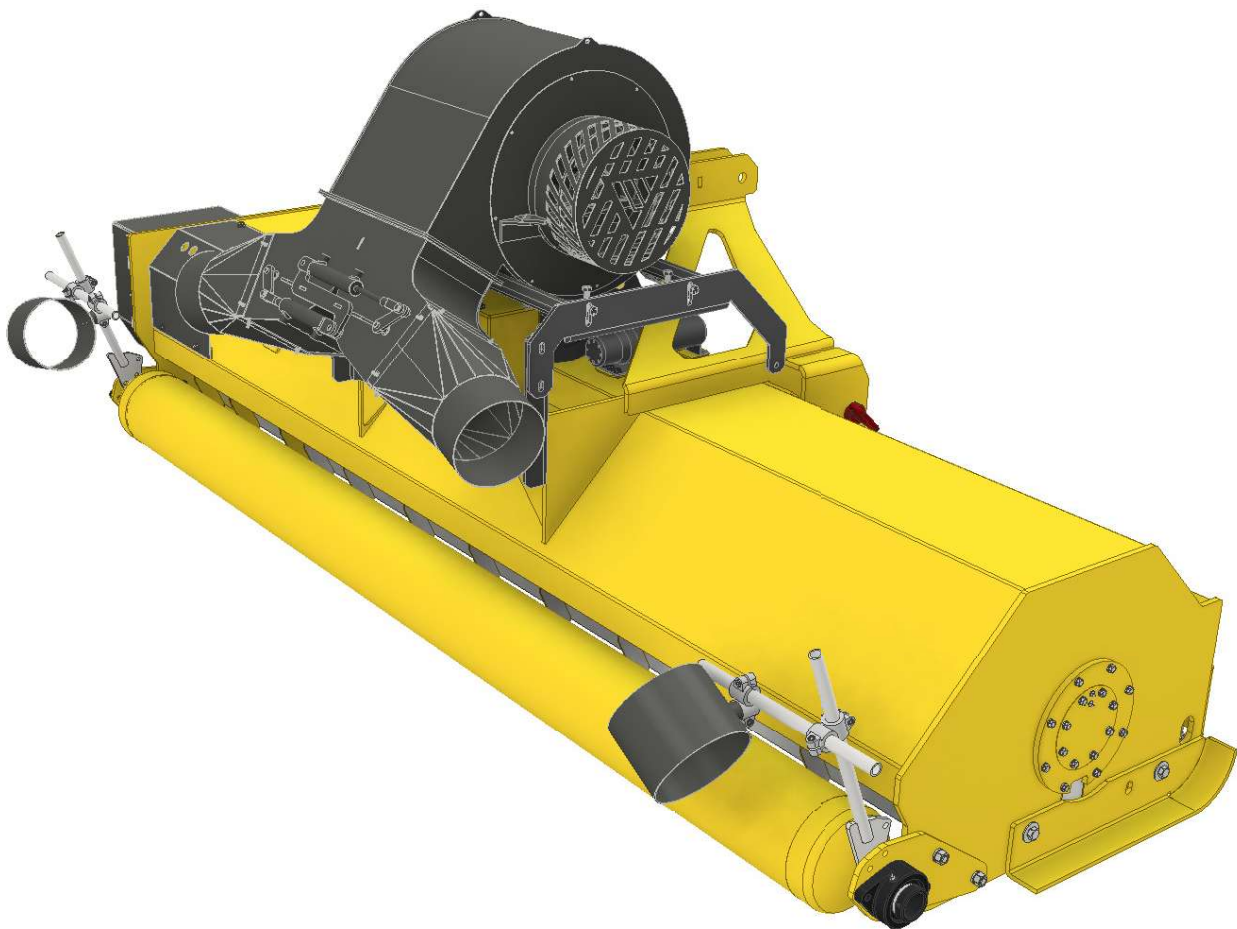

Parts: DIAGRAM 1

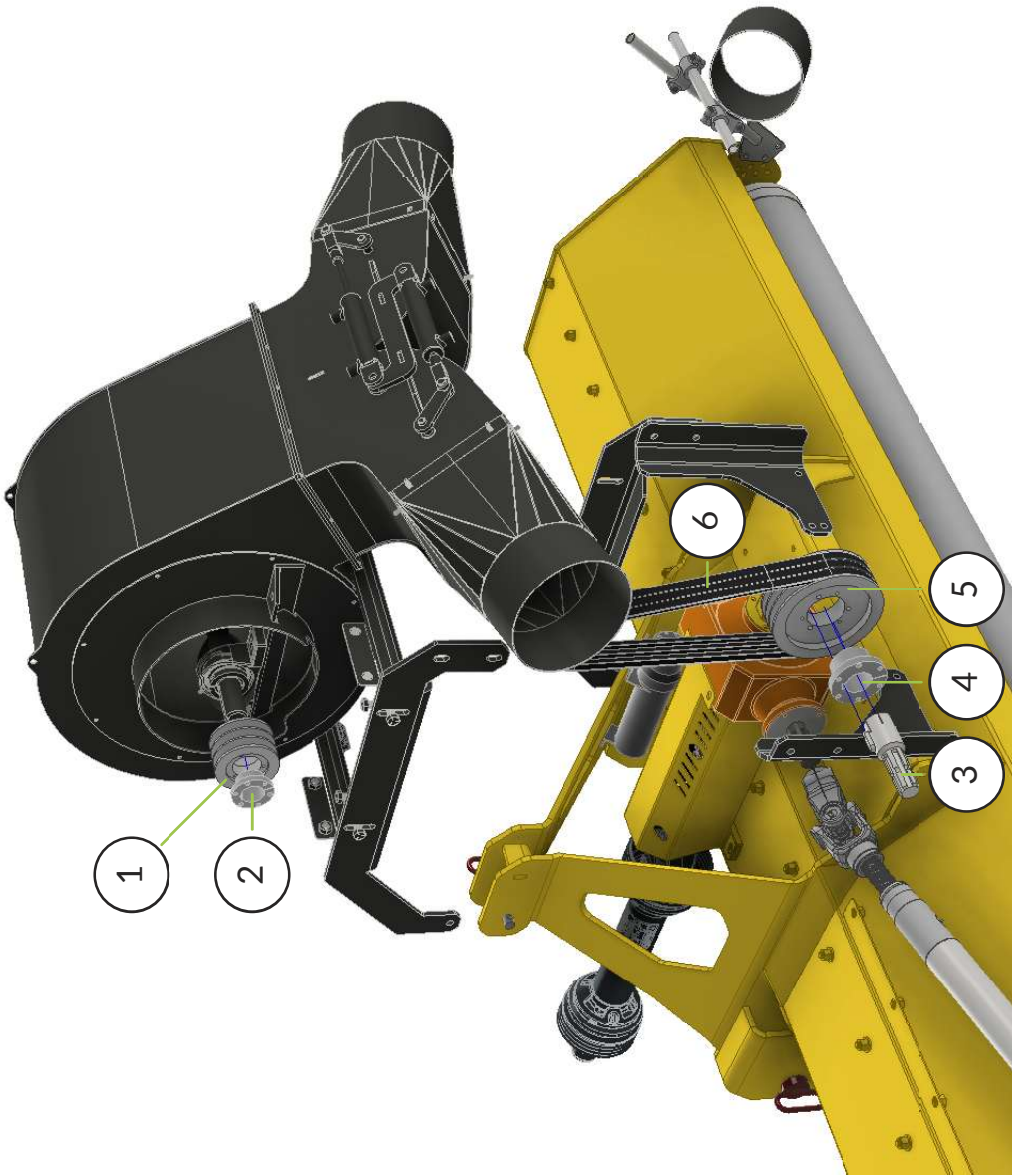

	DESCRIPTION	MODEL	QTY	P/N
1	SHEAVE B-SECTION	ALL	1	P-1462
2	BUSHING SH 1.5 QD	ALL	1	TL-1620
3	ADPTR HUB Z6 BARECO B 255	ALL	1	06043
4	BUSHING SK 1 ¹³ / ₁₆ "	ALL	1	TL-1625
5	SHEAVE SK	ALL	1	P-1460
6	BELT 3BX-50 HI-POWER II	ALL	1	B-156A
7	LOCKING COLLAR 1 ¹⁵ / ₁₆ " (NOT SHOWN)	ALL	1	C-194

Parts: DIAGRAM 2

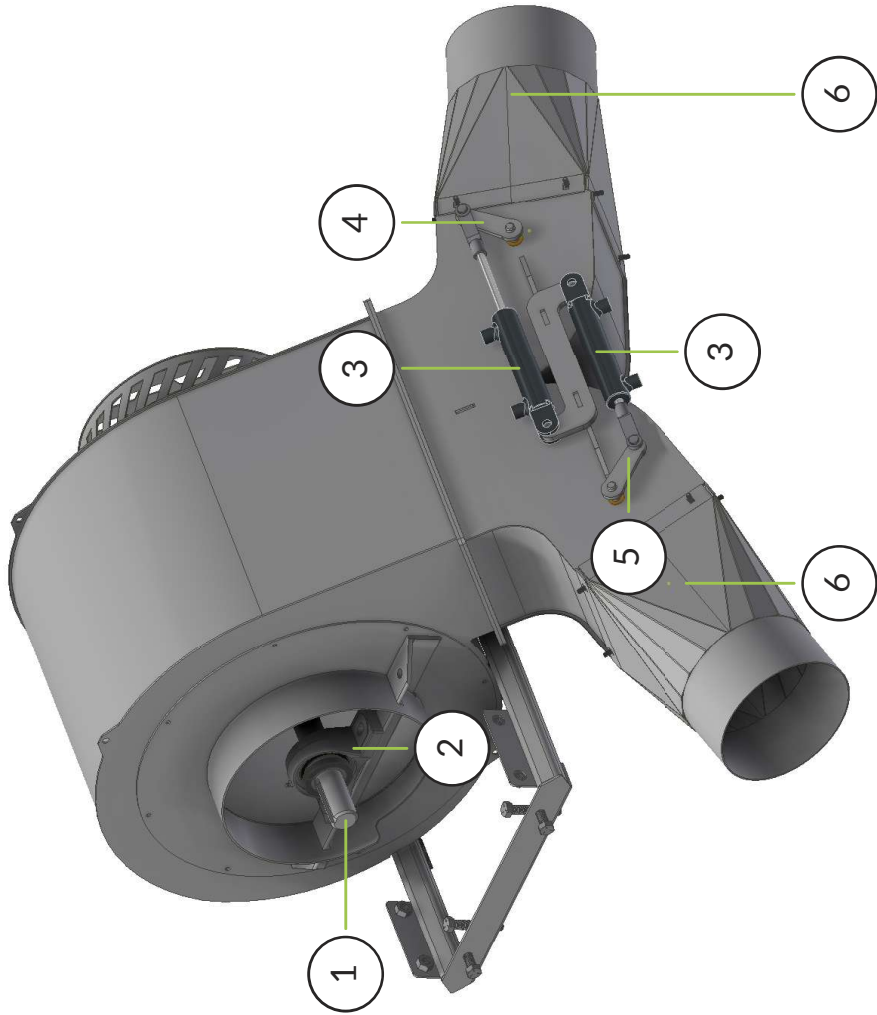

	DESCRIPTION	MODEL	QTY	P/N
1	ASY WLDMT FAN BL24 V3	ALL	1	09847
2	BEARING 1.5 PILLOW BLOCK	ALL	2	UEP 208-24-1500
3	12 CYL HYD HCI 4IN STRK	ALL	1	SPEI004-HC
4	SHAFT WELDMENT RH BUTTERFLY VALVE 8X8	ALL	1	05810
5	SHAFT WELDMENT LH BUTTERFLY VALVE 8X8	ALL	1	05815
6	OUTPUT DUCT 8X8 TO ROUND WELDMENT	ALL	2	05768

Parts: DIAGRAM 3

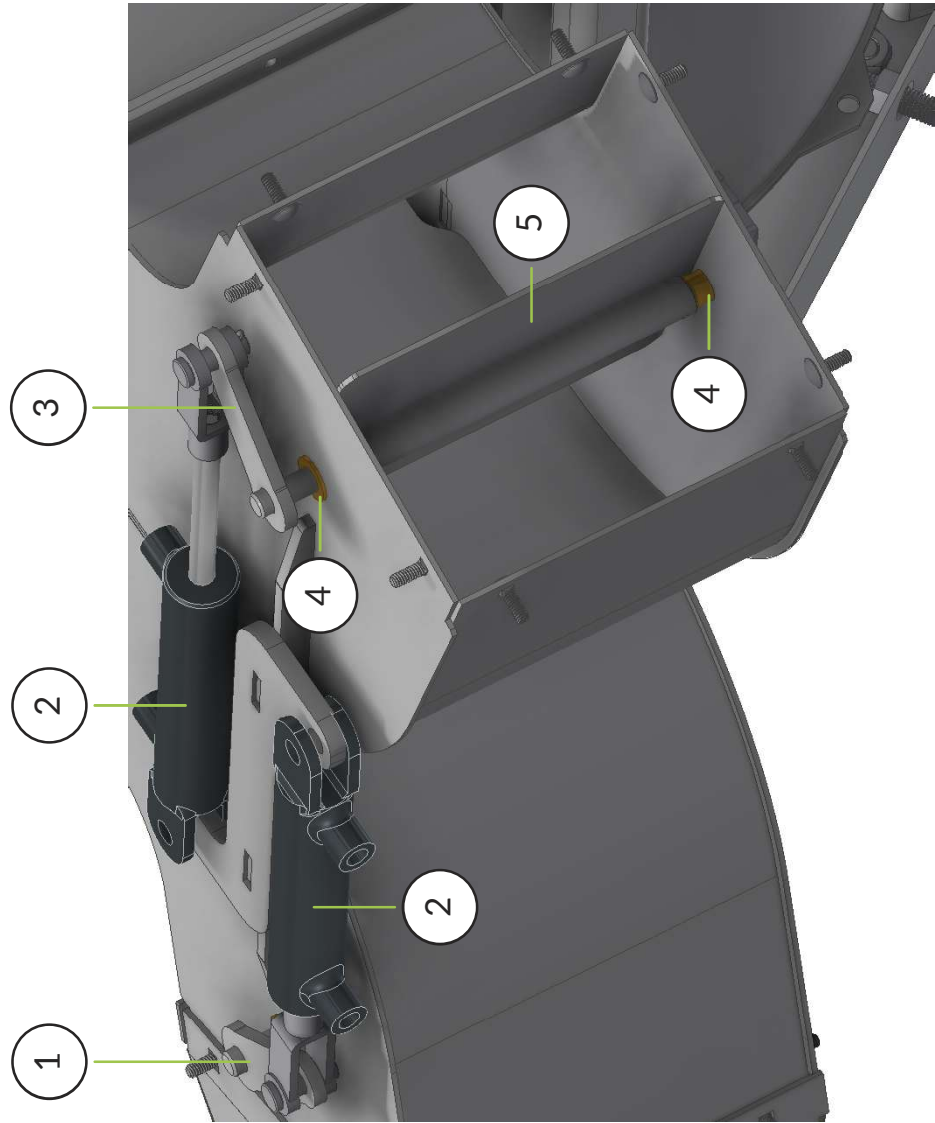

	DESCRIPTION	MODEL	QTY	P/N
1	SHAFT WELDMENT LH BUTTERFLY VALVE 8X8	ALL	1	05815
2	CYL HYD HCI 4IN STRK	ALL	2	SPEI004-HC
3	SHAFT WELDMENT RH BUTTERFLY VALVE 8X8	ALL	1	05810
4	FLL-BRG 1/2 x 5/8 x 1/2 LG	ALL	4	6338K572
5	ASY BUTTERFLY VALVE WELDMENT	ALL	2	05809

Parts: DIAGRAM 4

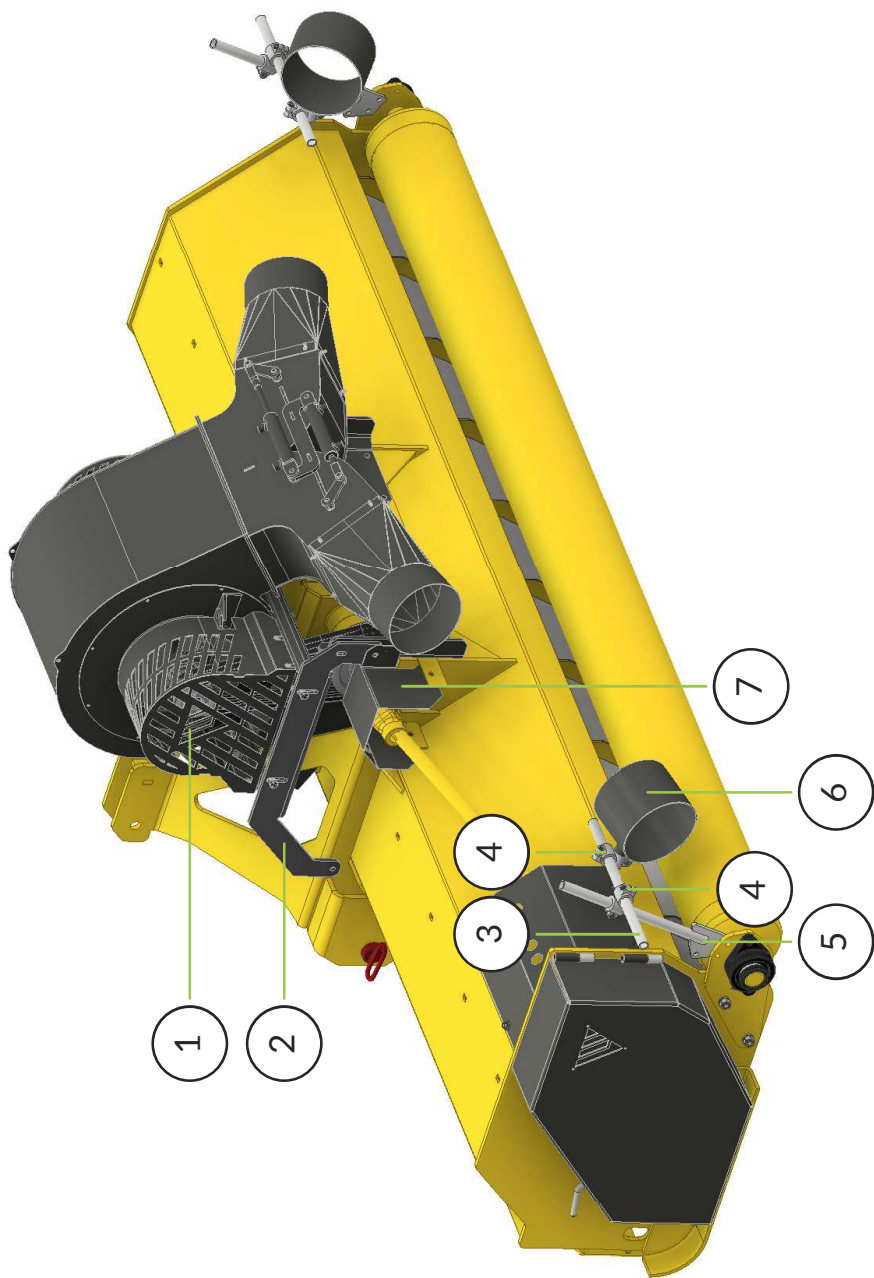

DESCRIPTION	MODEL	QTY	P/N
1 ASY GUARD WELDMENT INPUT	ALL	1	05952
2 BLOWER LH MOUNT PLATE	ALL	1	05824
3 NOZZLE MOUNT HORIZONTAL TUBE 1.0 OD	ALL	2	05782
4 FRAMING FTG XOVR THROUGH CONNECTOR	ALL	2	9578T21
5 NOZZLE MOUNT VERTICAL TUBE WELDMENT	ALL	2	07205
6 OUTPUT NOZZLE 8IN WELDMENT	ALL	2	05781
7 GUARD TOP SHAFT REPLY FOR BERM BLOWER	SANITIZER	1	05954

Parts: DIAGRAM 5

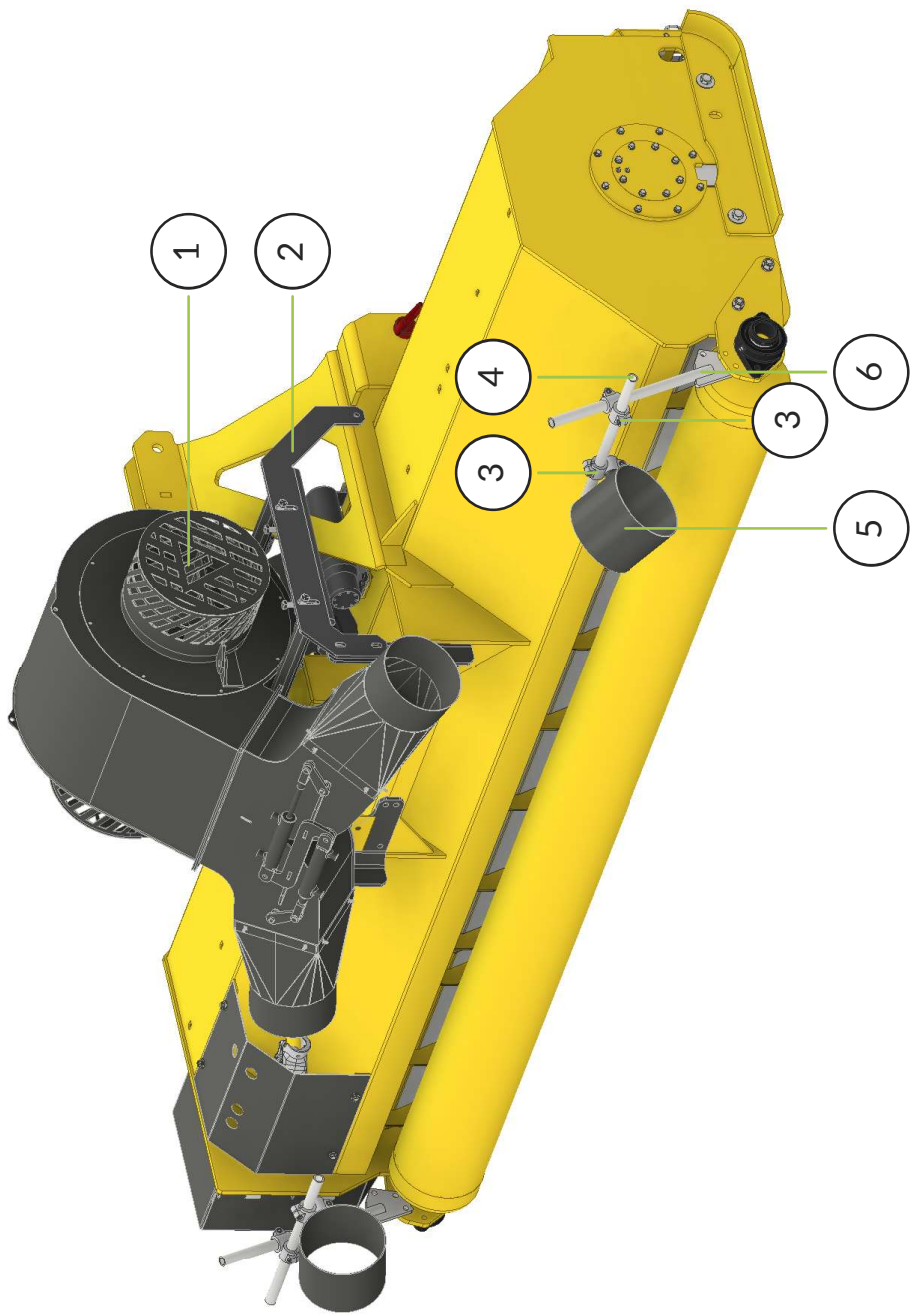

	DESCRIPTION	MODEL	QTY	P/N
1	ASY IDLE GUARD LP BERM BLOWER	ALL	1	05947
2	BLOWER RH MOUNT PLATE	ALL	1	05826
3	FRAMING FTG XOVR THROUGH CONNECTOR	ALL	2	9578T21
4	NOZZLE MOUNT HORIZONTAL TUBE 1.0 OD	ALL	2	05782
5	OUTPUT NOZZLE 8IN WELDMENT	ALL	2	05781
6	NOZZLE MOUNT VERTICAL TUBE WELDMENT	ALL	2	07205

REVISION: BL24-221220

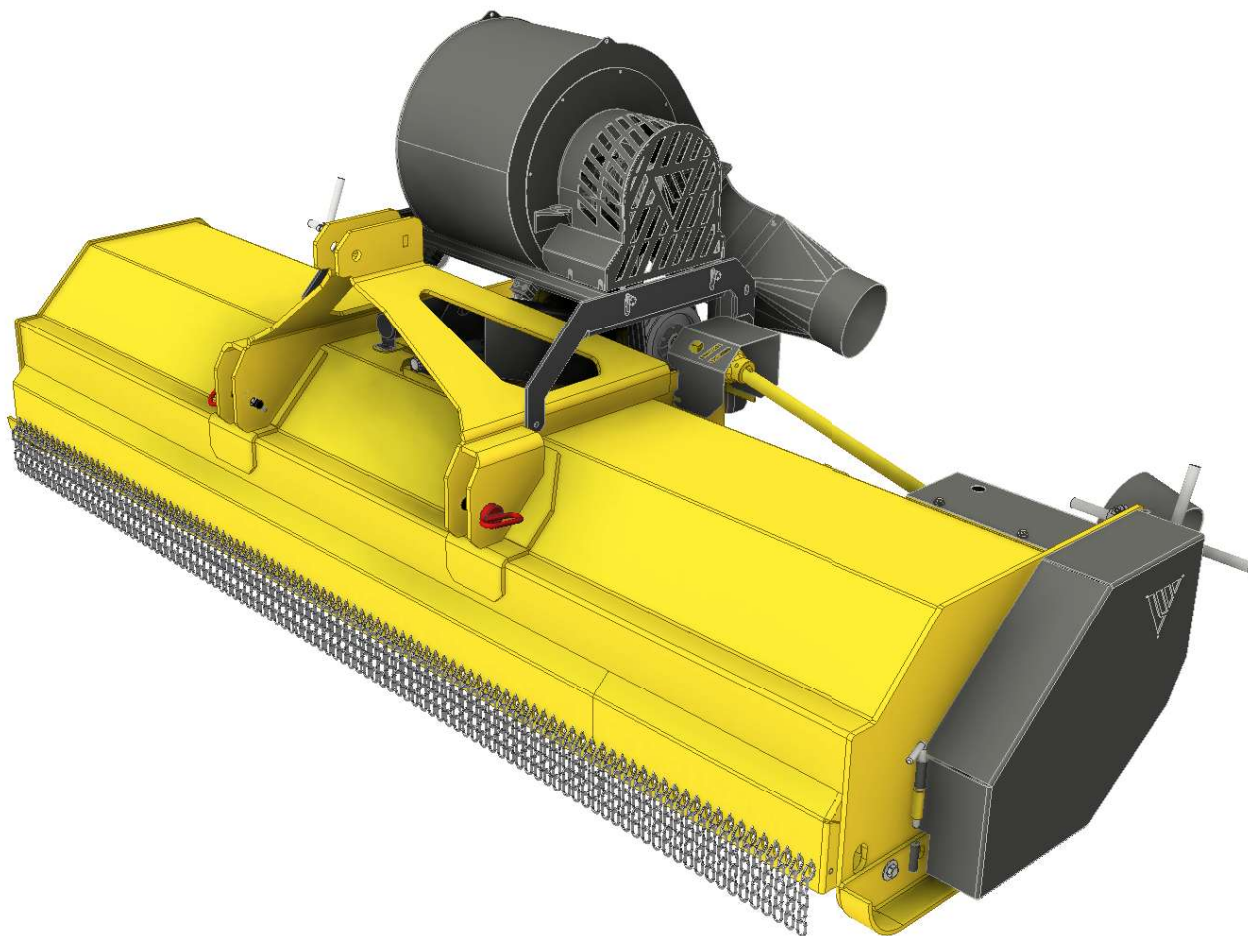

BL-SERIES ORCHARD BLOWER OWNER'S MANUAL



VALLEY TOOL

MANUFACTURING COMPANY

PO Box 220 | 2507 Tully Road | Hughson, CA 95326 | 800-426-5615

www.valleytoolmfg.com