

Orchard Low Profile Series

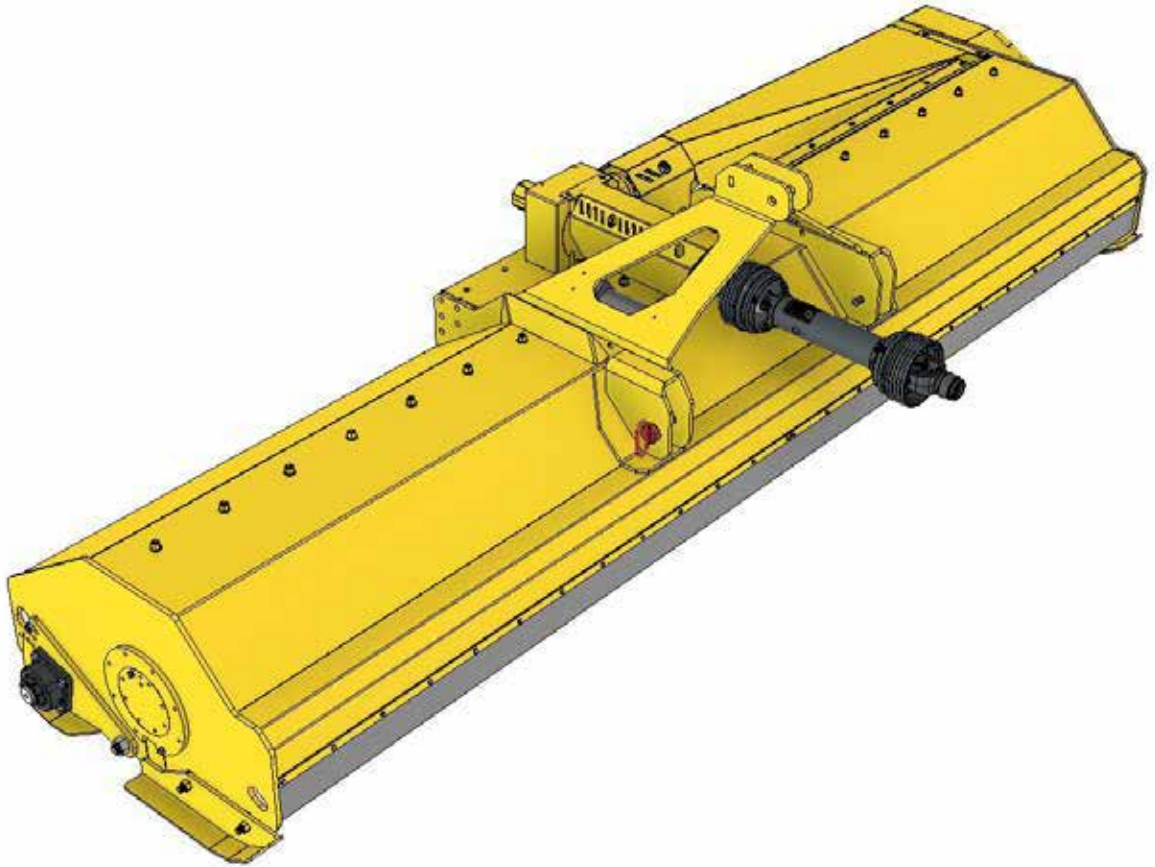

Vrisimo
FLAIL MOWERS & SHREDDERS



VALLEY TOOL

MANUFACTURING COMPANY

PO Box 220 | 2507 Tully Road | Hughson, CA 95326 | 800-426-5615

www.valleytoolmfg.com

Table Of Contents

Introduction

Thank You	1
Warranty	2

Safety

Operational Safety	3
Maintenance Safety	4

Basic Operation

Attaching to Power Unit	5
Starting / Running / Shut Down	5-6

Adjustments & Maintenance

Cut Height / Wear Components / Cleaning	7-8
Lubrication	9-10

Transport

Transport / Removal / Storage	11
-------------------------------	----

Questions

Frequently Asked Questions	12
----------------------------	----

Parts Book

Top Shaft Assembly	13
Bearing Assembly	14
Pulley Assembly	15
Back Roller Assembly	16
Cutter Drum Assembly	17
Cutter Drum Assembly Details	18
Bearing Housing Drive Side	19
Bearing Housing Idle Side	20
PTO Shaft Assembly LP2084 - LP2132	21
PTO Shaft Assembly LP-2144 - LP2180	22
Gearbox Assembly	23
General	24
Decal Set	25-26

Thank You

Dear Customer,

We appreciate your purchase of a Vrisimo attachment. The purpose of this manual is to familiarize you with the operation, adjustment, and maintenance of your new attachment. It was meticulously designed and constructed in accordance with the highest industry standards to provide you with years of dependable service. Before endeavoring to operate the machine, you must read this manual thoroughly and comprehend its operation. Vrisimo reserves the right to make modifications to design and specifications, as well as additions and enhancements to its product, without incurring any obligation to retrofit previously manufactured items. If you ever require additional information, please contact your authorized dealer or customer service.



PO Box 220 | 2507 Tully Road | Hughson, CA 95326
1-800-426-5615
www.valleytoolmfg.com

Vrisimo designed this attachment with operator safety as one of its primary considerations. This attachment was designed with shielding, simple adjustments, and other safety features whenever practicable. Ensure that you and your employees read and comprehend this manual. Only responsible individuals who have been trained to operate in a secure manner and who have read and comprehend this manual should operate any machinery.

Before accepting the equipment, verify the pre-delivery checklist thoroughly with the sales representative. See pg.5

Ensure that you have a comprehensive understanding of the operation, adjustment, and safety principles outlines in this manual.

Vrisimo Attachments is solely owned by Valley Tool and Manufacturing.

Visit: www.valleytoolmfg.com

Product Registration



Valley Tool & Mfg. warrants each product to be free of manufacturing defects for a period of twelve months (ninety days for rental units) from the date of delivery to the original user/owner, subject to the limitations stated in this policy.

This warranty does not apply to defects caused in whole or in part by unreasonable use while the product is in the user's possession, including but not limited to: failure to properly set up product; failure to provide reasonable and necessary maintenance; normal wear; routine tune-ups or adjustments; improper handling or accidents; operation at speed or load conditions contrary to published specifications; improper or insufficient lubrication; improper storage. This warranty also does not guarantee that the efficacy of every product will meet the purchaser's expectations.

Valley Tool & Mfg. shall not be liable for consequential damages of any kind, including, but not limited to, consequential labor costs or transportation charges associated with the replacement or repair of defective parts; lost time or expenses incurred as a result of said defects. Valley Tool & Mfg.'s total liability is limited to the purchase price of the product.

Valley Tool & Mfg. provides no warranty for trade accessories or any component or accessory of the product that was not manufactured by Valley Tool & Mfg., including any purchased components. These are subject to the respective manufacturer's warranties. If the product or any part of the product is modified or repaired in any manner not expressly authorized by Valley Tool & Mfg., or if closed components are disassembled prior to return, the warranty will be void. Closed components include gearboxes, hydraulic pumps, motors, cylinders, and actuators, among others.

Our obligation under the warranty is expressly limited, at our option, to the replacement or repair at Valley Tool & Mfg., of Hughson, California, or at a service facility specified by us, of the defective part or parts as determined by inspection.

We are not liable for unauthorized replacements or repairs. Warranty pre-approval is required. Authorized supplies will be sent to the dealer at no cost via UPS Ground. The duration of any implied or statutory warranties, such as warranties of merchantability or fitness for a particular purpose, is expressly limited to the duration of this written warranty. No one is authorized to make any other express or implied warranties on our behalf. This warranty cannot be extended, expanded, or altered unless authorized in writing by Valley Tool & Mfg. No warranty will be processed without a timely, signed "Product Registration"

The attachment owner is responsible for the travel time of mechanics and conveyance of the product to the authorized service dealer for warranty work.

The most reasonable and dealer-friendly return policy on the market is provided by Valley Tool & Mfg. The return policies for each of our brands are listed below. We accept returns within 30 days of the date of original shipment. Prior to return shipment, all returns must be approved by Valley Tool & Mfg, and a return authorization number must be issued. Returns must be in "like-new" condition and accompanied by all original factory packaging, including instruction manuals. If an item is received that is not in "like-new" condition or in its original packaging, additional fees will apply. After our staff has completed a thorough inspection of a return, refunds will be issued less shipping fees and any other potential damage fees. Please allow up to 30 business days for the processing of your account refund credit.

Please direct all return-related questions to sales@valleytoolmfg.com.

Safety

Safety messages are provided in this manual to describe possible risk during operation, maintenance and transportation. These messages are intended to convey known hazards but cannot be construed to describe all possible risks.

Signal words in Safety Messages:

DANGER

Danger: Indicates immediate risk of serious injury or death.

WARNING

Warning: Indicates possibility of serious injury or death.

CAUTION

Caution: Indicates possibility of minor injury.

NOTICE

Notice: Indicates possibility of property damage, possible machine failure but no immediate risk to personal injury.

Failure to heed any of these warnings may result in personal injury or death.

Operational Safety

Before operating this machinery read the owner's manual thoroughly. Properly train all Operators. It is the Owner's responsibility to ensure all Operators are properly trained in the appropriate language. Use OSHA approved eye, ear and head protection to protect the Operator from flying debris and noise. Never use drugs or alcohol before or during operation of this machine. Only operate this machine when it is in good working order on an appropriate power unit that is in good working order, and with all guards and safety devices in place and functioning. Never allow children or other people to ride on this machine.

DANGER

Keep bystanders and children of the clear work area during operation as debris can be discharged and cause serious injury or death. Maintain a minimum distance of 300 ft.

DANGER



300 FT
← →



DANGER

Risk of death or injury if moving parts are touched, or are brought into contact with any person. Keep away from all moving parts. Keep guards in place while operating.

Operate only with clear visibility, never in dusty, foggy conditions or at night. Risk of collision or contact with personnel. Crushing, piercing or cutting hazard.

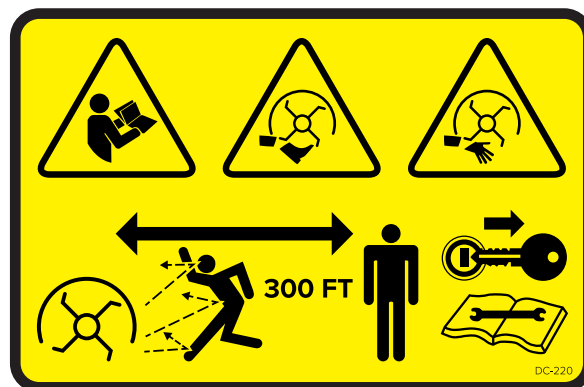

WARNING

Avoid operation that would allow hydraulic lines to be pinched or severed. In the event of a hydraulic leak, hydraulic fluid may have sufficient force to penetrate skin. Do not use any body part to check for leaks. High pressure oil can cause severe injury or death.

Disengage hydraulics, shut off engine and allow all movement to stop before leaving the operator's position to adjust, lubricate, clean or unclog the machine. Do not try to uncouple hydraulic hoses unless the pressure has adequately dissipated.

Risk of serious injury or death due to thrown debris or broken knives. Do not operate closer than 300 ft to people, unprotected roadways or public areas without properly securing or warning protecting against accidental ingress. Risk of fire due to knife contact with stones, concrete, steel or other hard objects. Sparks can ignite dry grass, wood chips or other flammable material. Do not operate in dry grass, severe fire risk areas or in an area actively burning or recently burned. Consult local requirements around operation during Fire Weather Watch or Red Flag Warning conditions.

CAUTION

Rotating parts, Hydraulic hoses, motors and valves generate heat when operating. Do not touch when hot. Allow to cool before maintaining.

Risk of crushing, pinching or cutting due to motion of machine while maintaining. Ensure all energy is dissipated from hydraulic lines before maintaining. Secure power unit and attachment against motion with wheel chocks, or appropriately sized stands as required.

Remove key from power unit and read manual before maintaining. Risk of accidental motion if key is engaged on power unit. Knives wear parts and damaged components can have sharp edges that cause cuts or lacerations. Wear protective gear and handle these parts with care.

CAUTION

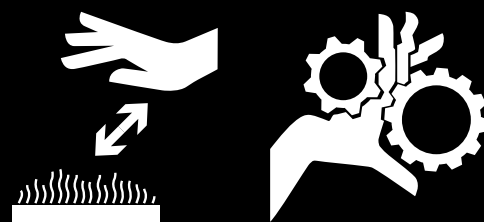

Keep Guards In Place

DC-296

Basic Operation

Attaching to the Power Unit

Pre-Delivery Checklist

- Check all nuts and bolts for correct torque.
- Check for shipping damage. If damaged, do not use the attachment until parts have been replaced or repaired.
- Check that all hydraulic hoses and fittings are tight.
- Check that all warning signs (decals) and safety treads are on the attachment and in their correct location. Replace any damaged signs or safety treads.

The person that is attaching the Vrisimo product should be familiar with the attachment and removal of equipment from a 3-point hitch and be able to do so safely.

Attachment should be performed on flat ground away from obstructions. During attachment keep hands out of pinch points and away from the blades to avoid injury.

The tractor PTO should be disengaged and removed completely before trying to attach Power Unit to the mower, failure to do so could result in damaging the PTO shaft

1. Back the tractor so the lift links arms are in-line with the mower's hitch pins.
2. Shut off engine and disengage PTO. Block tractor wheels before you place yourself between the tractor and the mower.
3. Attach the tractor's left and right lift links to the corresponding hitch pins of the mower. Secure both connections with lynch pins
4. Adjust sway chains or bars so there is a minimum of side slack. Be sure the stabilizers are tight.
5. Attach the tractor's top link to the "A" frame of the mower. Adjust the link out to approximate desired cutting height.

6. Attach PTO Shaft between tractor and mower. Remember, tube end goes to the mower and bar end goes to the tractor.
7. Do not raise the mower while the PTO is engaged, since this will cause the PTO shaft to bind or even break, and may cause injury to the operator.

Starting Procedure

1. Check that the attachment is in the down position and that the blades are not in contact with ground. Start engine and set throttle to idle. Never engage the PTO with the motor above idle speed.
2. With the motor at low RPM engage the PTO output.
3. Slowly bring the throttle up to operating RPM. If the attachment produces excessive noise or vibration, disengage the PTO and shut down the Power Unit immediately. Determine the cause of the problem and correct it before continuing with its operation. Maximum PTO speed is 540 RPM.
4. Attachment is ready for operation.

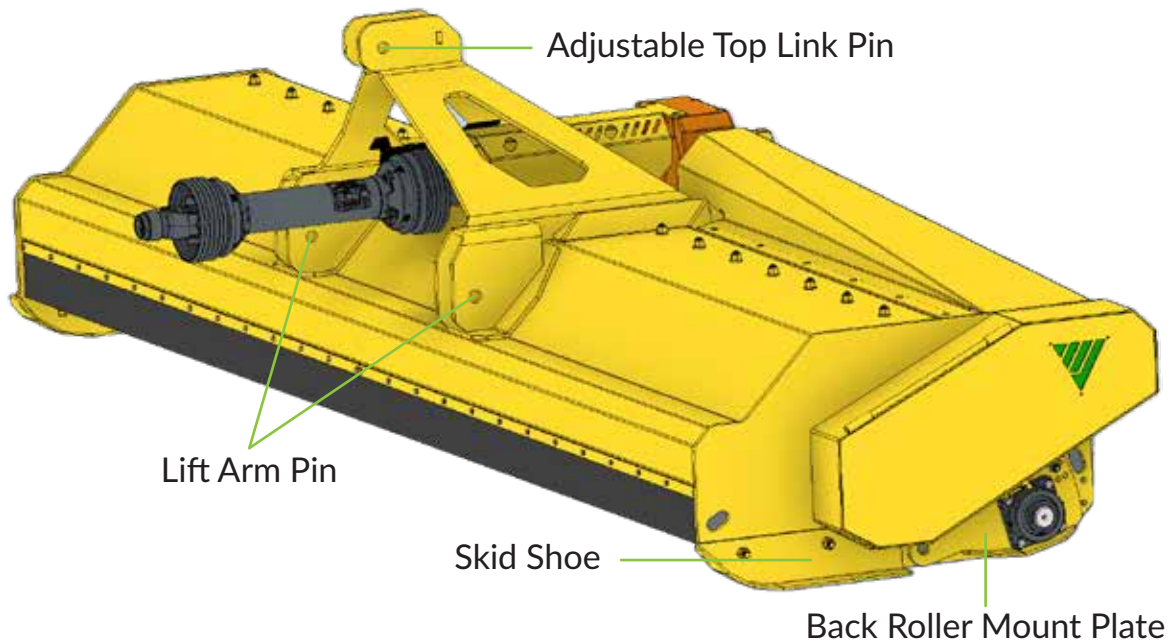

Running Attachment

1. Determine ground speed based on terrain and material being cut. This will typically fall within the 0-5 mph range.
2. Adjust the hitch to the approximate desired cutting height.
3. Position skid shoes between 1/2-3" off the ground; skid shoes are not meant to run on the ground.
4. The mower and skid shoes should be level with the ground, the height of the mower can be adjusted with back gauge roller which runs along the ground and works in conjunction with top link.
5. Make sure PTO shaft is properly attached.
6. With the PTO disengaged, operate lift arms through the entire range of motion. Check for - binding, bottoming, uncoupling, or contact with attachment.

Shut Down Procedure

1. When work is completed, disengage the PTO shaft and position it for storage or transport (See the "Storage and Transport" section for details on proper storage). Shut off Power Unit and set parking brake, wait for the attachment to stop rotating.
2. Visually inspect the PTO shaft, all the bearings and gearbox for excessive heat or leaks.

Adjustments & Maintenance

Note: Before performing maintenance, ensure all motion has stopped and that the Power Unit is powered down with ignition key removed. Before working on or underneath the mower, place blocks on both sides of the Power Units' tires and underneath both end of the mower to prevent accidental lowering of the machine.

Cut Height Adjustments

1. The cutting height of the mower can be adjusted by shortening and lengthening the adjustable top link.
2. The entire weight of the mower should be on the back gauge roller. The skid shoes should be adjusted so there is 1/2"-3" clearance between them and the ground. The shoes are for added protection against tree roots, ridges or borders and not designed to slide on the ground. Adjust the back gauge roller by removing the bolts from both back roller mount plates, setting to the correct height, and reinstalling bolts.

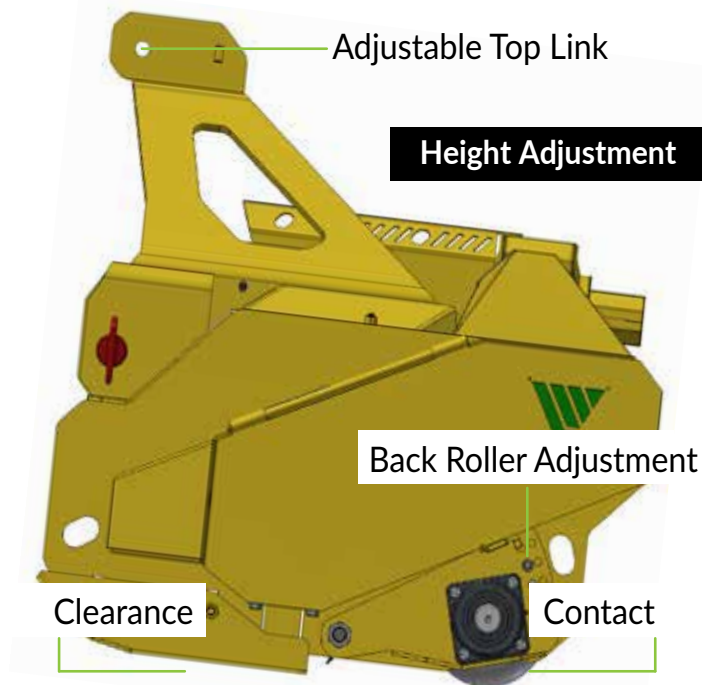

Wear Components

Wear components such as knives, belts and bearings may wear at different rates. Each should be inspected for wear independently.

Belt Tension

Belt adjustment is done by tightening the Tension Bolt which pushes the top pulley into the belts.

Tighten the drive belts so there is 1/4" to 3/8" give with 6 pounds of force. See FAQ.

Note: Adjust tension on new machines, after 1-2 hours of operation.

1. Loosen Bearing Bolts just enough to allow the assembly to move.

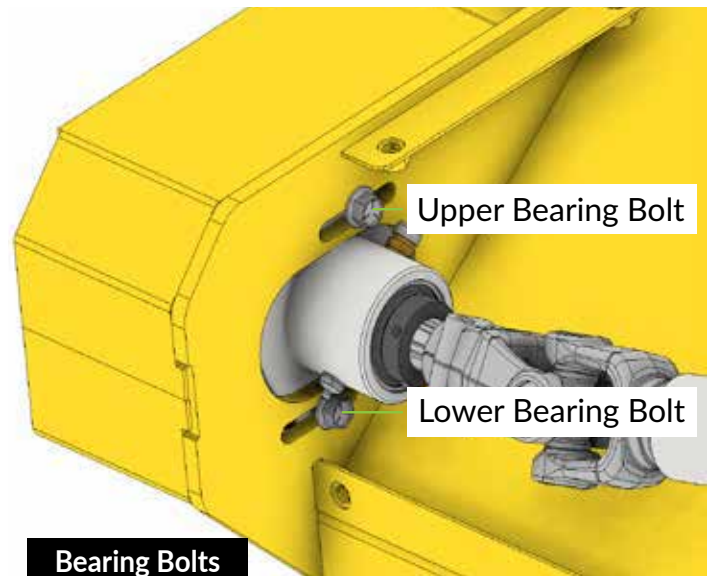

2. Loosen Locking Nut just enough to allow Tension Bolt to turn.
3. Tighten the Tension Bolt to increase tension. Loosen the Tension Bolt to decrease tension.
4. Tighten Locking Nut once desired tension is reached.
5. Tighten Bearing Bolts.

Adjustments & Maintenance

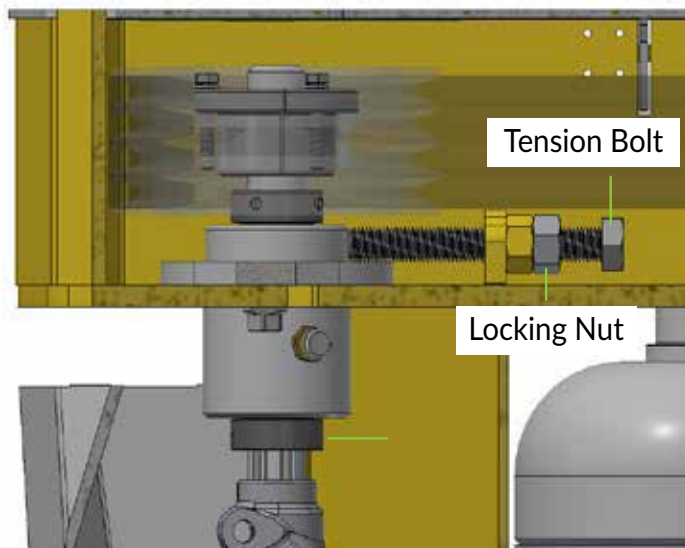

Belt Tension Adjustment

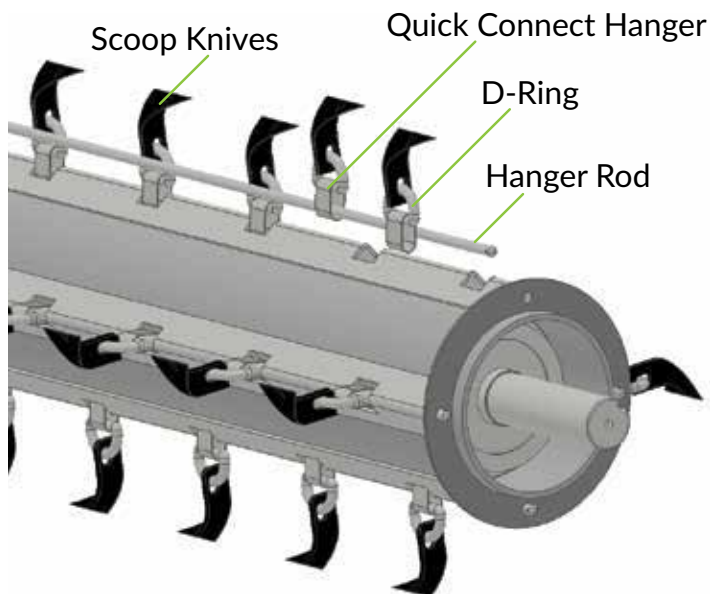

Cutter Drum / Knives

CAUTION

Adjusting Tension Bolt
Without Loosening Bearing
Bolts Will Result In Damage.

Knives

1. When individual knives, bolts or spacer become worn or damaged they must be replaced with hardware saved from previous knife replacement. Replacing an individual station with new hardware could cause the cutter drum to run out of balance. When replacing hardware at all the stations, some old hardware should be saved to replace future broken hardware.
2. Replacing the complete knife assembly is done by removing the hanger rod. Re-insert hanging rod inserting a new knife assembly at each station.
3. To replace the knife only, rotate the 7/16" D-Ring until slot is exposed. Disconnect from quick connect changer. Replace the knife and reconnect knife to D-Ring then proceed to connect D-Ring back to quick connect changer repeat this process until completed.

Cleaning the Mower

1. Check for excessive grease in bearing areas on the pulley side of the mower. Make sure grease is not allowed into the belt areas.
2. Clean any clippings from the gearbox areas, pulley areas and anywhere else that is prone to excessive heat where fire can start.
3. Clean the inside of the mower with a pressure washer make sure the inside of the mower is kept free from mud and compact grass. Mud built up on the cutter drum can cause imbalance.
4. Preserve damaged decals or replace them if they are unreadable. Decal kits can be obtained from your local Vrisimo dealer.

Adjustments & Maintenance

Lubrication

Cutter Drum

1. There are two Grease zerk fittings to lubricate per bearing housing. There is an outer and inner zerk on each side of the mower.
2. Valley Tool recommends greasing with **NLGI 2 ISO VG100**. Any lithium based NLGI 2 grease that is ISO 100 VG and of high quality will work. **DO NOT** use grease designed for tractor pins and bushings.
3. The CD-3001 is factory assembled with grease for over 300 hours of operation, and only requires 6 pumps of grease every 300 hours of operation. Use of pneumatic grease guns is not recommended as it is difficult to control the amount of grease being applied. While it is not necessary to “run-in” the bearing with each grease has been applied the risk of failure can be mitigated by allowing the bearing another “run-in” period.

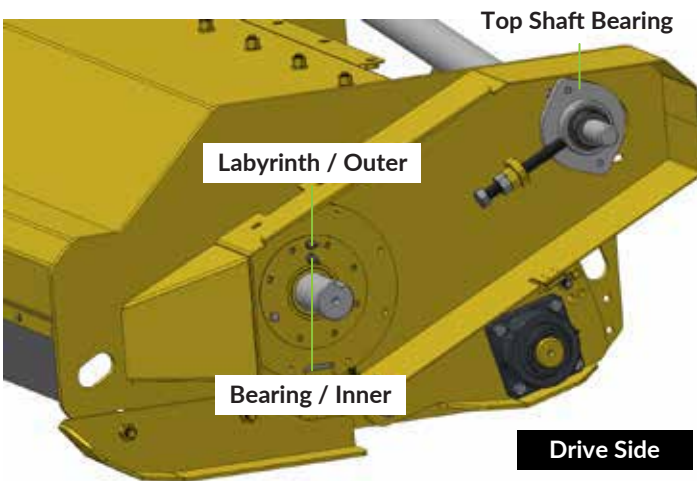

Maintenance Table

LUBRICATION	FLUID	HRS
Top Shaft Bearings	NLGI 1.5 ISO VG460	10
Backroll Bearings	NLGI 1.5 ISO VG460	10
Driveshaft Yokes	NLGI 1.5 ISO VG460	10
Driveshaft Slides	NLGI 1.5 ISO VG460	10
Cutter Drum Labyrinth	NLGI 2 ISO VG100	10
Cutter Drum Bearing	NLGI 2 ISO VG100	300
Gearbox	SAE 80W-90	300

Back Roller

1. The back roller uses a four bolt flange style bearing. There is one on either side of the back roller. Grease daily as the back roller is exposed to the most debris.
2. The back roller bearing uses **NLGI 1.5 ISO VG460** grease and should be greased after each time used. Depending on conditions back roller bearings may require more or less grease.

Top Shaft

1. All top shaft bearings and yokes need to be greased weekly with **NLGI 1.5 ISO VG460**.

PTO

1. Grease daily as the PTO shaft can not be over greased. PTO shaft and tractor can be damaged if run dry. PTO shaft will bind up and not telescope in and out properly.
2. The PTO shaft should be greased with any standard grease as long as it is **NLGI 1.5 ISO VG460**.

Gearbox

1. Check gearbox oil level periodically and refill as required. Replace gearbox oil every 300 hours.
2. Use quality **SAE 80W-90** gear oil. Be sure gearbox is in level position and remove side plug to fill. See FAQ for detail.

Maintenance Locations

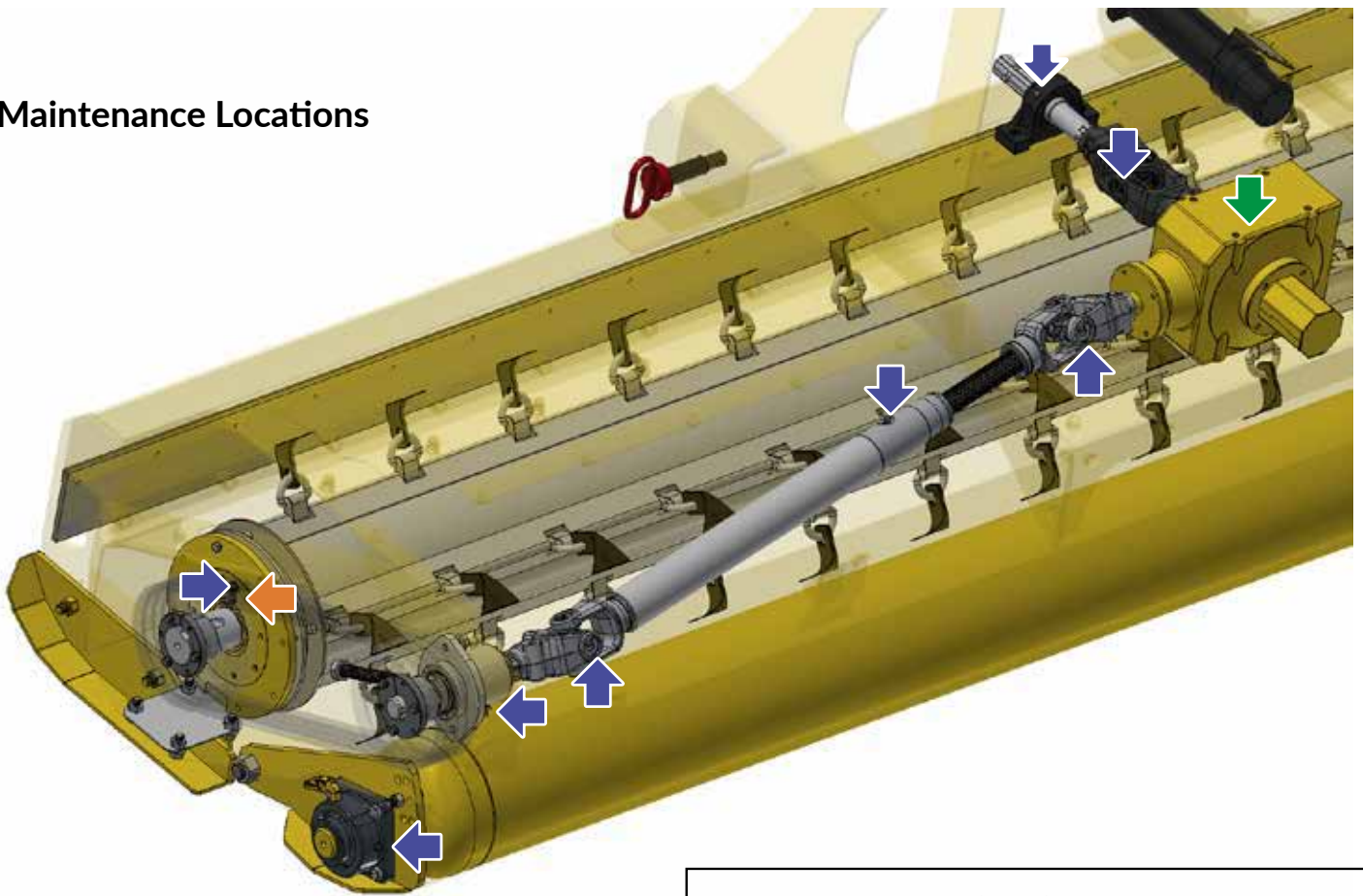

We understand that you have a lot of options when it comes to choosing your grease.

Any Selection from the **Blue Group** of greases are equivalent, and any selection from the **Orange Group** of greases are equivalent.

Grease Comparison

NAME	NLGI GRADE	KINEMATIC VISCOSITY cSt	
		TEMP DEG C	TEMP DEG C
		40	100
SCHAEFFER 228	2	555	36.5
PH66 MULTIPLEX FS460	1.5	460	48.3
MOBILITH SHC460	2	460	55.6
SHELL GADUS S3 V460D 2	2	460	61
MYSTIK JT-6 SYNTHETIC 460	2	460	59.1
MYSTIK JT-6 MULTIPURPOSE	2	460	59.1
PH66 MULTIPLEX 460	2	415	26.8
CHEVRON DELO EP2	2	226	20.7
PH66 DYNALIFE 220	2	220	18
SCHAEFFER 219	2	142	14.6
PH66 MULTIPLEX 150	2	144	10.8
MYSTIK JT-6 SYNTHETIC 100	2	100	16.3
MOBILITH SHC100	1.5	100	16.3
SHELL GADUS S2 V100 2	2	100	14
LUBRIPLATE EMB-3	2	100	14

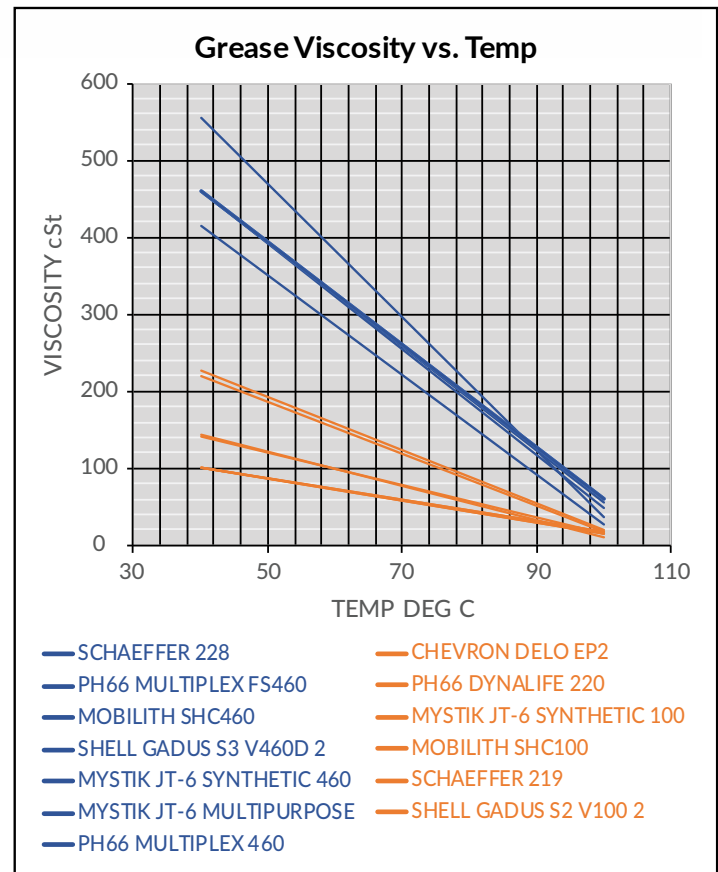

Transport, Removal, and Storage

Transport, Removal, and Storage

Disengage PTO and shut off engine allowing all movement to stop before leaving the operators position to adjust, lubricate, clean or unclog the machine.

Before working on or underneath the mower, place wheel chocks on both side (front and rear) of Power Unit tires and under each end of the mower to prevent accidental lowering of the machine.

Also remove the ignition key from the POver Unit and allow all movement to stop before beginning work.

Transport on Powet Unit

PTO must be disengaged, unit lifted off the ground.



Transport On Power Unit

Transport on Trailer

Use cahin down locations even if unit is still attached to tactor, secure PTO shaft into the PTO rack.



Transport On Trailer

Removal

- Place attachment on ground with entire weight resting on mower.
- Remove the adjustable top link from the tractor and mower.
- Disconnect the drive shaft from the tractor and mower.
- Remove the safety pins from the lower three point arm pin location and disconnect the arms.

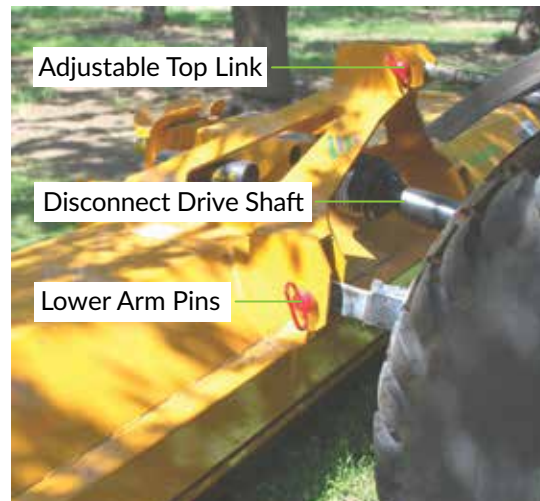

Removal

Storage

- Place mower in a clean, level, dry place.
- Put the drive shaft away in a clean, dry place.
- Clean the mower thoroughly (See "Cleaning the Mower" section for details).
- Relax belt tension (See "Adjustments & Maintenance" section for details).
- Lubricate the mower as recommended (See "Lubrication" section for details).
- Check oil level in gearbox and fill as required (See "Lubrication" section for details).
- Check for worn parts and replace so mower is ready to mow when necessary. (See "Adjustments & Maintenance" section).

Frequently Asked Questions

Q. When should gear oil be replaced. How much should be added?

A. When replacing gear oil, fill from the Upper Fitting. When oil level reaches Lower Middle Fitting, the box is full.

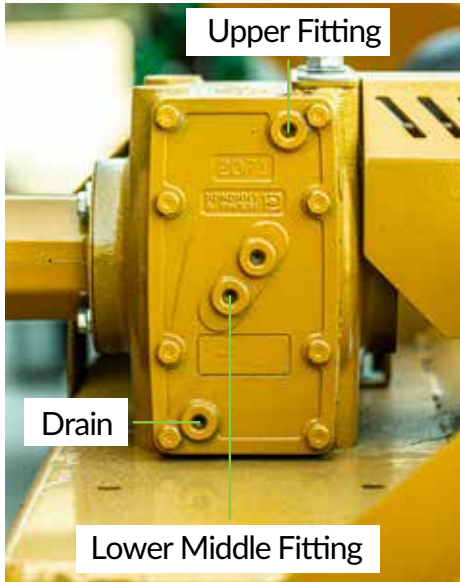

Q. Are there any advantages to reversing cutter drum rotation?

A. Whether reversing cutter is advantageous depends on the application. In most, normal rotation is a reverse rotation. This means that the cutter drum rotates in a fashion that would throw grass or clippings towards the tractor. The advantage to reversing rotation would be in industrial applications such as along freeways, in places with large amounts of debris (i.e. plastic, metal, rocks), or using no advantages in the grade of cut it will be.

Q. How to do reverse cutter drum rotation?

A. To reverse cutter drum rotation, un-mount the gearbox from its default position, remove the safety cover from the other shaft of the gearbox and rotate the gearbox so that the previously covered shaft is the one that will be driven by the PTO. Install the safety covers.

Note: Scoop knives must be rotated to accommodate for a reversed cutter drum rotation.

Q. How to replace knives?

A. See the "Adjustments & Maintenance" section for detailed information.

Q. When connecting the PTO shaft, can it go on either way or should a specific side go to the mower/shredder and the other to the Power Unit?

A. The PTO shafts are side specific. The tube half of the PTO shaft goes to the mower and the bar half of the PTO shaft goes to the Power Unit.

Q. How to test belts for 2/4" to 3/8" give with 6 pounds of force?

A. Use the diagram below to show where to apply force and measure give.

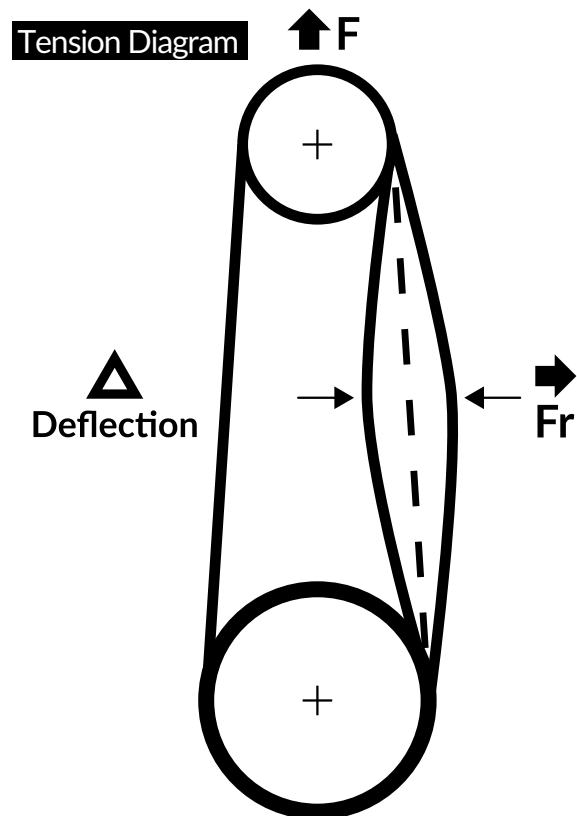

	NEW	USED
F =	788 - 844 lbf.	675 - 731 lbf.
Δ =	$\frac{3}{8}$ Deflection	$\frac{3}{8}$ Deflection
Fr =	6.3 - 6.7 lbf.	5.4 - 5.8 lbf.

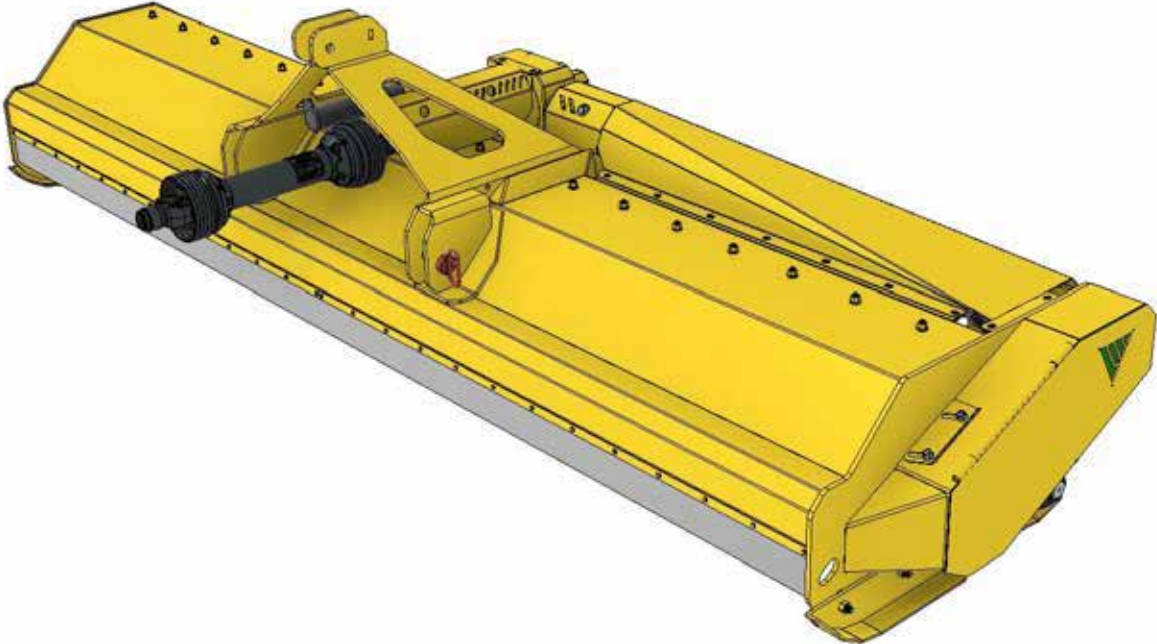

Parts: Top Shaft Assembly

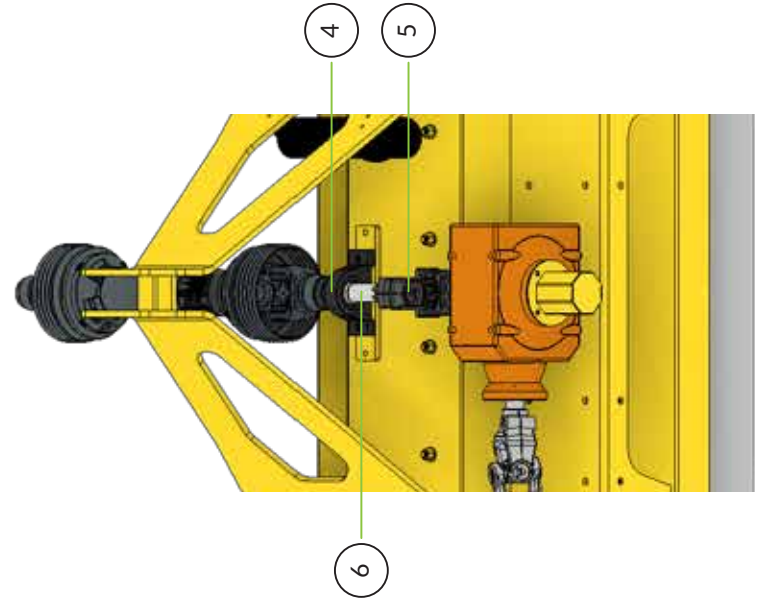
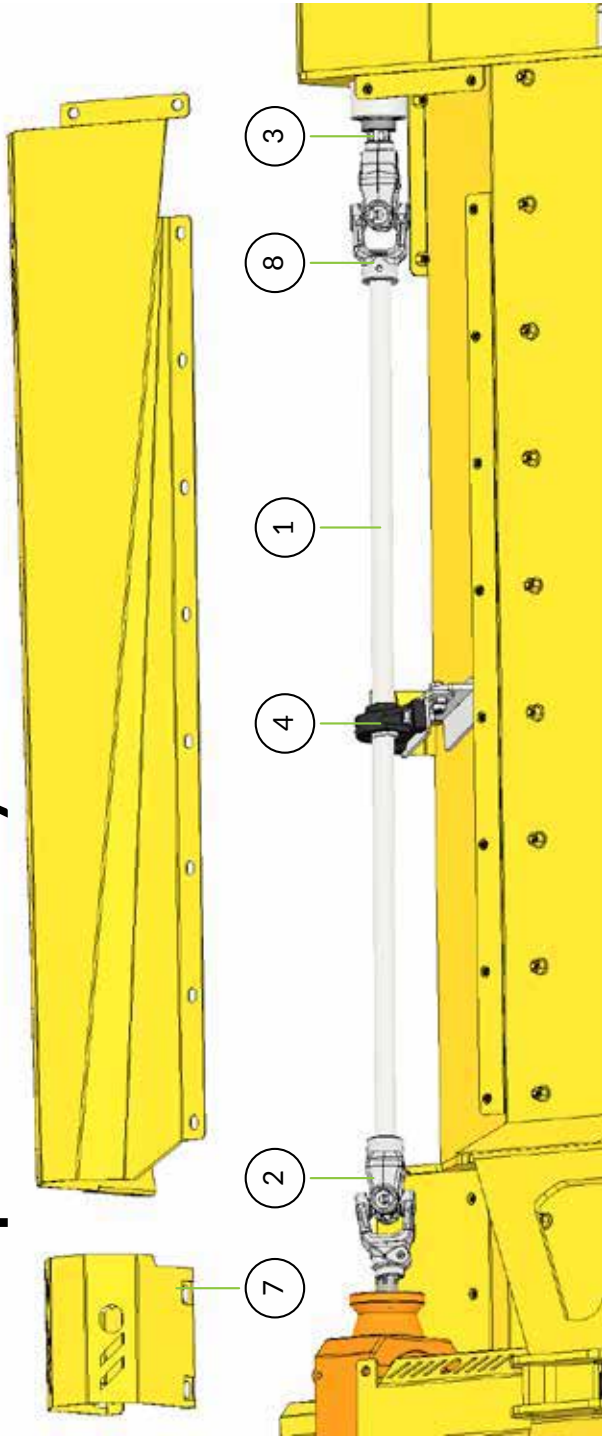

DESCRIPTION	MODEL	QTY	P/N
1 LP2084 Top Shaft	LP2084	1	11664
1 LP2096 Top Shaft	LP2096	1	08846
1 LP2108 Top Shaft	LP2108	1	08966
1 LP2120 Top Shaft	LP2120	1	08964
1 LP2132 Top Shaft	LP2132	1	08965
1 LP2144 Top Shaft	LP2144	1	08845
1 LP2156 Top Shaft	LP2156	1	08967
1 LP2168 Top Shaft	LP2168	1	08844
1 LP2180 Top Shaft	LP2180	1	08445
2 U-Joint Assembly - 6Spl x Sm	ALL	2	TS-1085
3 Top Shaft Extension	ALL	1	08931
4 Bearing 1-3/8" Pillow Block	ALL	1	TS-1300
5 6 SPL x 6SPL Universal Assembly	ALL	1	DS-2227
6 Double Spline Shaft	ALL	1	DS-2226
7 Top Shaft Gearbox Joint Guard	ALL	1	07292
8 U-Joint Assembly - Sm x Sm	ALL	1	TS-1084

Parts: Bearing Assembly

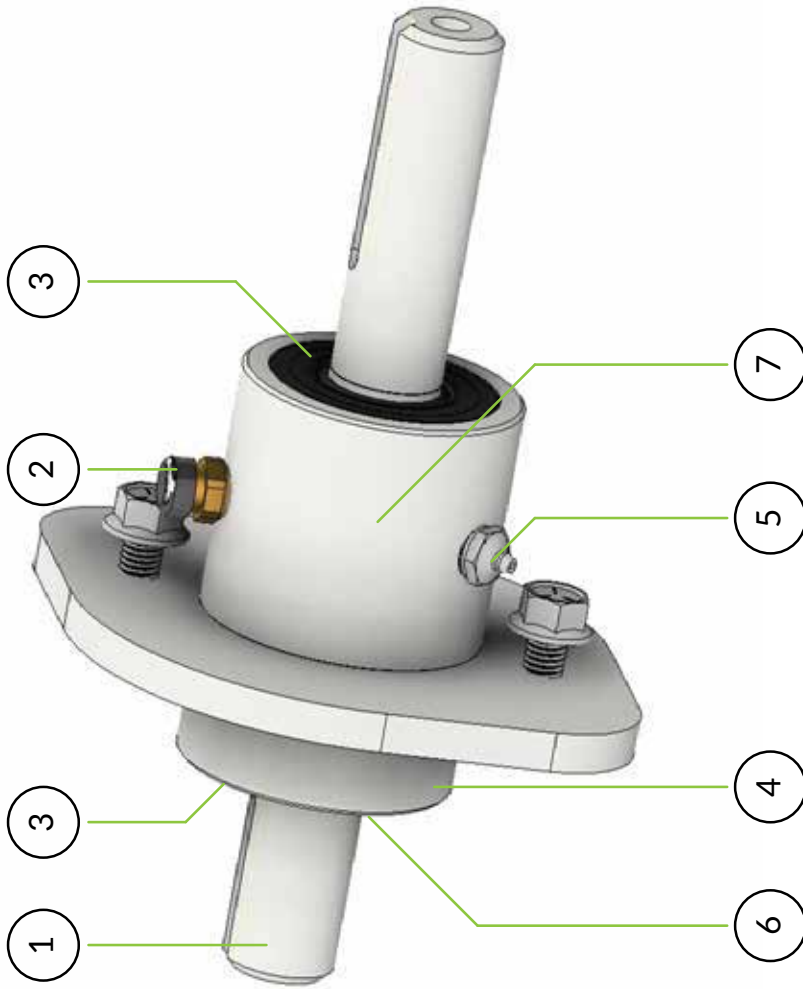

DESCRIPTION	MODEL	QTY	P/N
1 TOP SHAFT TENSION ADJ ADAPTER	ALL	1	05218
2 BREATHER - SPINDLE HOUSING	ALL	1	BP-2731
3 SEAL 35MM DOUBLE LIP	ALL	2	35X72X7 HMSA10 V
4 BEARING BODY TRB LP TOP SHAFT	ALL	1	08932
5 ZERK GREASE FTG 3/8" NPT STRAIGHT	ALL	1	1095K54
6 RETAINING RING 72MM	ALL	1	WH-284
7 BEARING TRB 35MM	ALL	2	TP-208

Parts: Pulley Assembly

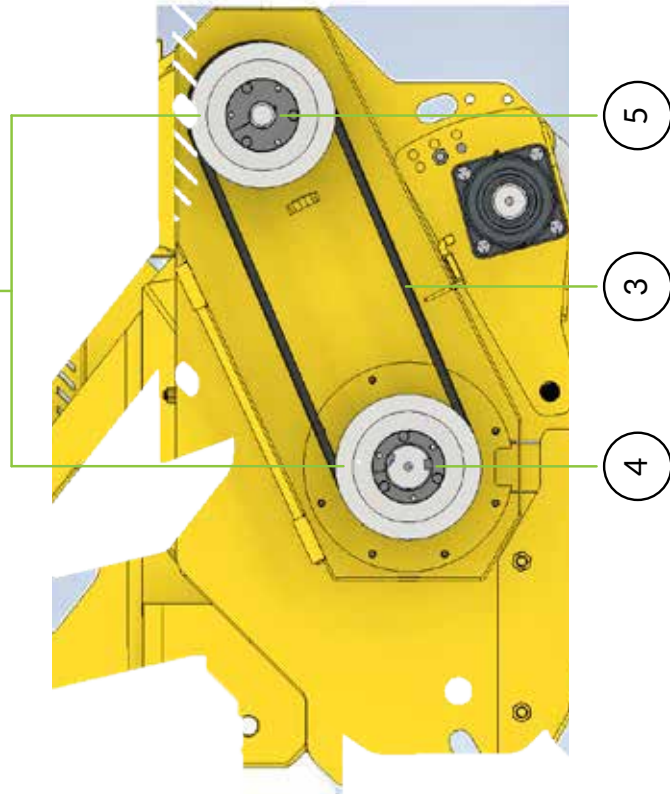
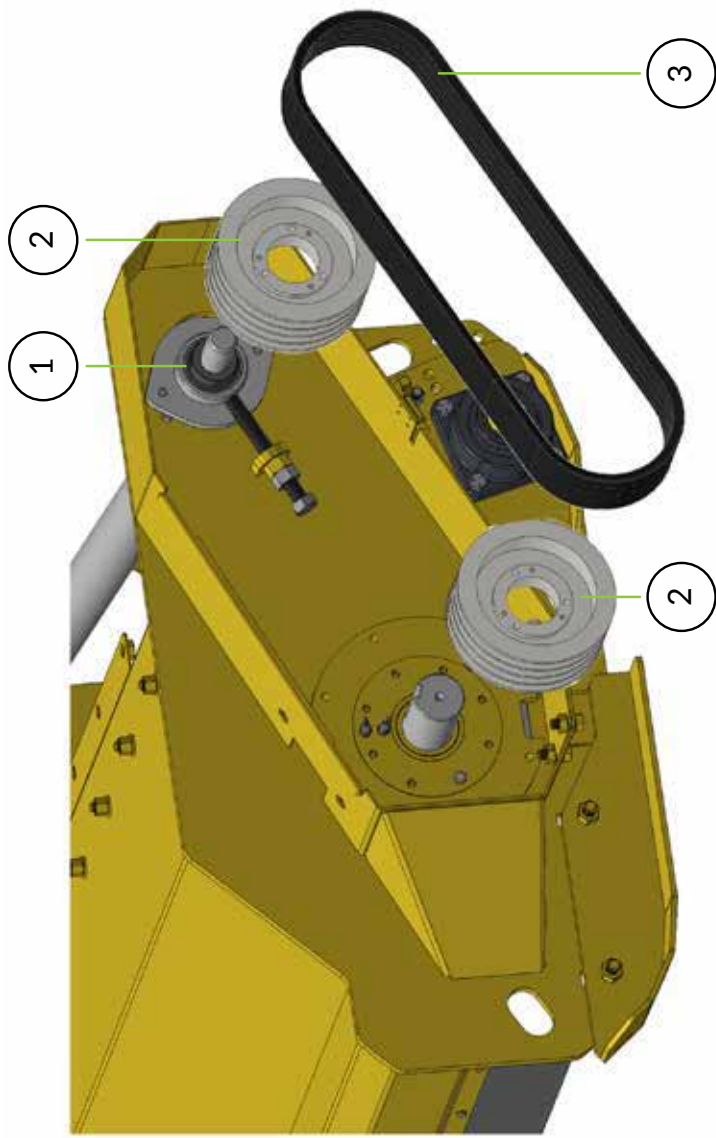

DESCRIPTION	MODEL	QTY	P/N
1 Top Shaft Assembly 1 3/8" Tensioner	ALL	1	08931
2 Pulley 7.4" OD 4B	ALL	2	P-1461
3 Belt 4-Band 4-B62	ALL	1	B-1722
4 Retaining Bushing - Lower 2 7/16" 4G	ALL	1	TL-1540
5 Retainer Bushing - Top 1 3/8"	ALL	1	TL-1550

Parts: Back Roller Assembly

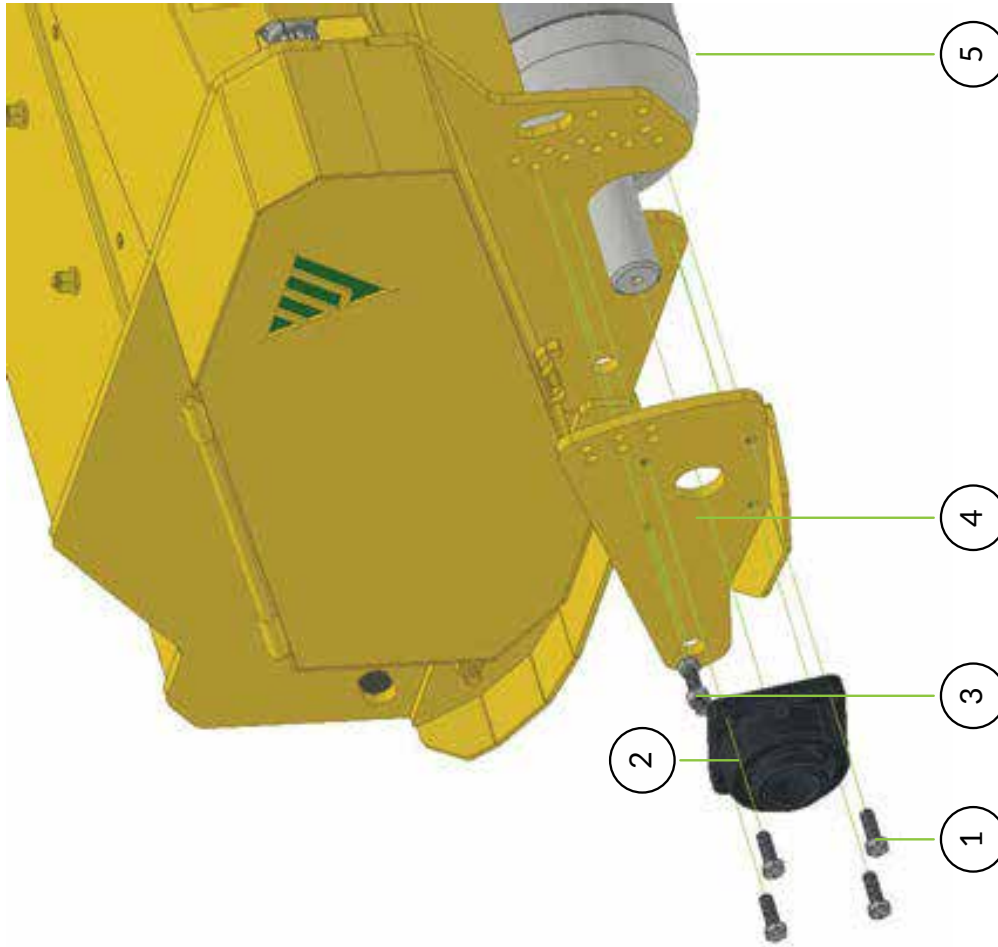

	DESCRIPTION	MODEL	QTY	P/N
1	1/2" -13 UNC 1 1/2" Bolt	ALL	4	
2	Back Roller Bearing	ALL	2	BR-2404
3	1/2" -13 UNC Locknut	ALL	4	
4	Back Roller Mount - Left Side	ALL	1	06197
4	Back Roller Mount - Right Side	ALL	1	06198
5	Back Roller Mount - Right Side	ALL	1	06198
	LP2120 - Back Roller	LP2120	1	07308
	LP2084 - Back Roller	LP2084	1	11657
	LP2096 - Back Roller	LP2096	1	08063
	LP2108 - Back Roller	LP2108	1	07755
	LP2132 - Back Roller	LP2132	1	07758
	LP2144 - Back Roller	LP2144	1	07302
	LP2156 - Back Roller	LP2156	1	07300
	LP2168 - Back Roller	LP2168	1	07304
	LP2180 - Back Roller	LP2180	1	07306

Parts: Cutter Drum Assembly

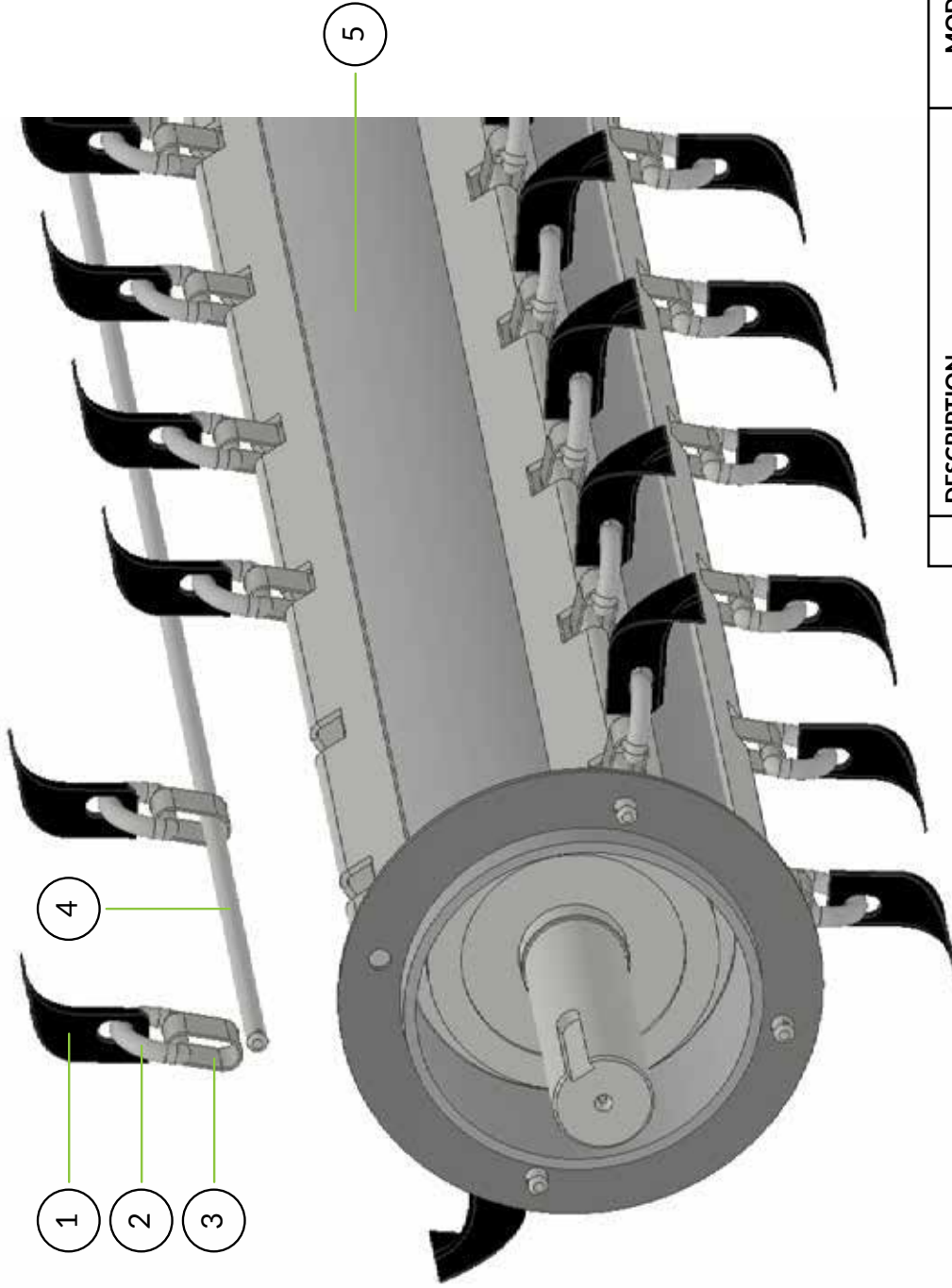

	DESCRIPTION	MODEL	
1	Standard Scoop Knife	ALL	See Below
2	7/16" D-Ring	ALL	See Below
3	Quick Connect Changer	ALL	See Below
4	Hanger Rod	ALL	4
5	Assembly - Cutter Drum	ALL	1 See Below
	Wire Guard (Not Shown)	ALL	2 CD-3005

Parts: Cutter Drum Assembly Details

LP2084

DESCRIPTION	QTY	P/N
Assembly - Cutter Drum	1	CD-2467
Standard Scoop Knife	40	CD-2110
Industrial Knife	80	CD-2100
7/16" D-Ring	40	CD-2135
Quick Connect Changer	40	CD-2125
Hanger Rod	4	CD-1920

LP2096

DESCRIPTION	QTY	P/N
Assembly - Cutter Drum	1	CD-2734
Standard Scoop Knife	44	CD-2110
Industrial Knife	88	CD-2100
7/16" D-Ring	44	CD-2135
Quick Connect Changer	44	CD-2125
Hanger Rod	4	CD-1930

LP2108

DESCRIPTION	QTY	P/N
Assembly - Cutter Drum	1	CD-2735
Standard Scoop Knife	48	CD-2110
Industrial Knife	96	CD-2100
7/16" D-Ring	48	CD-2135
Quick Connect Changer	48	CD-2125
Hanger Rod	4	CD-1940

LP2120

DESCRIPTION	QTY	P/N
Assembly - Cutter Drum	1	CD-2677
Standard Scoop Knife	56	CD-2110
Industrial Knife	112	CD-2100
7/16" D-Ring	56	CD-2135
Quick Connect Changer	56	CD-2125
Hanger Rod	4	CD-1950

LP2132

DESCRIPTION	QTY	P/N
Assembly - Cutter Drum	1	CD-2685
Standard Scoop Knife	60	CD-2110
Industrial Knife	120	CD-2100
7/16" D-Ring	60	CD-2135
Quick Connect Changer	60	CD-2125
Hanger Rod	4	CD-1960

LP2144

DESCRIPTION	QTY	P/N
Assembly - Cutter Drum	1	CD-2710
Standard Scoop Knife	68	CD-2110
Industrial Knife	136	CD-2100
7/16" D-Ring	68	CD-2135
Quick Connect Changer	68	CD-2125
Hanger Rod	4	CD-1970

LP2156

DESCRIPTION	QTY	P/N
Assembly - Cutter Drum	1	CD-2717
Standard Scoop Knife	76	CD-2110
Industrial Knife	152	CD-2100
7/16" D-Ring	76	CD-2135
Quick Connect Changer	76	CD-2125
Hanger Rod	4	CD-1971

LP2168

DESCRIPTION	QTY	P/N
Assembly - Cutter Drum	1	CD-2724
Standard Scoop Knife	84	CD-2110
Industrial Knife	168	CD-2100
7/16" D-Ring	84	CD-2135
Quick Connect Changer	84	CD-2125
Hanger Rod	4	CD-1975

LP2180

DESCRIPTION	QTY	P/N
Assembly - Cutter Drum	1	CD-2732
Standard Scoop Knife	92	CD-2110
Industrial Knife	184	CD-2100
7/16" D-Ring	92	CD-2135
Quick Connect Changer	92	CD-2125
Hanger Rod	4	CD-1980

Parts: Bearing Housing Drive Side



	DESCRIPTION	MODEL	QTY	P/N
1	Assembly Bearing Housing Drive Side Complete Kit	ALL	1	CD-3002
2	Wire Guard	ALL	1	CD-3005
3	Shaft Seal	ALL	1	SS-1000
4	2 7/16" Spherical Bearing	ALL	1	CD-3100
5	4 3/4" Internal Retaining Ring	ALL	1	SR-1200
6	Grease Zerk	ALL	2	HY-2440
7	Housing Cover - Drive	ALL	1	CD-3004
8	Shaft Seal	ALL	1	CD-3006

Parts: Bearing Housing Idle Side

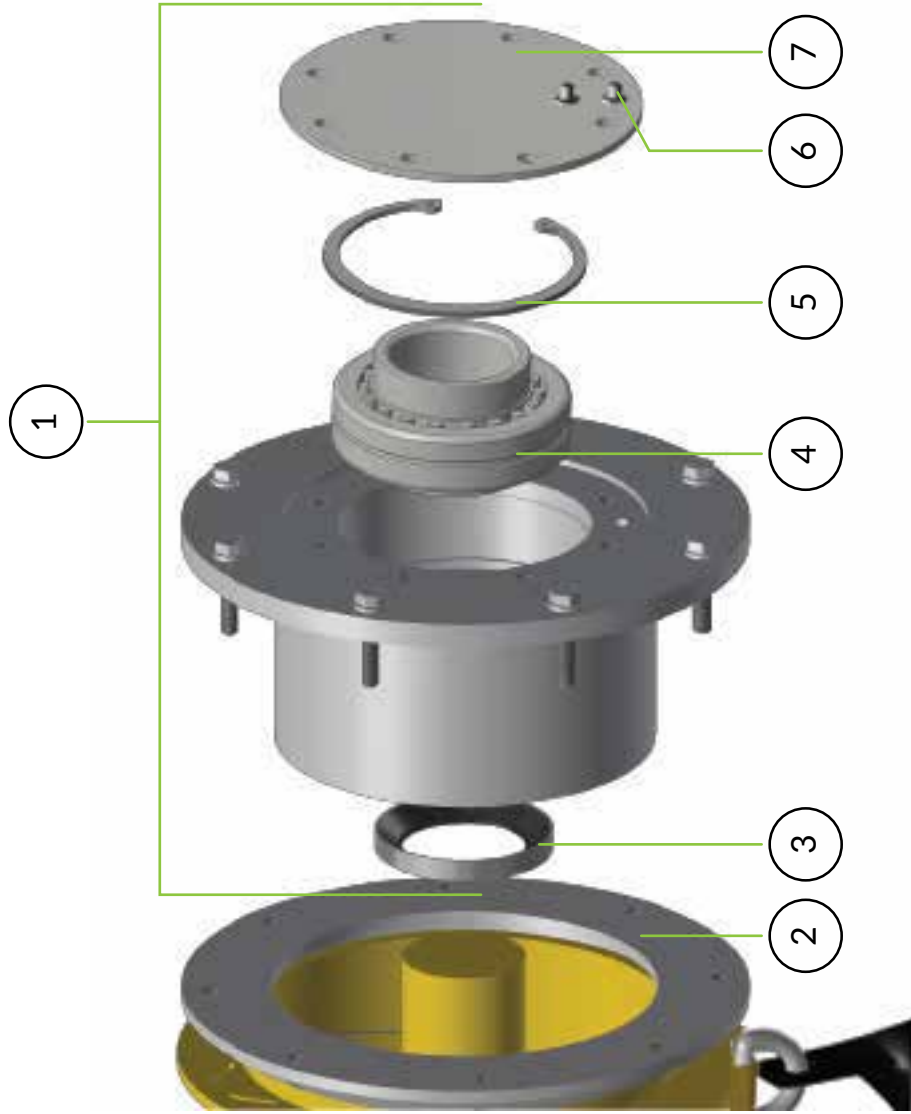

	DESCRIPTION	MODEL	QTY	P/N
1	Assembly Bearing Housing Idle Side Complete Kit	ALL	1	CD-3002
2	Wire Guard	ALL	1	CD-3005
3	Shaft Seal	ALL	1	SS-1000
4	2 7/16" Spherical Bearing	ALL	1	CD-3100
5	4 3/4" Internal Retaining Ring	ALL	1	SR-1200
6	Grease Zerk	ALL	2	HY-2440
7	Housing Cover - Drive	ALL	1	CD-3004

Parts: PTO Shaft Assembly LP2084 - LP2132

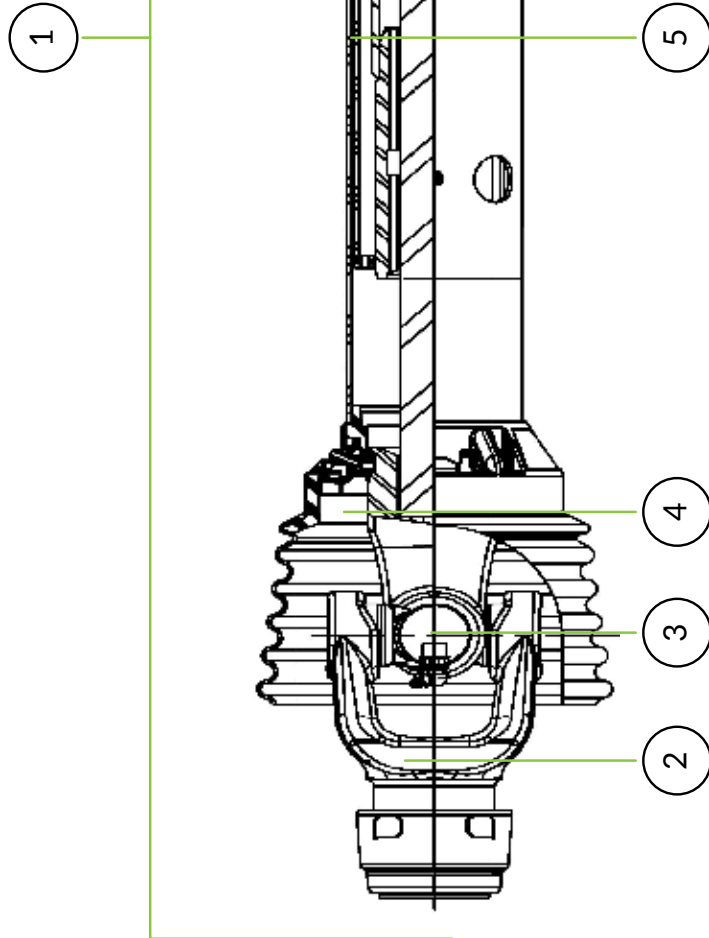

DESCRIPTION	MODEL	QTY	P/N
1 PTO Assembly Complete	LP2084-LP2132	1	DS-2200
2 1 3/8" 6-Spline Yoke	LP2084-LP2132	2	DS-2220B
3 Cross Kit	LP2084-LP2132	2	DS-2230
4 Shield Retainer Kit	LP2084-LP2132	2	DS-193A2
5 Black Plastic Shield Complete	LP2084-LP2132	2	DS-193A1

Parts: PTO Shaft Assembly - LP2144 - LP2180

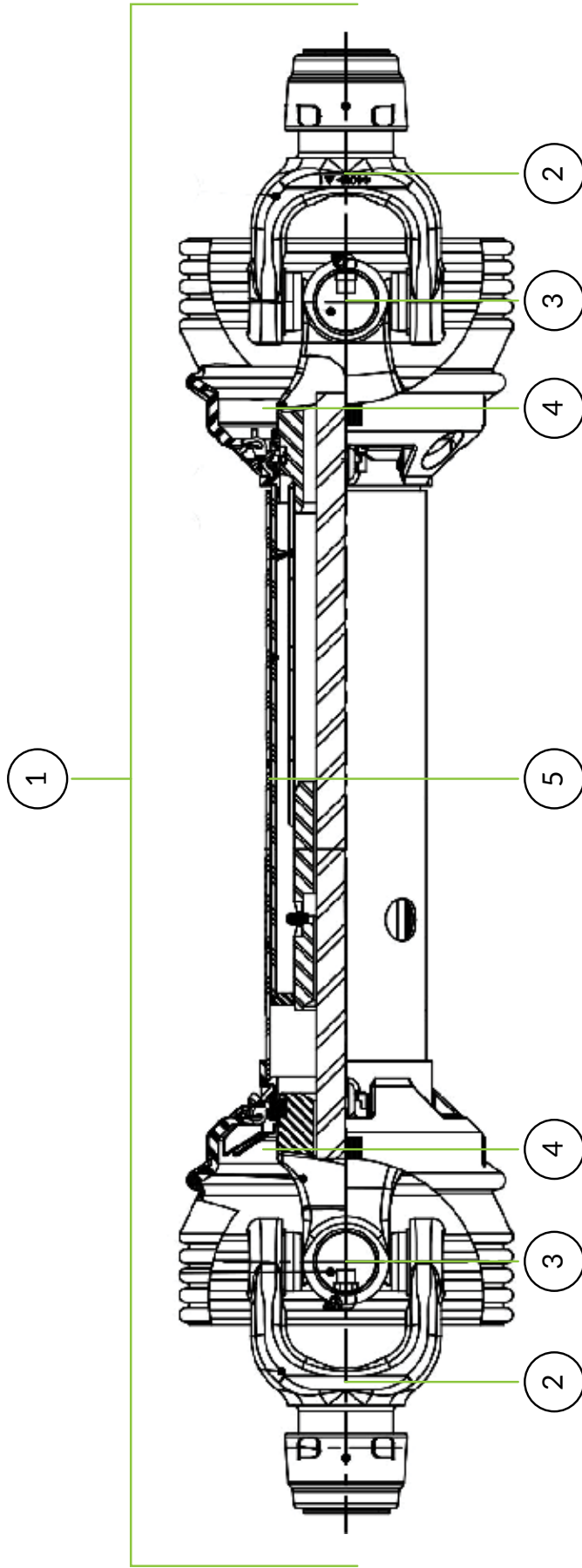

DESCRIPTION	MODEL	QTY	P/N
1 PTO Assembly Complete	LP2144-LP2180	1	DS-2600
2 1 3/8" 6-Spline Yoke	LP2144-LP2180	2	DS-2625
3 Cross Kit	LP2144-LP2180	2	DS-2626
4 Shield Retainer Kit	LP2144-LP2180	2	DS-2652
5 Black Plastic Shield Complete	LP2144-LP2180	2	DS-2650

Parts: Gearbox Assembly

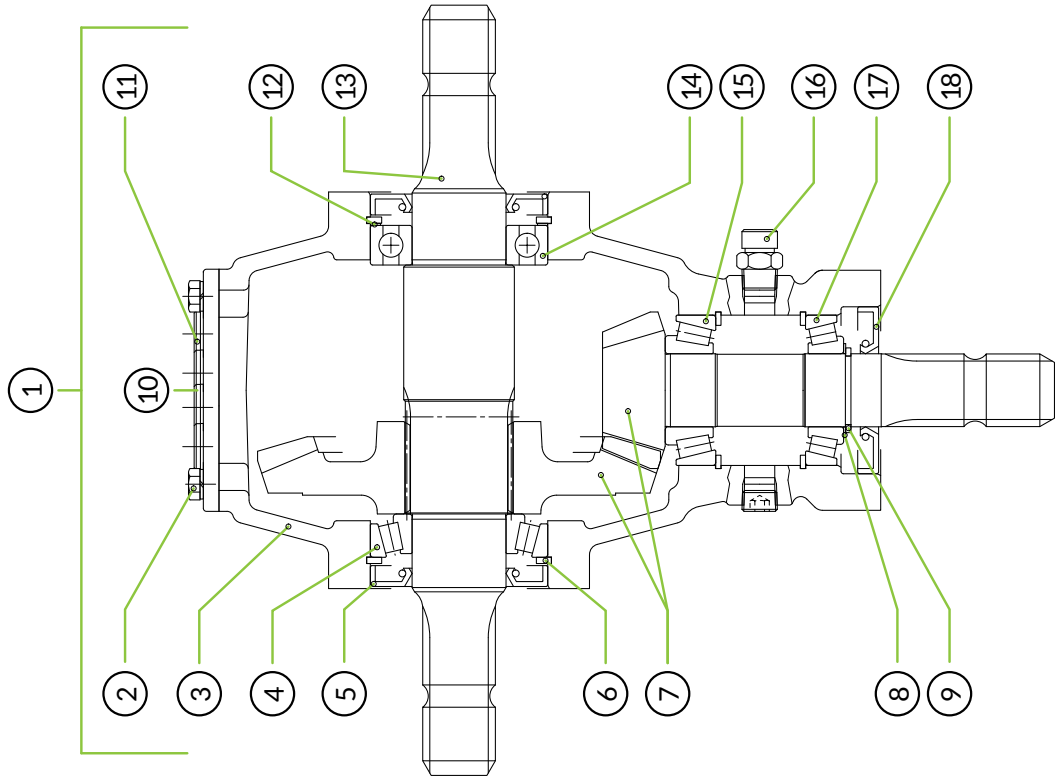

	DESCRIPTION	MODEL	QTY	P/N
1	Gear Box Assembly Complete	ALL	1	BP-2700
2	Screw Hex Head	ALL	8	BP-2705
3	Main Housing	ALL	1	BP-2701
4	Tapered Bearing Assembly	ALL	1	BP-2721
5	Oil Seal, Input	ALL	2	BP-2724
6	Snap Ring, Input	ALL	1	BP-2708
7	Ring & Pinion Gear Set	ALL	1	BP-2727
8	Shim Kit, Output	ALL	1	BP-2740
9	Snap Ring, Output	ALL	1	BP-2706
10	Rear Oil Plug	ALL	4	BP-2726
11	Rear Cover Plate	ALL	1	BP-2702
12	Shim Kit, Input	ALL	1	BP-2745
13	Input Shaft	ALL	1	BP-2703
14	Ball Bearing	ALL	1	BP-2720
15	Tapered Bearing Assembly	ALL	1	BP-2723
16	Air Breather	ALL	1	BP-2730
17	Tapered Bearing Assembly	ALL	1	BP-2722
18	Oil Seal, Output Shaft	ALL	1	BP-2725

Parts: General



1

2

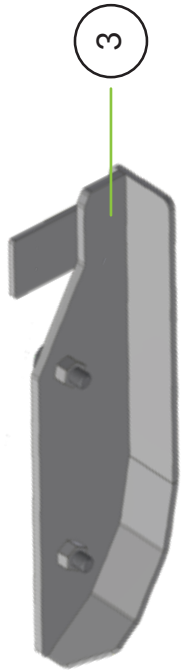

3



4

5

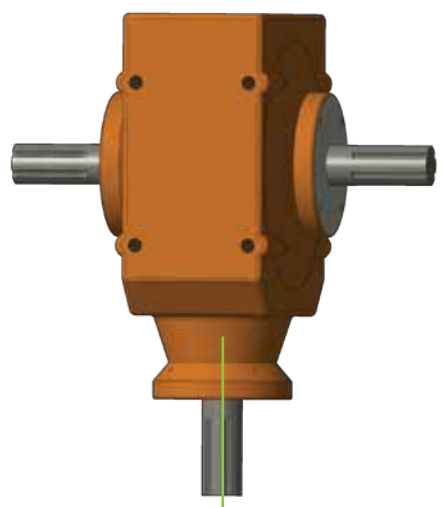

8

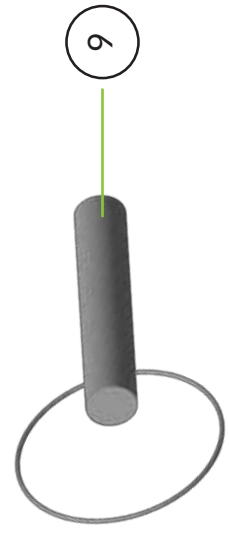

9



6



7

	DESCRIPTION	MODEL	QTY	P/N
1	Skid Shoe - Left	ALL	1	05549
2	Gear Box	ALL	1	BP-2700
3	Skid Shoe - Right	ALL	1	05548
4	PTO Shaft Holder	ALL	1	GP-2503
5	Documnet Holder	ALL	2	DH-100
6	Rubber Guard	ALL	1	RB-1700
7	Backing Strip	ALL	1	RB-1701
8	Category-2 Pin	ALL	2	TP-2810
9	Lynch Pin	ALL	2	P-791

Parts: Decal Set



DC-101



DC-112



DC-296

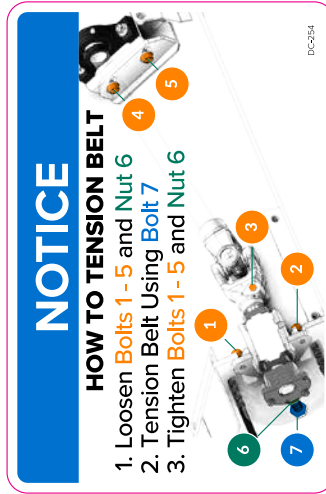

DC-354

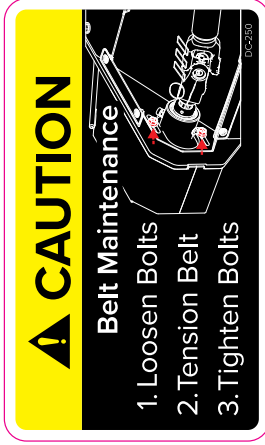

DC-250

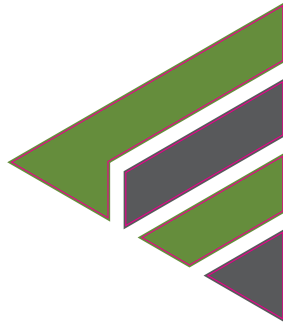

DC-113

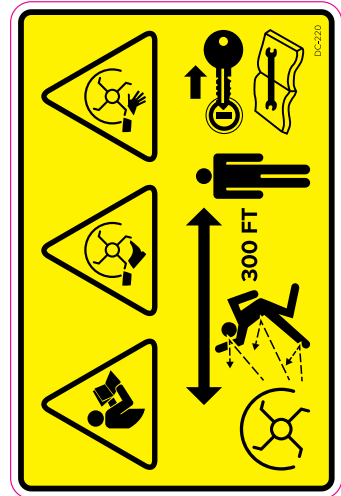

DC-220



DC-308

	DESCRIPTION	MODEL	QTY	P/N
1	VRISIMO LOGO	ALL	2	DC-112
2	DANGER ROTATING DRUM	ALL	5	DC-101
3	VRISIMO ICON	ALL	1	DC-113
4	BELT TENSION WARNING CAUTION	ALL	1	DC-250
5	BELT TENSION WARNING NOTICE	ALL	1	DC-254
6	KEEP GUARD IN PLACE	ALL	5	DC-296
7	PROP 65 WARNING	ALL	1	DC-308
8	READ BEFORE OPERATING	ALL	1	DC-220

Parts: Decal Set

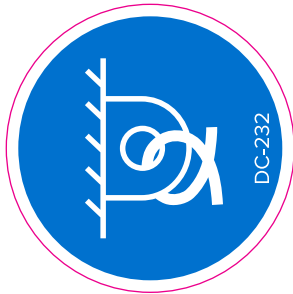

DC-232



DC-236

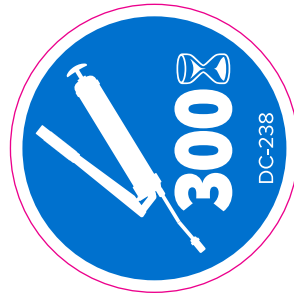

DC-238



DC-349



DC-240

	DESCRIPTION	MODEL	QTY	P/N
10	TIE DOWN POINT	ALL	4	DC-232
11	GREASE 10 HOURS	ALL	10	DC-236
12	GREASE 300 HOURS	ALL	3	DC-238
13	200 HOURS NLGI 1.5 100	ALL	1	DC-349
14	GREASE PTO 10 HOURS	ALL	1	DC-240
15	CAUTION MOVING PARTS - TRIANGLE	ALL	1	DC-270
16	PRODUCT REGISTRATION QR CODE	ALL	1	DC-254

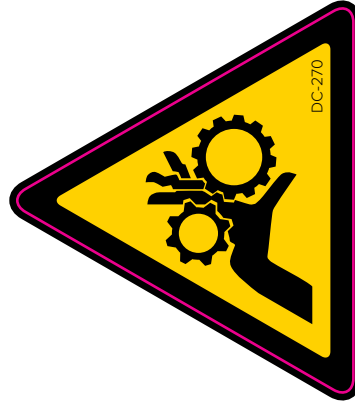

DC-270



DC-348



DC-354

Orchard Low Profile Series
REVISION: LPV3-250910

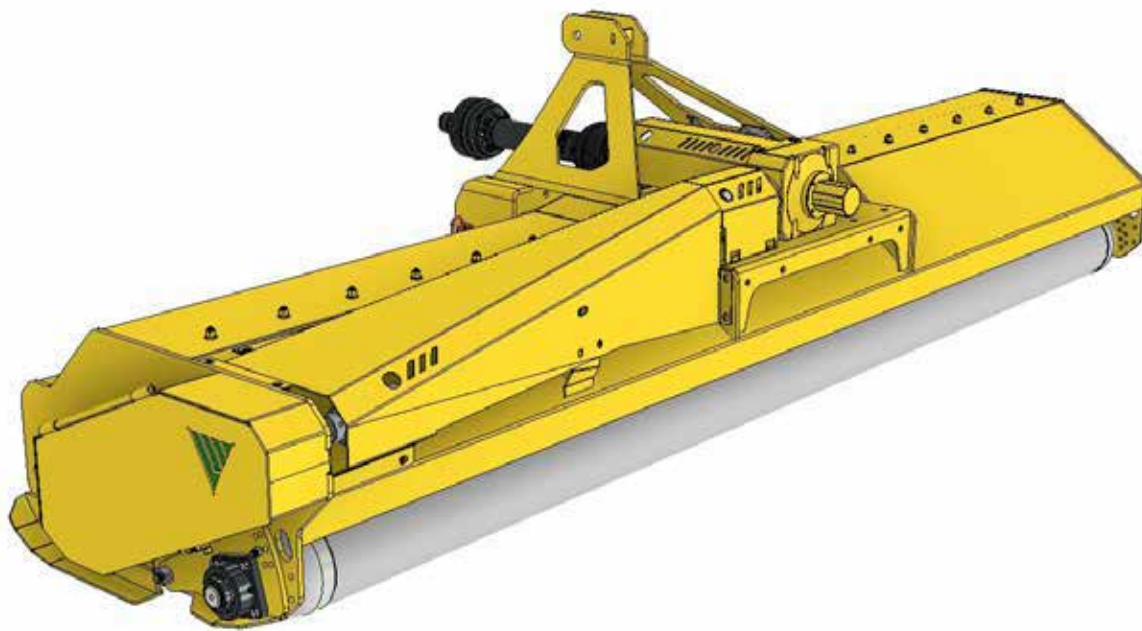

ORCHARD LOW PROFILE SERIES OWNER'S MANUAL



VALLEY TOOL
MANUFACTURING COMPANY

PO Box 220 | 2507 Tully Road | Hughson, CA 95326 | 800-426-5615
www.valleytoolmfg.com