

BERMBLASTER OWNER'S MANUAL



VALLEY TOOL

MANUFACTURING COMPANY

PO Box 220 | 2507 Tully Road | Hughson, CA 95326 | 800-426-5615

www.valleytoolmfg.com



Table of Contents

Introduction

Thank You	1
Warranty	2

Safety

Operational Safety	3
Maintenance Safety	4

Basic Operation

Operation Instructions	5
During Operation	6
Storing Attachment	7

Adjustments & Maintenance

Output and Drive Belt Adjustment	8
Performing Maintenance	9-10
Hydraulic Fluid and Equipment Safety	11
Lock Out/Tag Out	12
Controlling Hazardous Energy	13
Maintenance/Troubleshooting Chart	14

Parts Book

50 BLASTBERM BERM BLASTER HIGH OUTPUT	16
ASY HOUSING RH WITH HARDWARE	17
ASY HOUSING LH WITH HARDWARE	18
ASY FRAME WITH HARDWARE	19
COUPLER 7/8 PUMP DRIVE	20
COUPLER 15/16 PUMP DRIVE	21
ADPTR HUB Z6 PTO DRIVE	22

Dear Customer,

We appreciate your purchase of a BermBlaster attachment. The purpose of this manual is to familiarize you with the operation, adjustment, and maintenance of your new attachment. It was meticulously designed and constructed in accordance with the highest industry standards to provide you with years of dependable service. Before endeavoring to operate the machine, you must read this manual thoroughly and comprehend its operation. Vrisimo reserves the right to make modifications to design and specifications, as well as additions and enhancements to its product, without incurring any obligation to retrofit previously manufactured items. If you ever require additional information, please contact your authorized dealer or customer service.



PO Box 220 | 2507 Tully Road | Hughson, CA 95326
1-800-426-5615
www.valleytoolmfg.com

BermBlaster designed this attachment with operator safety as one of its primary considerations. This attachment was designed with shielding, simple adjustments, and other safety features whenever practicable. Ensure that you and your employees read and comprehend this manual. Only responsible individuals who have been trained to operate in a secure manner and who have read and comprehend this manual should operate any machinery.

Before accepting the equipment, verify the pre-delivery checklist thoroughly with the sales representative. See pg.5

Ensure that you have a comprehensive understanding of the operation, adjustment, and safety principles outlines in this manual.

BermBlaster is solely owned by Valley Tool and Manufacturing.

Visit: www.valleytoolmfg.com

Product Registration



Warranty

Valley Tool & Mfg. warrants each product to be free of manufacturing defects for a period of twelve months (ninety days for rental units) from the date of delivery to the original user/owner, subject to the limitations stated in this policy.

This warranty does not apply to defects caused in whole or in part by unreasonable use while the product is in the user's possession, including but not limited to: failure to properly set up product; failure to provide reasonable and necessary maintenance; normal wear; routine tune-ups or adjustments; improper handling or accidents; operation at speed or load conditions contrary to published specifications; improper or insufficient lubrication; improper storage. This warranty also does not guarantee that the efficacy of every product will meet the purchaser's expectations.

Valley Tool & Mfg. shall not be liable for consequential damages of any kind, including, but not limited to, consequential labor costs or transportation charges associated with the replacement or repair of defective parts; lost time or expenses incurred as a result of said defects. Valley Tool & Mfg.'s total liability is limited to the purchase price of the product.

Valley Tool & Mfg. provides no warranty for trade accessories or any component or accessory of the product that was not manufactured by Valley Tool & Mfg., including any purchased components. These are subject to the respective manufacturer's warranties. If the product or any part of the product is modified or repaired in any manner not expressly authorized by Valley Tool & Mfg., or if closed components are disassembled prior to return, the warranty will be void. Closed components include gearboxes, hydraulic pumps, motors, cylinders, and actuators, among others.

Our obligation under the warranty is expressly limited, at our option, to the replacement or repair at Valley Tool & Mfg., of Hughson, California, or at a service facility specified by us, of the defective part or parts as determined by inspection.

We are not liable for unauthorized replacements or repairs. Warranty pre-approval is required. Authorized supplies will be sent to the dealer at no cost via UPS Ground. The duration of any implied or statutory warranties, such as warranties of merchantability or fitness for a particular purpose, is expressly limited to the duration of this written warranty. No one is authorized to make any other express or implied warranties on our behalf. This warranty cannot be extended, expanded, or altered unless authorized in writing by Valley Tool & Mfg. No warranty will be processed without a timely, signed "Product Registration"

The attachment owner is responsible for the travel time of mechanics and conveyance of the product to the authorized service dealer for warranty work.

The most reasonable and dealer-friendly return policy on the market is provided by Valley Tool & Mfg. The return policies for each of our brands are listed below. We accept returns within 30 days of the date of original shipment. Prior to return shipment, all returns must be approved by Valley Tool & Mfg, and a return authorization number must be issued. Returns must be in "like-new" condition and accompanied by all original factory packaging, including instruction manuals. If an item is received that is not in "like-new" condition or in its original packaging, additional fees will apply. After our staff has completed a thorough inspection of a return, refunds will be issued less shipping fees and any other potential damage fees. Please allow up to 30 business days for the processing of your account refund credit.

Please direct all return-related questions to sales@valleytoolmfg.com.

Safety messages are provided in this manual to describe possible risk during operation, maintenance and transportation. These messages are intended to convey known hazards but cannot be construed to describe all possible risks.

Signal words in Safety Messages:

DANGER

Danger: Indicates immediate risk of serious injury or death.

WARNING

Warning: Indicates possibility of serious injury or death.

CAUTION

Caution: Indicates possibility of minor injury.

NOTICE

Notice: Indicates possibility of property damage, possible machine failure but no immediate risk to personal injury.

Failure to heed any of these warnings may result in personal injury or death.

Operational Safety

Before operating this machinery read the owner's manual thoroughly. Properly train all Operators. It is the Owner's responsibility to ensure all Operators are properly trained in the appropriate language. Use OSHA approved eye, ear and head protection to protect the Operator from flying debris and noise. Never use drugs or alcohol before or during operation of this machine. Only operate this machine when it is in good working order on an appropriate power unit that is in good working order, and with all guards and safety devices in place and functioning. Never allow children or other people to ride on this machine.

DANGER

Keep bystanders and children of the clear work area during operation as debris can be discharged and cause serious injury or death.

Safety

DANGER

Risk of death or injury if moving parts are touched, or are brought into contact with any person. Keep away from all moving parts. Keep guards in place while operating.

Operate only with clear visibility, never in dusty, foggy conditions or at night. Risk of collision or contact with personnel. Crushing, piercing or cutting hazard.



WARNING

Avoid operation that would allow hydraulic lines to be pinched or severed. In the event of a hydraulic leak, hydraulic fluid may have sufficient force to penetrate skin. Do not use any body part to check for leaks. High pressure oil can cause severe injury or death.

Disengage hydraulics, shut off engine and allow all movement to stop before leaving the operator's position to adjust, lubricate, clean or unclog the machine. Do not try to uncouple hydraulic hoses unless the pressure has adequately dissipated.

Risk of serious injury or death due to thrown debris or broken knives. Do not operate closer than 300 ft to people, unprotected roadways or public areas without properly securing or warning protecting against accidental ingress.

CAUTION

Rotating parts, Hydraulic hoses, motors and valves generate heat when operating. Do not touch when hot. Allow to cool before maintaining.

Risk of crushing, pinching or cutting due to motion of machine while maintaining. Ensure all energy is dissipated from hydraulic lines before maintaining. Secure power unit and attachment against motion with wheel chocks, or appropriately sized stands as required.

Remove key from power unit and read manual before maintaining. Risk of accidental motion if key is engaged on power unit. Knives wear parts and damaged components can have sharp edges that cause cuts or lacerations. Wear protective gear and handle these parts with care.



Pre-Delivery Checklist

- Check all nuts and bolts for correct torque.
- Check for shipping damage. If damaged, do not use the attachment until parts have been replaced or repaired.
- Check that all hydraulic hoses and fittings are tight.
- Check that all warning signs (decals) and safety treads are on the attachment and in their correct location. Replace any damaged signs or safety treads.

NOTICE

Only trained operators should attach the BermBlaster. Work on flat ground, keep hands away from pinch points, and shorten or remove the drawbar if needed. Use free-float on tractors with load and depth control.

Coupling and Setup

- Couple the BERM BLASTER to the tractor using the Category II three-point hitch.
- Attach the driveline to the tractor.
- Plug in the hydraulic hose and ensure hoses are kept clear of the driveline.
- Confirm that all guards and shields are properly in place and secure.

PTO Operation

- Engage the PTO and bring the unit up to operating RPM.

NOTICE

Do not engage the PTO at high RPM. Doing so will:

- Decrease the life of belts.
- Potentially damage transmission components.

Misuse can be identified by the squealing of the belts.

Operation with a Spray Rig

- Shaft couplers and yokes must be secured to the drive shaft with set screws before operation.

Towing a Spray Rig

- Place a hitch in the standard 2" receiver tube located at the rear of the BERM BLASTER.
- Secure the hitch in the receiver tube using a receiver pin.

Power for Auxiliary Equipment

- Access to the main drive shaft is available on the rear guard.

This drive shaft provides power for:

- A small roller pump, or
- A driveline-driven spray rig.
- To couple a small roller pump, use Special Coupler Part # 50-BLSTCOUP937 or 50-BLSTCOUP875
- To couple a driveline, use a Shaft Adapter Part 11-H03-32-00433.
- BermBlaster couplers:

50-BLSTCOUP937

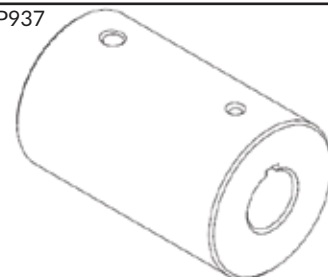

50-BLSTCOUP875

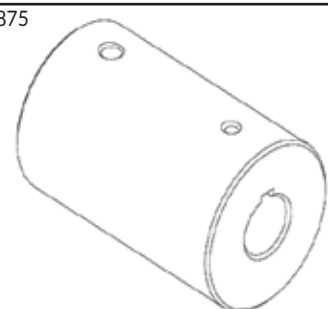

PTO

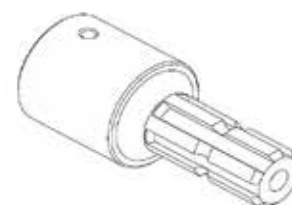

Basic Operation

During Operation

General Safety

- Children should never be allowed on or near the machine.
- Clear the area of all bystanders and objects before moving or operating the unit.
- Always keep hands, feet, and clothing clear of moving parts.
- All shields and guards must be in place and securely fastened at all times.
- Never clean, lubricate, or adjust the equipment while operating.

Coupling and Towing

- Securely attach equipment to the towing unit using the three-point hitch and safety chains (if required).

When descending steep slopes:

- Shift the towing unit to a lower gear before going downhill.
- Use the engine as a retarding force; do not coast downhill.
- Keep the towing vehicle in gear at all times.
- reduce speed when turning corners or driving over rough terrain.

Transporting on Public Roads

- Follow all local and state regulations for transporting agricultural equipment on public roads.

Ensure that:

- Warning lights and slow-moving vehicle signs are clean and visible from both directions.
- Equipment is properly secured and does not obstruct the view of traffic.

Awareness and Surroundings

- Always check for bystanders.
- Look in all directions to confirm it is safe to operate.
- Remember: Inside quiet tractor cabs or during high noise operation, you may not hear people shouting nearby.

Shutdown Procedure

When stopping operation:

- Set the tractor or towing vehicle breaks.
- Disengage the PTO.
- Shift off the engine.
- Remove the ignition key.

Operating Area and Terrain

- Inspect the area before operation for holes, rocks, or hidden obstacles.

Avoid operating near:

- The edge of drop-offs or banks.
- Steep slopes, where equipment overturn could occur.



DANGER

Bystanders can be struck, crush, or hit with debris.
Operate away from other people.



WARNING

Risk of injury due to thrown debris.

Storing Attachment

Shutdown and Unhitching

After completing operation or before unhitching:

1. Stop the tractor or towing vehicle.
2. Set the brakes securely.
3. Disengage the PTO and all other power drives.
4. Shut off the engine and remove the ignition keys.

Safe Storage

- Store the BERM BLASTER in a designated area.
- Do not park equipment where it will be exposed to livestock for extended periods. Damage to the equipment or injury to animals may occur.
- Never permit children to play on or around the stored unit.

Parking and Stability

- Always park the machine on a hard, level surface.
- Engage all safety devices before leaving the equipment unattended.
- Use wheel chocks when necessary to prevent rolling or movement.

Adjustments & Manitenance

Output and Drive Belt Adjustment

Output Adjustment

There are five ways to adjust the air output of the BERM BLASTER to suit varying field conditions:

1. Height Adjustment

- Raise or lower the BERM BLASTER to suit the three-point hitch on the tractor to desired operating height.

2. Air Direction

- Adjust the direction of airflow manually at the end of each nozzle.

3. Nozzle Door Control

- Each nozzle door operates independently via hydraulic cylinders.
- Doors may be partially closed to reduce airflow or fully to virtually stop air output.
- Note: Even when closed, the fan will remain in motion.

4. PTO Speed

- Adjust the PTO RPM up or down to achieve the desired air output level.

5. Vent Adapter Position

- The vent adapter, located at the bottom of each nozzle, can be placed in either an open or closed positioned to fine-tune airflow.

NOTICE

For vineyards, the breakaway nozzles must be removed before operation.

Drive Belt Adjustment

New belts must be re-tightened after the first two hours of use.

Follow these steps to properly tension the drive belts:

1. Remove Guards

- Remove the guard that holds the owner's manual canister.
- Remove the rear guard to gain access to the drive belts.

2. Loosen Fan Unit Bolts

- Loosen the four bolts securing each fan unit to the main frame.

3. Apply Tension

- Use the all-thread tensioner to apply correct belt tension.

4. Measure Belt Deflection

- Proper tension is measured by belt deflection.
- 1/64 inch of deflection per inch of span between the centers of the sheaves.

5. Reference Deflection Values

- Facing the rear of the BERM BLASTER:
 - Left Belt: 27/64" (Apprx. 1/2") deflection.
 - Right Belt: 11/32" (Apprx. 3/8") deflection.

6. Reassemble Guards

- After achieving proper tension, tighten all fan unit bolts securely.
- Reinstall the rear guard and owner's manual canister guard.

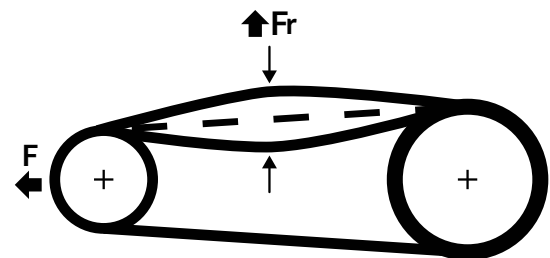

Tension Diagram

Deflection

Adjustments & Maintenance

Performing Maintenance

Bearing Lubrication

- Each BERM BLASTER is equipped with six greaseable bearings.
- Bearings can be greased from above without removing any guards or housings.
- Grease bearings once every 50 hours of use.

NOTICE

Do not over-grease. Overgreasing is indicated by grease pushing out around the bearing seal. If this occurs, replace the bearing immediately.

Importance of Proper Maintenance

- Good maintenance is your responsibility. Poor maintenance leads to unnecessary downtime and damage.
- Regular servicing and inspection are key to long equipment life and reliable performance.
- Routine checks prevent costly repairs and extended downtime.

Handling Heavy Parts and Assemblies

- Some components may be heavy or awkward to handle.

Before loosening or unfastening any part:

- Support is properly using a hoist, blocks, or adequate lifting arrangements.
- Ensure components cannot fall, swing, or shift unexpectedly.
- Always use lifting equipment rated for the load.

WARNING

Never lift equipment over people.

Ventilation and Work Area Safety

- Ensure adequate ventilation during maintenance.

WARNING

Never operate the towing vehicle's engine in a closed building. Exhaust can cause asphyxiation.

Preparing for Maintenance

- Stop the towing vehicle.
- Set the brakes.
- Disengage the PTO and all power drives.
- Shut off the engine.
- Remove the ignition keys.
- Confirm that all moving parts have come to a complete stop.

Safety and Equipment Support

- Always use safety supports and wheel blocks when servicing.
- Use the proper tools and equipment for the task.
- Exercise extreme caution when making adjustments.

Adjustments & Maintenance

Performing Maintenance

Hardware and Replacement Parts

- Use SAE Grade 5, bolts or higher unless otherwise specified.
- After servicing, ensure all tools, parts, and service equipment are removed before operation.
- Use only genuine factory replacement parts to maintain original specifications. The manufacturer assumes no responsibility for damages cause by unapproved parts or accessories.
- If equipment has been altered from its original design, the manufacturer assumes no liability for injury or warranty coverage.

Welding and Cutting Precautions

- Before performing any welding or cutting repairs, ensure that all flammable and combustible materials are removed from the area.

Cleaning Solvents and Fire Safety

- Use cleaning solvents with extreme care.
- Always provide adequate ventilation when using any solvent.
- Avoid inhaling fumes or vapors. Exposure can cause respiratory irritation or serious health risks.

WARNING

Do not use gasoline or other highly flammable petroleum-based solvents. It could cause severe fire hazard.

DANGER

Do not weld or cut on:

- Any tank or container that holds or has held oil, fuel, or flammable substances.
- Any container whose previous contents are unknown.

Adjustments & Maintenance

Hydraulic Fluid and Equipment Safety

Qualified Personnel Only

- Only trained and qualified personnel should perform maintenance or repairs on hydraulic systems.



DANGER

Serious injury or death can result from improper procedures or lack of proper training.

Preventing Crushing Injuries

You may be crushed under falling equipment if proper precautions are not followed.

Always:

- Engage transport locks before working on the unit.
- Ensure the frame is securely blocked and stable.
- Never rely on hydraulics alone to support raised equipment.

High-Pressure Fluid Hazards

Hydraulic fluid under pressure can penetrate the skin, causing serious injury or infection.

Avoid the hazard:

- Relieve all system pressure before disconnecting lines or performing any work.
- Always wear protective gloves and safety glasses or goggles when inspecting or repairing hydraulic components.



WARNING

- Never use your hands to check for leaks- use paper or cardboard instead.
- Do not attempt to disconnect hoses or cylinders while the system is still pressurized.

Emergency Response

- If hydraulic fluid is injected into the skin or eyes, seek immediate medical attention from a physician familiar with a high-pressure injection injuries.
- Treatment must occur within hours to prevent infection or gangrene.

Inspection and Maintenance

- Keep all hoses and fittings in good serviceable condition.

Inspect for:

- Leaks, cracks, abrasion, or loose connections.
- Damage from brush, debris, or rubbing surfaces.
- Perform daily inspections and maintenance to ensure safe operation.
- Replace any loose, broken, or missing hardware immediately.

Hot Fluid and Burn Hazards

- Hydraulic oil and components can become extremely hot during operation.
- Always allow the system to cool before performing maintenance or disconnecting hoses.



CAUTION

Contact with hot oil or metal surfaces can cause burns.

General Hydraulic Safety

- Ensure all connections are tight before applying pressure.

Be aware that:

- Hydraulic failure (burst line or loss of pressure) can cause machinery to drop instantly even if the engine is off.
- Always secure the equipment with solid supports before working beneath or around it.

Adjustments & Maintenance

Lock Out/Tag Out

Think, Plan, Check

- Think through the entire procedure and identify all required steps.
- Plan: who is involved, what must be shut down, which guards will be removed, and how/under what conditions power will be restarted.

Check the machine to verify all power sources and stored energy are identified, including:

- Engines and electrical sources
- Hydraulic and pneumatic systems
- Springs/accumulators
- Suspended load

Zero-Energy State Mandatory

- Shut off and lock out power before adjusting, servicing, maintaining, or clearing obstructions.



DANGER

Unsecured motion can cause crushing or cutting and may result in serious injury or death.

- Communicate to everyone involved (and nearby bystanders) that work is being performed and the machine must remain at zero energy state.

OSHA Requirements (29 CFR 1910.147)

The LOTO standard establishes the employer's responsibility to protect workers from hazardous energy. Employers must ensure workers know, understand, and follow the energy control procedures, including:

- Proper LOTO practices and procedures for controlling hazardous energy during servicing and maintenance of machines and equipment.
- Training so workers understand the purpose and function of the energy control program and have the knowledge/skills for safe application, use, and removal of energy control devices.

Instruction for all employees in the area where LOTO is used about: The purpose and use of energy control procedures, and the prohibition against attempting to restart or re-energize equipment that is locked or tagged out.

Additional training for authorized employees (those who apply locks/tags and perform service) covering:

- Recognition of hazardous energy sources present,
- Type and magnitude of energy, and
- Means and methods of isolating/controlling that energy.
- Specific procedures and limitations relating to tagout systems (where permitted).
- Retraining as needed to maintain proficiency or when methods/procedures change.

Standard LOTO Sequence

1. Notify affected personnel and stop the machine.
2. Isolate all energy sources (electrical, hydraulic, pneumatic, mechanical, gravity, thermal).
3. Apply locks and tags to each isolation device.
4. Release/secure stored energy (bleed down hydraulics/pneumatics, block/sling suspended loads, discharge springs, etc.).
5. Verify zero energy: try-start or test controls to confirm isolation, then return controls to OFF/neutral.
6. Perform the work.
7. Restore to service: remove tools/blocks, reinstall guards, clear personnel, remove locks/tags (by the person who applied them), and notify affected employees.

Controlling Hazardous Energy

- Step 1: Prepare for shutdown. It must be determined what type of power system is going to be deactivated including electrical, hydraulic, pneumatic or other energy sources. Knowledge of shut down methods is necessary.
- Step 2: Shutdown the equipment. This should be completed consistent with the manufacturer's instructions for the shutdown procedure and could be as simple as placing a switch in the "off" position or pressing a button.
- Step 3: Isolate the equipment. This step involves closing of valves, throwing the main disconnects or circuit breakers and disconnecting or capping any auxiliary power sources or secondary electrical systems.
- Step 4: Apply the lockout/tagout device. This is done to prevent restoration of the flow of energy and is done at all disconnect switches, valves or other energy isolating devices. Locks are the preferred method of controlling energy and should be supplemented with tags. Various lockout devices are available including group lockout hasps. Locks should be individually assigned and have only one key.
- Step 5: Control the stored energy. This step includes the release, disconnect or restraint of any residual hazardous energy which may be present and a check that all moving parts have stopped moving. It may also include the installation of "pancakes" or blanking of pipe flanges, the installation of ground wires to discharge electrical capacitors and the blocking or supporting of elevated equipment.
- Step 6: Verify isolation of equipment. Double-check the steps and verify that the equipment indeed has been shut down and that the lock and tag do control the stored energy. Employees should be warned and the system tested, including pressing of all start buttons to assure that the equipment will not start.

Adjustment & Maintenance

Maintenance

ITEM	Interval
Inspect & Tighten Drive Belts	2 hours after initial use
Inspect & Tighten Drive Belts as necessary	Every 8 hours of run time
Grease Zerks as needed	Every 50 hours of run time
Review safety instructions with operators	Monthly
Clean and Paint	As needed
Replace All Safety Guards	Always

Troubleshooting

PROBLEM	POSSIBLE CAUSE	SOLUTION
Drive Belt Squealing	Belts not tensioned properly	Tighten / Replace Drive Belts
Sheaves hot or discolored	Belts not tensioned properly	Tighten / Replace Drive Belts



VALLEY TOOL

MANUFACTURING COMPANY

Order Parts Online
shop.valleytoolmfg.com

- Shop OEM Parts
- Fast Shipping
- Easy Checkout



QUESTIONS: Parts@Valleytoolmfg.com

50-BLASTBERM BERM BLASTER HIGH OUTPUT

ITEM	DESCRIPTION	PART NUMBER	QTY
1	ASY HOUSING RH WITH HARDWARE	10142	1
2	ASY HOUSING LH WITH HARDWARE	10151	1
3	ASY FRAME WITH HARDWARE	10160	1
4	GUARD UPR FR	10175	1
5	ASY REAR GUARD PULLEY COVER	10177	1

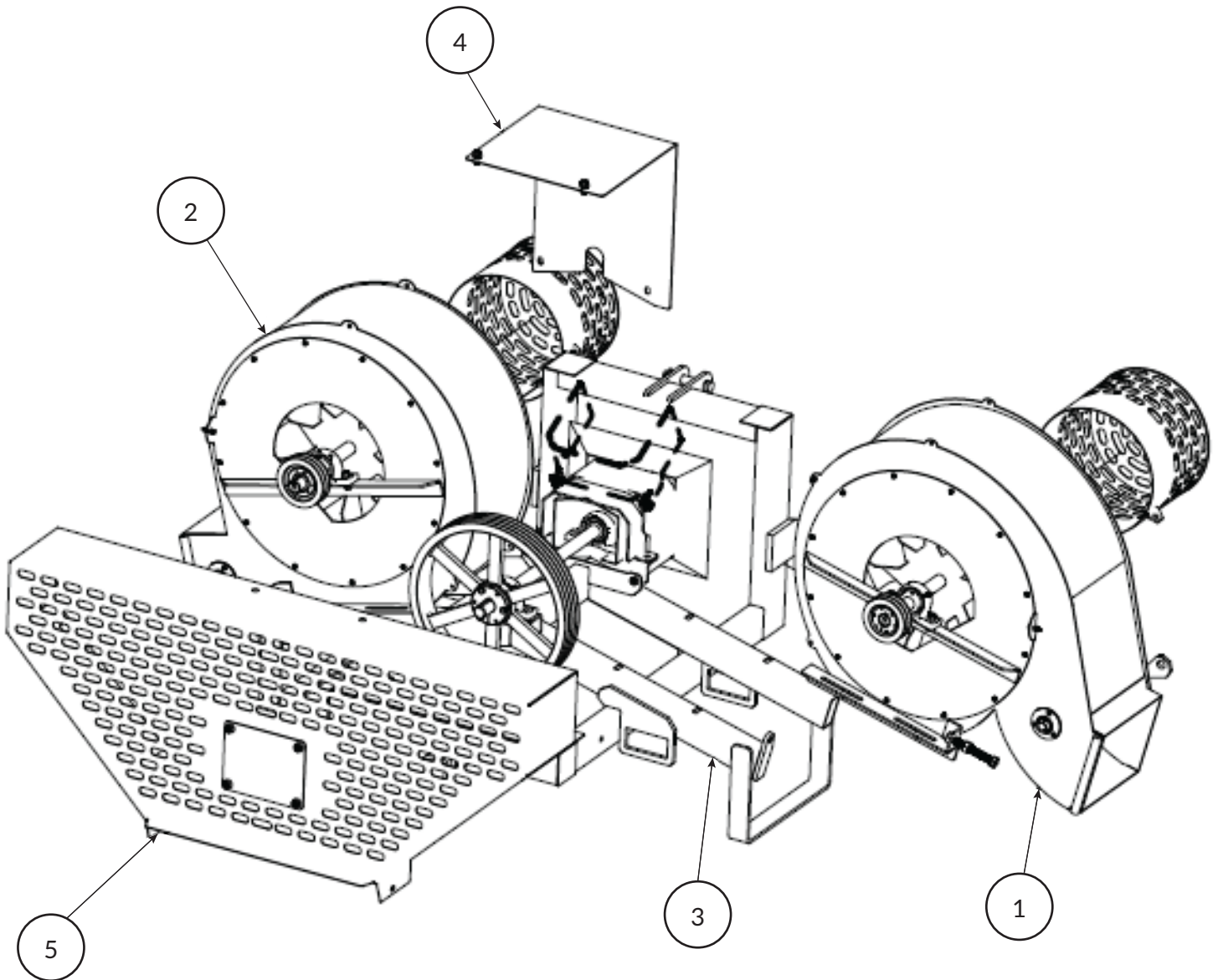

ASY HOUSING RH WITH HARDWARE

ITEM	DESCRIPTION	PART NUMBER	QTY
1	ASY FAN BERM BLASTER 50-BLASTFANONLY	10119	1
2	ASY INTAKE GAURD	10128	1
3	ASY WLDMNT HOUSING RH	10136	1
4	ASY DOOR BLWR CONTROL	10145	1
5	BRG INSERT NONRELUBE	50-BLSTDOORBRG	2
6	HHCS 3/4-10 X 6 GR5 CLZ	92865A859	1
7	BUSHING DRIVEN RH	50-BLSTRDSBUSH	1
8	SHEAVE 2B50SDS	50-BLSTSHEAVE5	1
9	HCP208 24 1/8NPT1 1/2" PB BERM BLASTER	50-BLSTBRG150	2
10	FTG 1/8 F NPT ZERK STR	1095K15	3
11	LINCH PIN 7/16IN	P-791	1

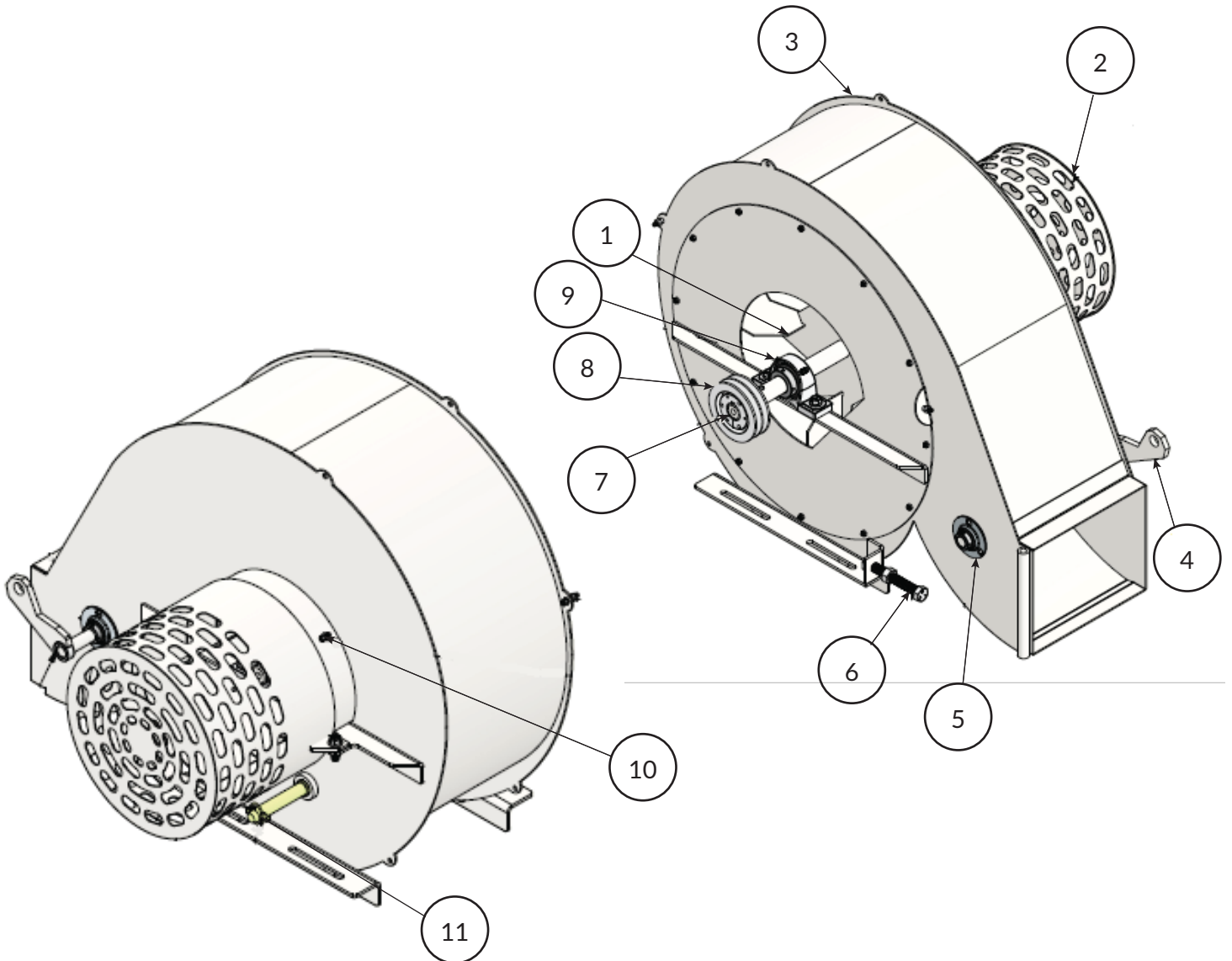

ASY HOUSING LH WITH HARDWARE

ITEM	DESCRIPTION	PART NUMBER	QTY
1	ASY FAN BERM BLASTER 50-BLASTFANONLY	10119	1
2	ASY DOOR BLWR CONTROL	10145	1
3	BRG INSERT NONRELUBE	50-BLSTDOORBRG	2
4	HCP208 24 1/8NPT1 1/2" PB BERM BLASTER	50-BLSTBRG150	2
5	FTG 1/8 F NPT ZERK STR	1095K15	2
6	ASY WLDMT HOUSING LH	10149	1
7	1/8-MNPT X 1/4 PTC FTG	5779K108	2
8	HHCS 3/4-10 X 6 GR5 CLZ	92865A859	1
9	BUSHING SDS DRIVEN	50-BLSTRSDSBUSH	1
10	SHEAVE DRIVEN LEFT	50-BLSTSHEAVE5.6	1

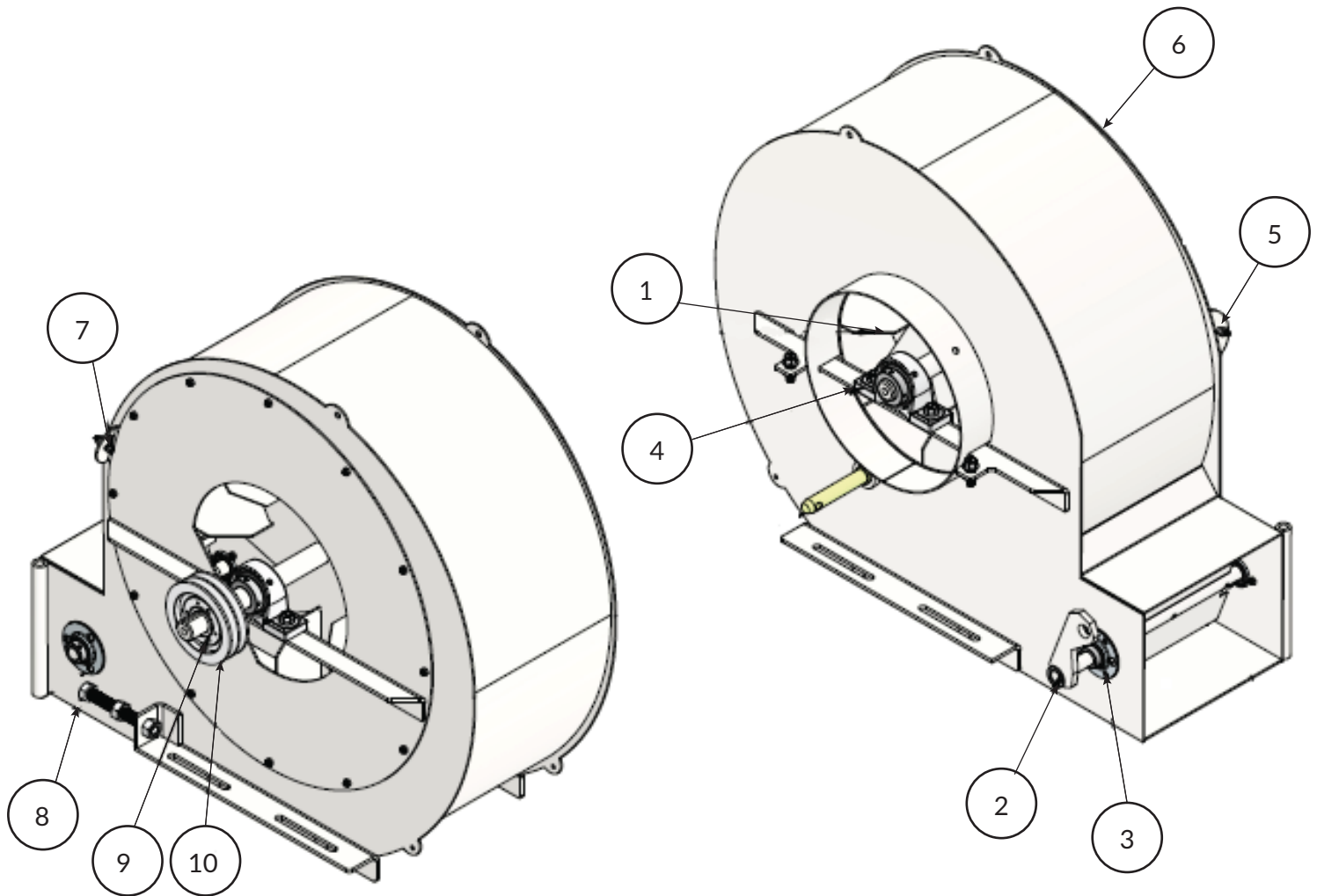

ASY FRAME WITH HARDWARE

ITEM	DESCRIPTION	PART NUMBER	QTY
1	ASY FRAME BERM BLASTER	10153	1
2	SHAFT CENTER MAIN DRIVE	10174	1
3	PIN 1-1/8 CAT.2 LIFT PIN	10182	2
4	LINCH PIN 7/16IN BARECO B6	P-791	3
5	PIN TOP LINK 1 X 4.25 IN	TP-81	1
6	BUSHING SF 1.500	SF1500	1
7	SHEAVE 4B200SF	BLS 4B200SF	1
8	HCP208 24 1/8NPT1 1/2" PB BERM BLASTER	50-BLSTBRG150	2
9	BEARING	50-BLSTBRG	1

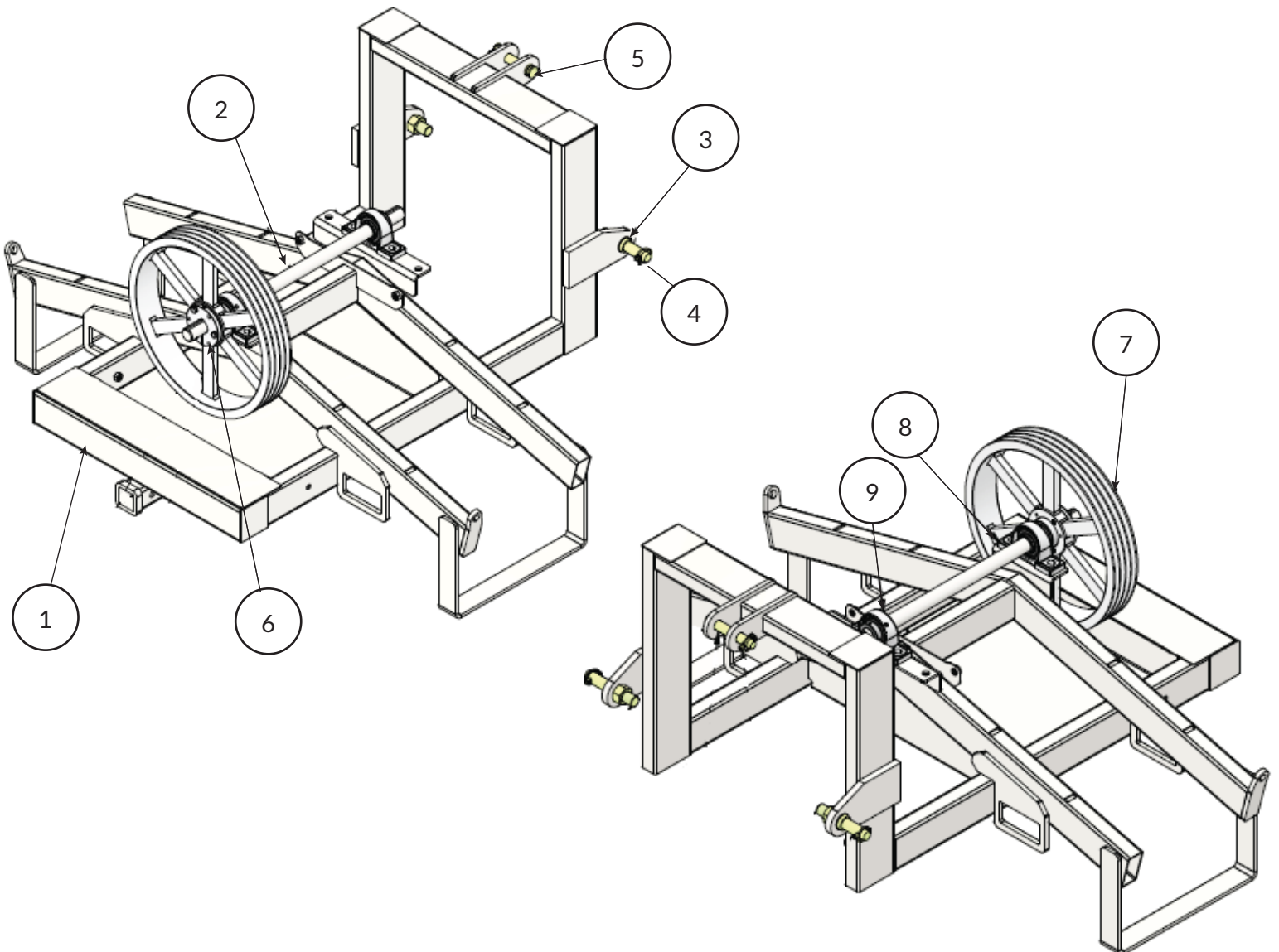

COUPLER 7/8 PUMP DRIVE

ITEM	DESCRIPTION	PART NUMBER	QTY
1	50-BLSTCOUP875	10233	1

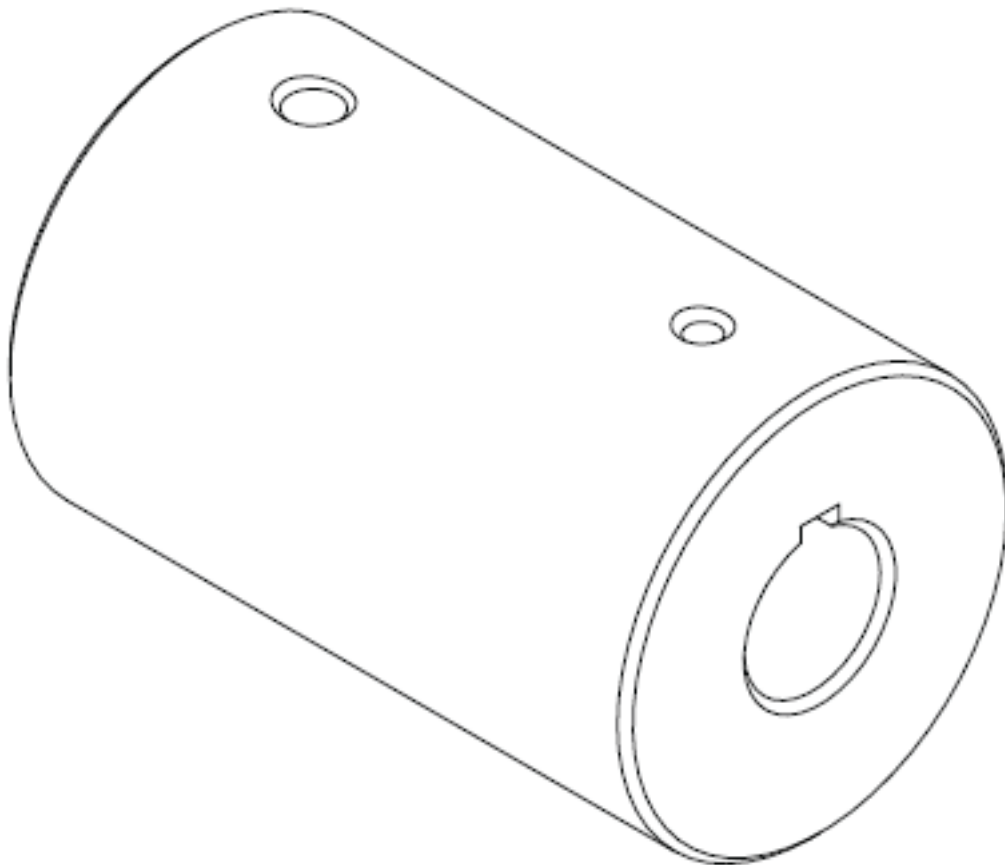

COUPLER 15/16 PUMP DRIVE

ITEM	DESCRIPTION	PART NUMBER	QTY
1	50-BLSTCOUP937	10234	1

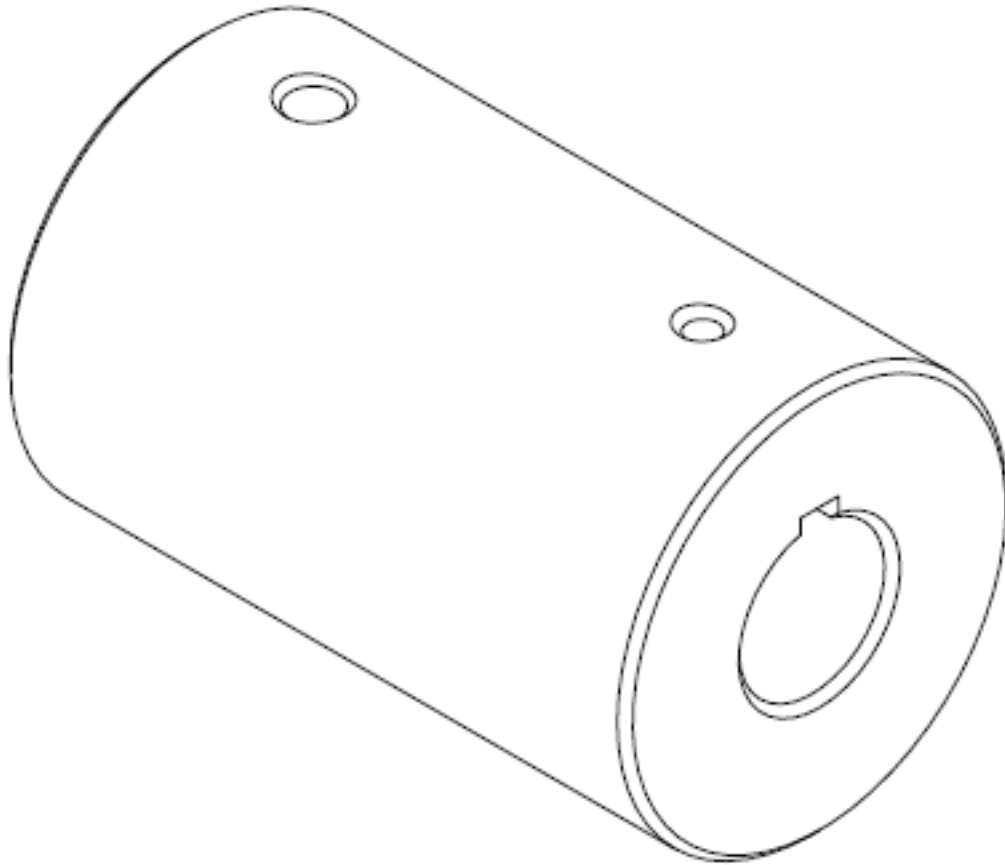

ADPTR HUB Z6 PTO DRIVE

ITEM	DESCRIPTION	PART NUMBER	QTY
1	COUPLER Z6 PUMPDRIVE	10235	1

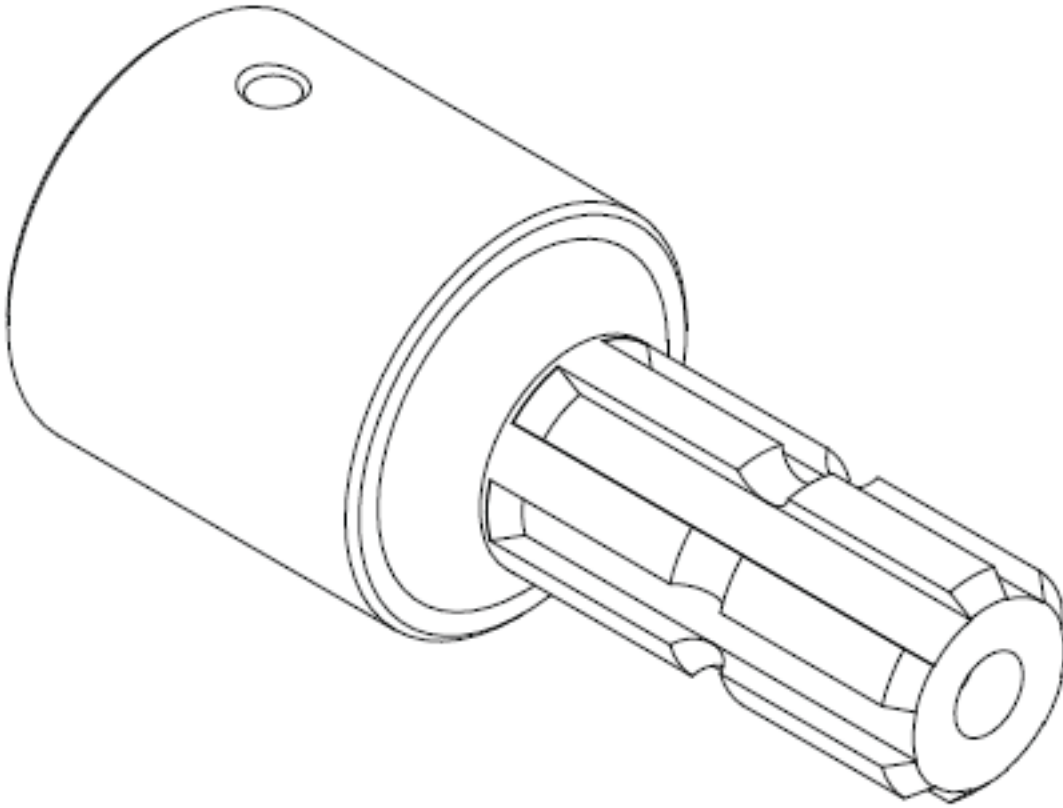



REV251020

BERMBLASTER OWNER'S MANUAL



VALLEY TOOL

MANUFACTURING COMPANY

PO Box 220 | 2507 Tully Road | Hughson, CA 95326 | 800-426-5615

www.valleytoolmfg.com