

BL-SERIES ORCHARD BLOWER OWNER'S MANUAL

BL-Series Orchard Blower
Owner's Manual

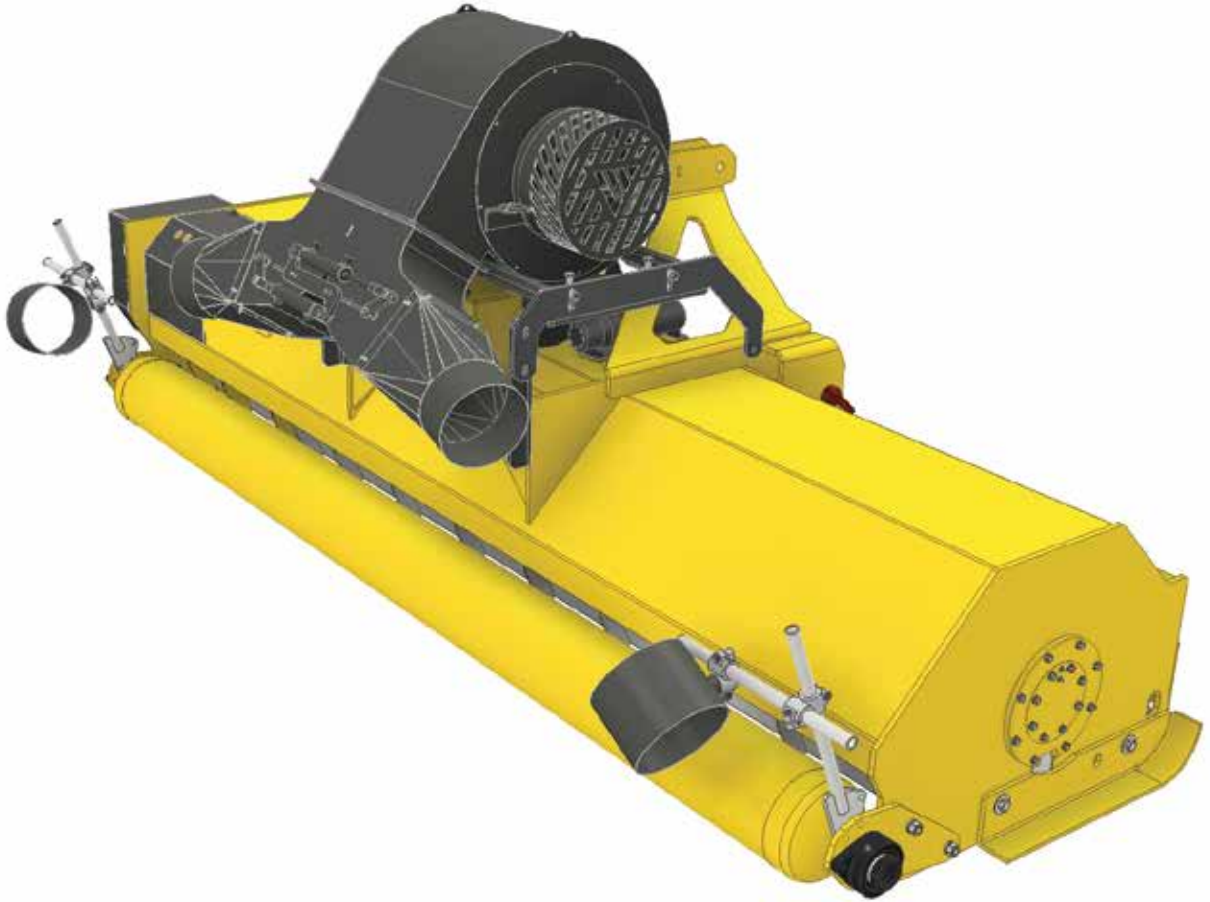

VALLEY TOOL

MANUFACTURING COMPANY

PO Box 220 | 2507 Tully Road | Hughson, CA 95326 | 800-426-5615

www.valleytoolmfg.com

Table Of Contents

Introduction

Thank You	1
Warranty	2

Safety

Operational Safety	3
Maintenance Safety	4

Basic Operation

Hook Up Procedure	5
Starting Procedure	5
Running the Attachment	5
Shut Down Procedure	5

Installation

Installation on LP Version 2	6
Installation on Sanitizer	7
Installation on LP Version 3	8

Adjustments & Maintenance

Belt Tension	9-10
Blower Height Adjustments	10
Cleaning the Blower	10
Lubrication	10

Parts Book

Drive Detail	12
Blower Housing	13
Control Valves	14
Sanitizer Install Left	15
Sanitizer Install Right	16
Decals	17

Thank You

Dear Customer,

We appreciate your purchase of a Vrisimo attachment. The purpose of this manual is to familiarize you with the operation, adjustment, and maintenance of your new attachment. It was meticulously designed and constructed in accordance with the highest industry standards to provide you with years of dependable service. Before endeavoring to operate the machine, you must read this manual thoroughly and comprehend its operation. Vrisimo reserves the right to make modifications to design and specifications, as well as additions and enhancements to its product, without incurring any obligation to retrofit previously manufactured items. If you ever require additional information, please contact your authorized dealer or customer service.



PO Box 220 | 2507 Tully Road | Hughson, CA 95326
1-800-426-5615
www.valleytoolmfg.com

Vrisimo designed this attachment with operator safety as one of its primary considerations. This attachment was designed with shielding, simple adjustments, and other safety features whenever practicable. Ensure that you and your employees read and comprehend this manual. Only responsible individuals who have been trained to operate in a secure manner and who have read and comprehend this manual should operate any machinery.

Before accepting the equipment, verify the pre-delivery checklist thoroughly with the sales representative.

Ensure that you have a comprehensive understanding of the operation, adjustment, and safety principles outlines in this manual.

Vrisimo Attachments is solely owned by Valley Tool and Manufacturing.

Visit: www.valleytoolmfg.com

Product Registration



Valley Tool & Mfg. warrants each product to be free of manufacturing defects for a period of twelve months (ninety days for rental units) from the date of delivery to the original user/owner, subject to the limitations stated in this policy.

This warranty does not apply to defects caused in whole or in part by unreasonable use while the product is in the user's possession, including but not limited to: failure to properly set up product; failure to provide reasonable and necessary maintenance; normal wear; routine tune-ups or adjustments; improper handling or accidents; operation at speed or load conditions contrary to published specifications; improper or insufficient lubrication; improper storage. This warranty also does not guarantee that the efficacy of every product will meet the purchaser's expectations.

Valley Tool & Mfg. shall not be liable for consequential damages of any kind, including, but not limited to, consequential labor costs or transportation charges associated with the replacement or repair of defective parts; lost time or expenses incurred as a result of said defects. Valley Tool & Mfg.'s total liability is limited to the purchase price of the product.

Valley Tool & Mfg. provides no warranty for trade accessories or any component or accessory of the product that was not manufactured by Valley Tool & Mfg., including any purchased components. These are subject to the respective manufacturer's warranties. If the product or any part of the product is modified or repaired in any manner not expressly authorized by Valley Tool & Mfg., or if closed components are disassembled prior to return, the warranty will be void. Closed components include gearboxes, hydraulic pumps, motors, cylinders, and actuators, among others.

Our obligation under the warranty is expressly limited, at our option, to the replacement or repair at Valley Tool & Mfg., of Hughson, California, or at a service facility specified by us, of the defective part or parts as determined by inspection.

We are not liable for unauthorized replacements or repairs. Warranty pre-approval is required. Authorized supplies will be sent to the dealer at no cost via UPS Ground. The duration of any implied or statutory warranties, such as warranties of merchantability or fitness for a particular purpose, is expressly limited to the duration of this written warranty. No one is authorized to make any other express or implied warranties on our behalf. This warranty cannot be extended, expanded, or altered unless authorized in writing by Valley Tool & Mfg. No warranty will be processed without a timely, signed "Product Registration"

The attachment owner is responsible for the travel time of mechanics and conveyance of the product to the authorized service dealer for warranty work.

The most reasonable and dealer-friendly return policy on the market is provided by Valley Tool & Mfg. The return policies for each of our brands are listed below. We accept returns within 30 days of the date of original shipment. Prior to return shipment, all returns must be approved by Valley Tool & Mfg, and a return authorization number must be issued. Returns must be in "like-new" condition and accompanied by all original factory packaging, including instruction manuals. If an item is received that is not in "like-new" condition or in its original packaging, additional fees will apply. After our staff has completed a thorough inspection of a return, refunds will be issued less shipping fees and any other potential damage fees. Please allow up to 30 business days for the processing of your account refund credit.

Please direct all return-related questions to sales@valleytoolmfg.com.

Safety

Safety messages are provided in this manual to describe possible risk during operation, maintenance and transportation. These messages are intended to convey known hazards but cannot be construed to describe all possible risks.

Signal words in Safety Messages:

DANGER

Danger: Indicates immediate risk of serious injury or death.

WARNING

Warning: Indicates possibility of serious injury or death.

CAUTION

Caution: Indicates possibility of minor injury.

NOTICE

Notice: Indicates possibility of property damage, possible machine failure but no immediate risk to personal injury.

Failure to heed any of these warnings may result in personal injury or death.

Operational Safety

Before operating this machinery read the owner's manual thoroughly. Properly train all Operators. It is the Owner's responsibility to ensure all Operators are properly trained in the appropriate language. Use OSHA approved eye, ear and head protection to protect the Operator from flying debris and noise. Never use drugs or alcohol before or during operation of this machine. Only operate this machine when it is in good working order on an appropriate power unit that is in good working order, and with all guards and safety devices in place and functioning. Never allow children or other people to ride on this machine.

DANGER

Keep bystanders and children of the clear work area during operation as debris can be discharged and cause serious injury or death. Maintain a minimum distance of 300 ft.



DANGER

Risk of death or injury if moving parts are touched, or are brought into contact with any person. Keep away from all moving parts. Keep guards in place while operating.

Operate only with clear visibility, never in dusty, foggy conditions or at night. Risk of collision or contact with personnel. Crushing, piercing or cutting hazard.



WARNING

Avoid operation that would allow hydraulic lines to be pinched or severed. In the event of a hydraulic leak, hydraulic fluid may have sufficient force to penetrate skin. Do not use any body part to check for leaks. High pressure oil can cause severe injury or death.

Disengage hydraulics, shut off engine and allow all movement to stop before leaving the operator's position to adjust, lubricate, clean or unclog the machine. Do not try to uncouple hydraulic hoses unless the pressure has adequately dissipated.

Risk of serious injury or death due to thrown debris or broken knives. Do not operate closer than 300 ft to people, unprotected roadways or public areas without properly securing or warning protecting against accidental ingress. Risk of fire due to knife contact with stones, concrete, steel or other hard objects. Sparks can ignite dry grass, wood chips or other flammable material. Do not operate in dry grass, severe fire risk areas or in an area actively burning or recently burned. Consult local requirements around operation during Fire Weather Watch or Red Flag Warning conditions.

CAUTION

Rotating parts, Hydraulic hoses, motors and valves generate heat when operating. Do not touch when hot. Allow to cool before maintaining.

Risk of crushing, pinching or cutting due to motion of machine while maintaining. Ensure all energy is dissipated from hydraulic lines before maintaining. Secure power unit and attachment against motion with wheel chocks, or appropriately sized stands as required.

Remove key from power unit and read manual before maintaining. Risk of accidental motion if key is engaged on power unit. Knives, wear parts and damaged components can have sharp edges that cause cuts or lacerations. Wear protective gear and handle these parts with care.

CAUTION



Keep Guards In Place

DC-296

Basic Operation

Pre-Delivery Checklist

- Check all nuts and bolts for correct torque.
- Check for shipping damage. If damaged, do not use the attachment until parts have been replaced or repaired.
- Check that all hydraulic hoses and fittings are tight.
- Check that all warning signs (decals) and safety treads are on the attachment and in their correct location. Replace any damaged signs or safety treads.

Hook Up Procedure

1. Align tractor with implement. Attach lower lift arms.
2. Attach upper 3-point arm. Adjust length for desired approach angle.
3. Install PTO, tube attached to mower, bar attached to tractor.
4. Connect hydraulic lines to tractor remotes. Typical install will require two remotes, one for each nozzle control cylinder.
5. With the attachment and PTO line connected check the drive shaft through the entire lifting range checking for binding, bottoming, uncoupling, or attachment contact.

Starting Procedure

1. Start engine and set throttle to idle. Never engage the PTO with the motor above idle speed.
2. With the motor at low RPM engage the PTO output.
3. Slowly bring the throttle up to ⁵⁴⁰PTO RPM. If the Attachment produces excessive noise or vibration, disengage the PTO and shut down the Power Unit immediately. Determine the cause of the problem and correct it before continuing with its operation.
4. Check functionality of each nozzle control cylinder.
5. Attachment is ready for operation.

Running the Attachment

1. Determine ground speed based on terrain and material being cut. This will typically fall within the 0-5 mph range.
2. Adjust the hitch to the approximate desired cutting height.
3. Adjust blower nozzles to achieve desired effect.
4. Make sure PTO is properly attached.

Shut Down Procedure

1. Shut off Power Unit and set parking brake. Wait for the attachment to stop all motion.
2. Disengage the PTO drive and position it for storage or transport (See the "Storage and Transport" section for details on proper storage).
3. Visually inspect the PTO shaft, all the bearings and gearbox for excessive heat or leaks.

Installation Procedure

Installation on LP Version 2 (2005-2021)

1. Install rear brackets.
2. Remove yoke from gearbox.
 - a. Shorten top shaft by 6" and add a keyway.
3. Install frame rails. Match drill using ½" drill bit. Center punch to match frame rails. *Recommend using HSS Silver and Deming 135° Split Point.*
4. Install 6-Spline adapter assembly. Place belt over pulley. Add top shaft.
5. Install blower assembly on frame. Place belt over blower pulley.
6. Tension belt using 4X jack screws.
7. Lock frame using slide bolts. Install guards.
8. Install end-duct assembly on left and right sides.
9. Install hose on each side.

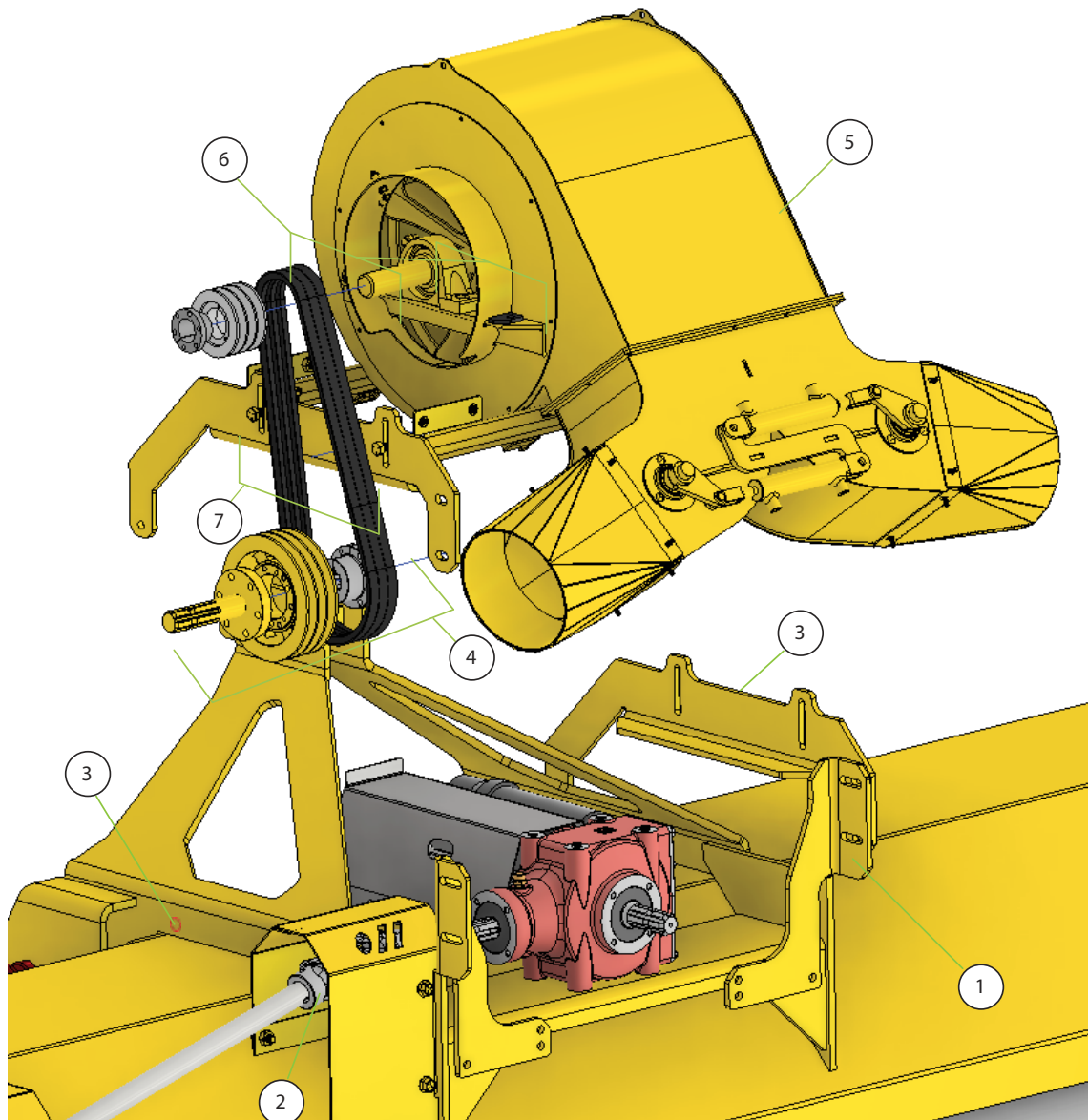

Installation Procedure

Installation on Sanitizer

1. Install rear brackets.
2. Remove yoke from gearbox.
 - a. Shorten top shaft by 6" and add a keyway.
3. Install frame rails. Match drill using $\frac{1}{2}$ " drill bit. Center punch to match frame rails. *Recommend using HSS Silver and Deming 135° Split Point.*
4. Install 6-Spline adapter assembly. Place belt over pulley. Add top shaft.
5. Install blower assembly on frame. Place belt over blower pulley.
6. Tension belt using 4X jack screws.
7. Lock frame using slide bolts. Install guards.
8. Install end-duct assembly on left and right sides.
9. Install hose on each side.

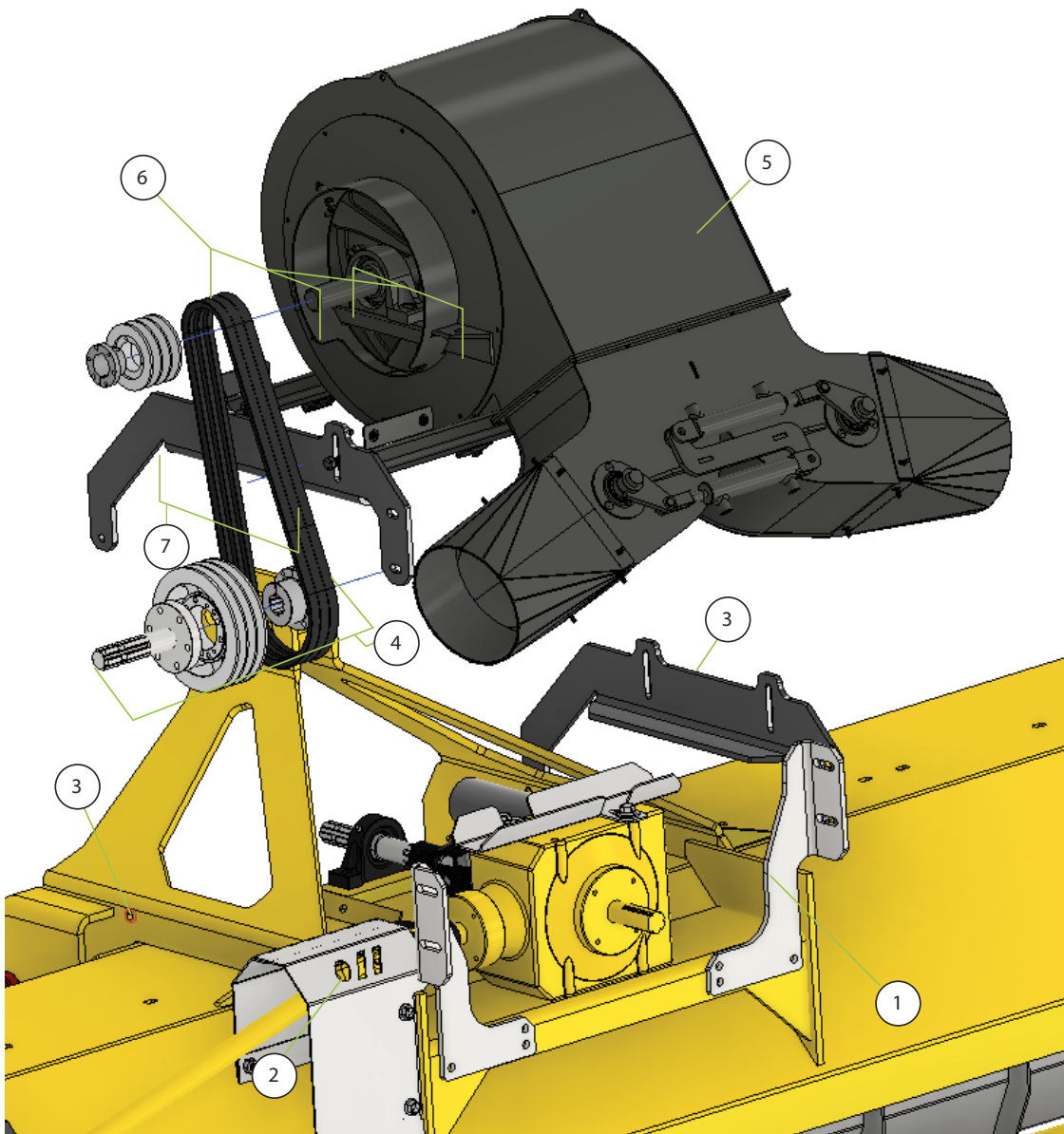

Installation Procedure

Installation on LP Version 3 (2022+)

1. Install rear brackets.
2. Remove yoke from gearbox.
3. Install frame rails.
4. Install 6-spline adapter assembly. Place belt over pulley. Add top shaft.
5. Install blower assembly on frame. Place belt over blower pulley.
6. Tension belt using 4X jack screws.
7. Lock frame using slide bolts. Install guards.
8. Install end-duct assembly on left and right sides.
9. Install hose on each side.

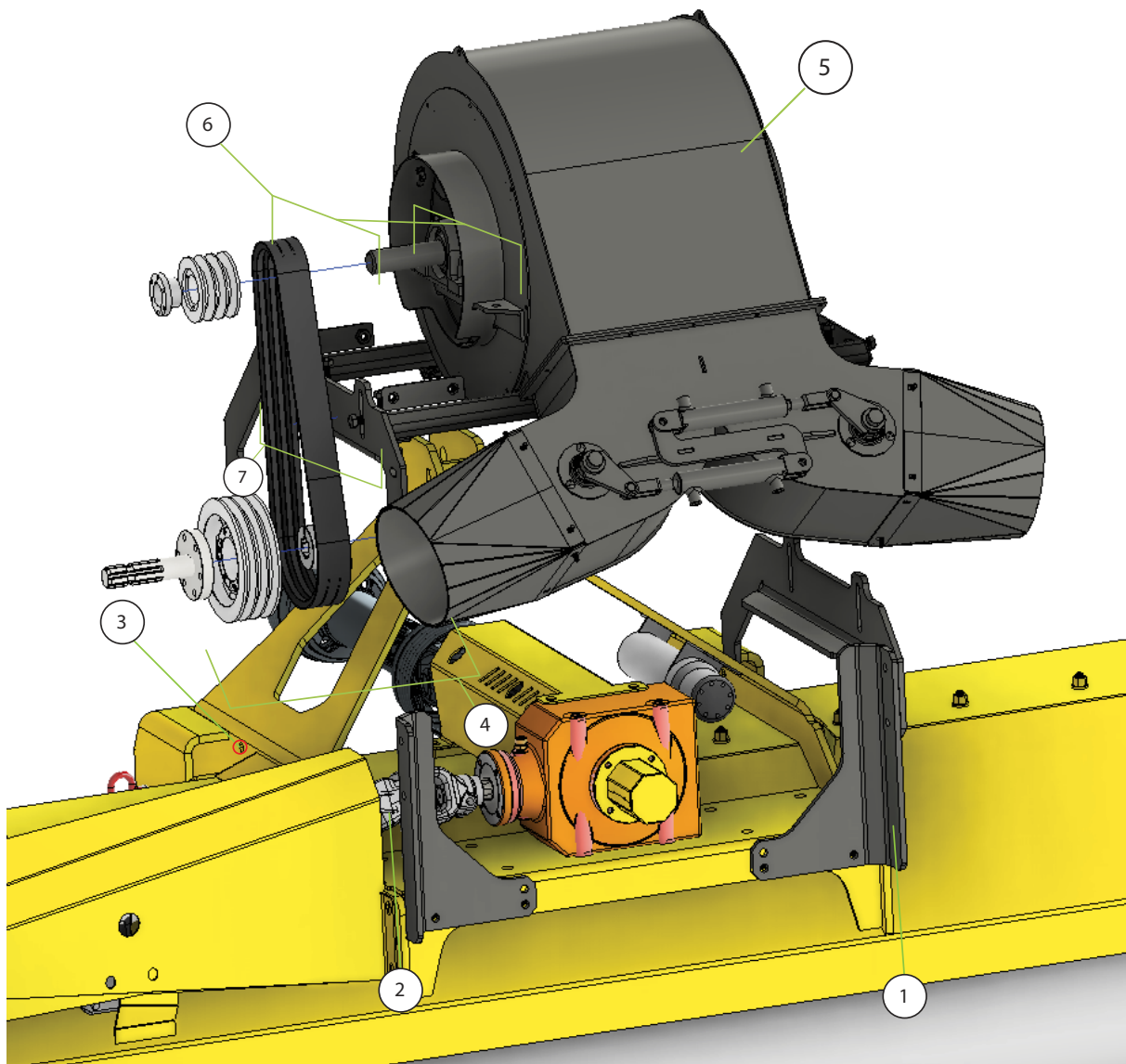

Adjustments & Maintenance

NOTICE

Notice: Before maintenance, stop all motion, power down the unit, and remove the key. Block the tires and support both ends of the machine to prevent movement.

Inspect wear components like belts and bearings individually, as they wear at different rates.

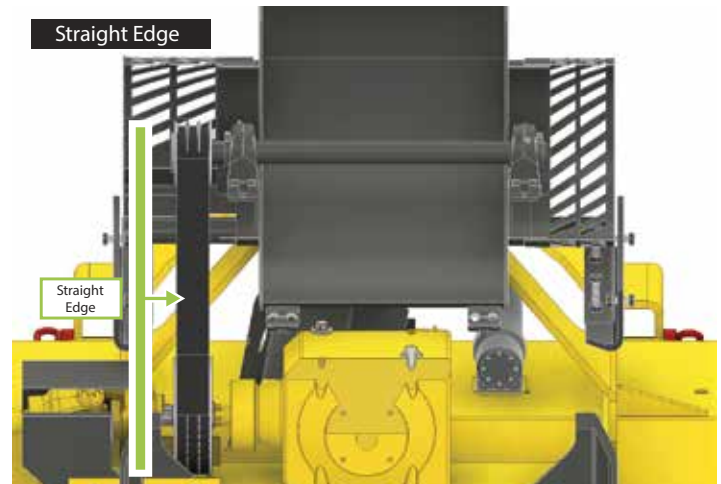

Belt Tension

1. Belt adjustment is achieved by raising and lowering the blower assembly in the blower support frame.
 - a. To adjust belt, loosen frame bolts and use jack screws to raise or lower blower assembly to desired tension.
 - b. There are 4 jack screws used to adjust height, turn counterclockwise to lower and clockwise to raise.
 - c. Adjustment of left or right side more than the other can be used to adjust pulley angle as required.
 - d. Use a straight edge to ensure pulleys are in line.

2. Run-In

- a. Check tension after 2 hours of operation from first startup.
- b. Add tension as required using instructions above.

3. Routine Tensioning

- a. Check tension every 10 hours of operation or before startup each day.
- b. Belt will stretch over time.
- c. Operating with loose belt will cause excess heat and result in belt failure.

4. Belt Life

- a. Replace belt when worn, cracked, or damaged.
- b. Protect from sunlight when stored for extended period
- c. Life can be extended by removing tension during storage.

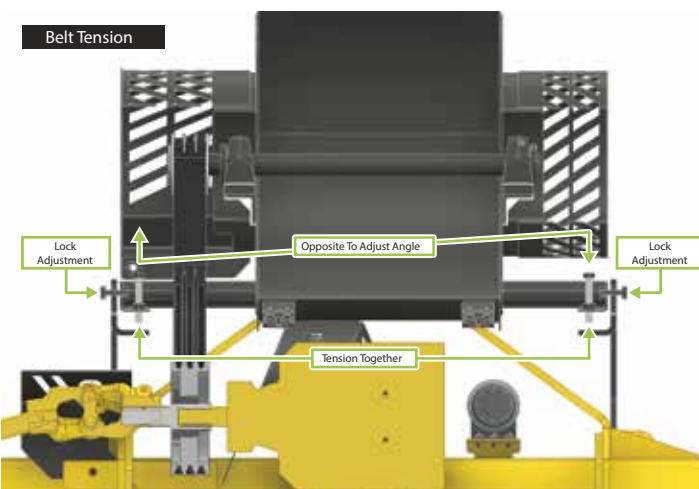

Adjustments & Maintenance

Tension Diagram

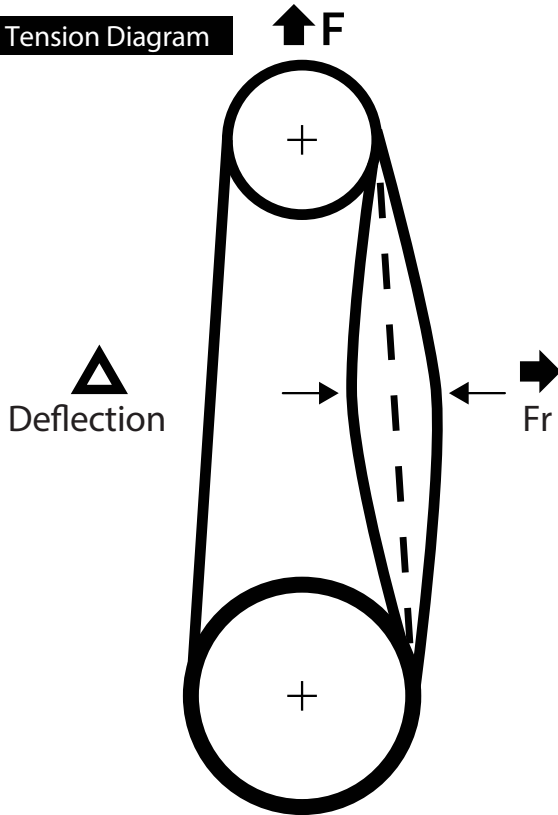

	NEW	USED
F =	788 - 844 lbf.	675 - 731 lbf.
Δ =	$\frac{3}{8}$ " Deflection	$\frac{3}{8}$ " Deflection
Fr =	6.3 - 6.7 lbf.	5.4 - 5.8 lbf.

Blower Height Adjustments

1. The output nozzle height of the blower can be adjusted by sliding nozzle support tube to desired position.

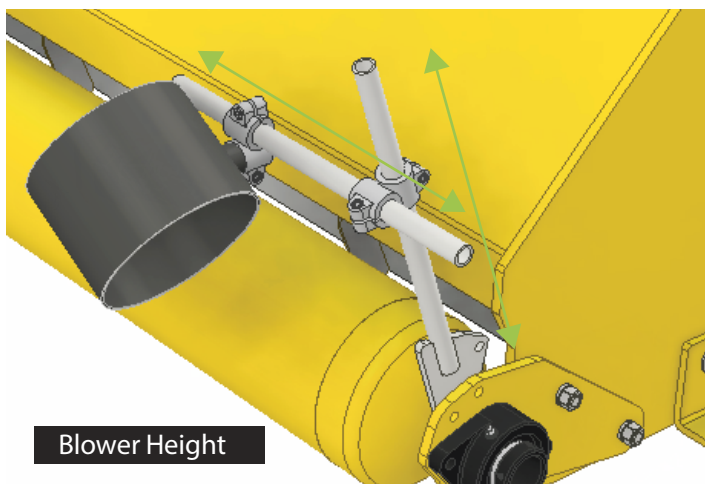

Blower Height

Cleaning the Blower

1. Check for excessive grease in bearing areas on the pulley side of the blower. Make sure that grease is not allowed to get into the belt areas.
2. Clean any clippings from the gearbox areas, pulley areas and anywhere else that is prone to excessive heat where fire can start.
3. Clean the inside of the blower with a pressure washer make sure the inside of the blower is kept free from mud and compact grass. Keep in mind that mud built up on the blower fan can cause imbalance.
4. Preserve damaged decals or replace them if they are unreadable. Decal kits can be obtained from your local Vrisimo dealer.

Lubrication

Valley Tool recommends greasing with [NLGI 2 ISO VG460](#). Any lithium based NLGI Grade 2 grease that is ISO 460 VG and of high quality will work. DO NOT use grease designed for tractor pins and bushings.

Lubrication Schedule

LUBRICATION	FLUID	INTERVAL HRS
U-Joi nts	NGLI 2 ISO VG460	10
Bearings Flange	NGLI 2 ISO VG460	10

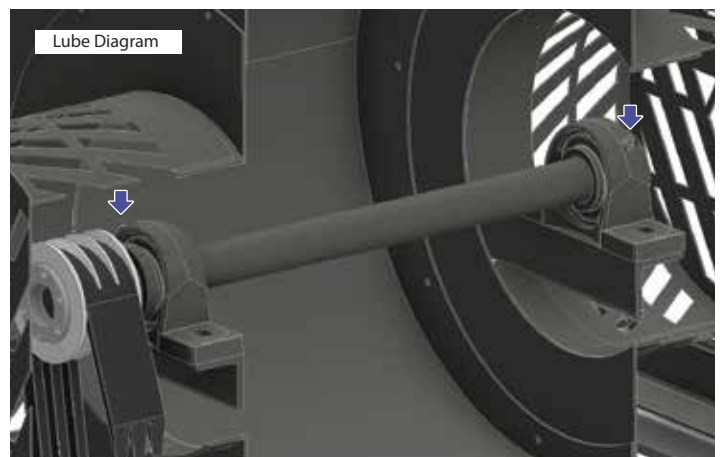

Lube Diagram

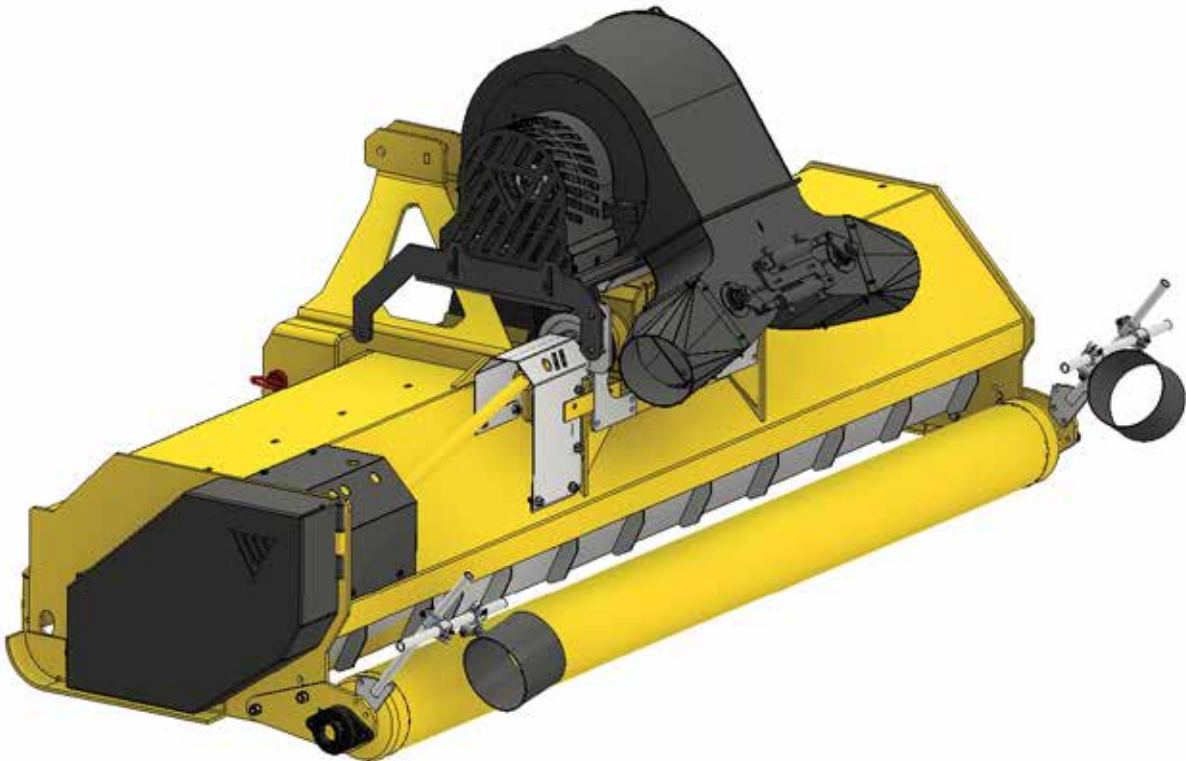

VALLEY TOOL

MANUFACTURING COMPANY

Order Parts Online
shop.valleytoolmfg.com

- Shop OEM Parts
- Fast Shipping
- Easy Checkout



QUESTIONS: Parts@Valleytoolmfg.com

Drive Detail

ITEM	DESCRIPTION	MODEL	PART NUMBER	QTY
1	SHEAVE B-SECTION	All	P-1462	1
2	BUSHING SH 1.5 QD	All	TL-1620	1
3	ADPTR HUB Z6	All	06043	1
4	BUSHING SK 1 13/16"	All	TL-1625	1
5	SHEAVE SK	All	P-1460	1
6	BELT 3BX-50	All	B-156A	1
7	LOCKING COLLAR 15/16" (NOT SHOWN)	All	C-194	1

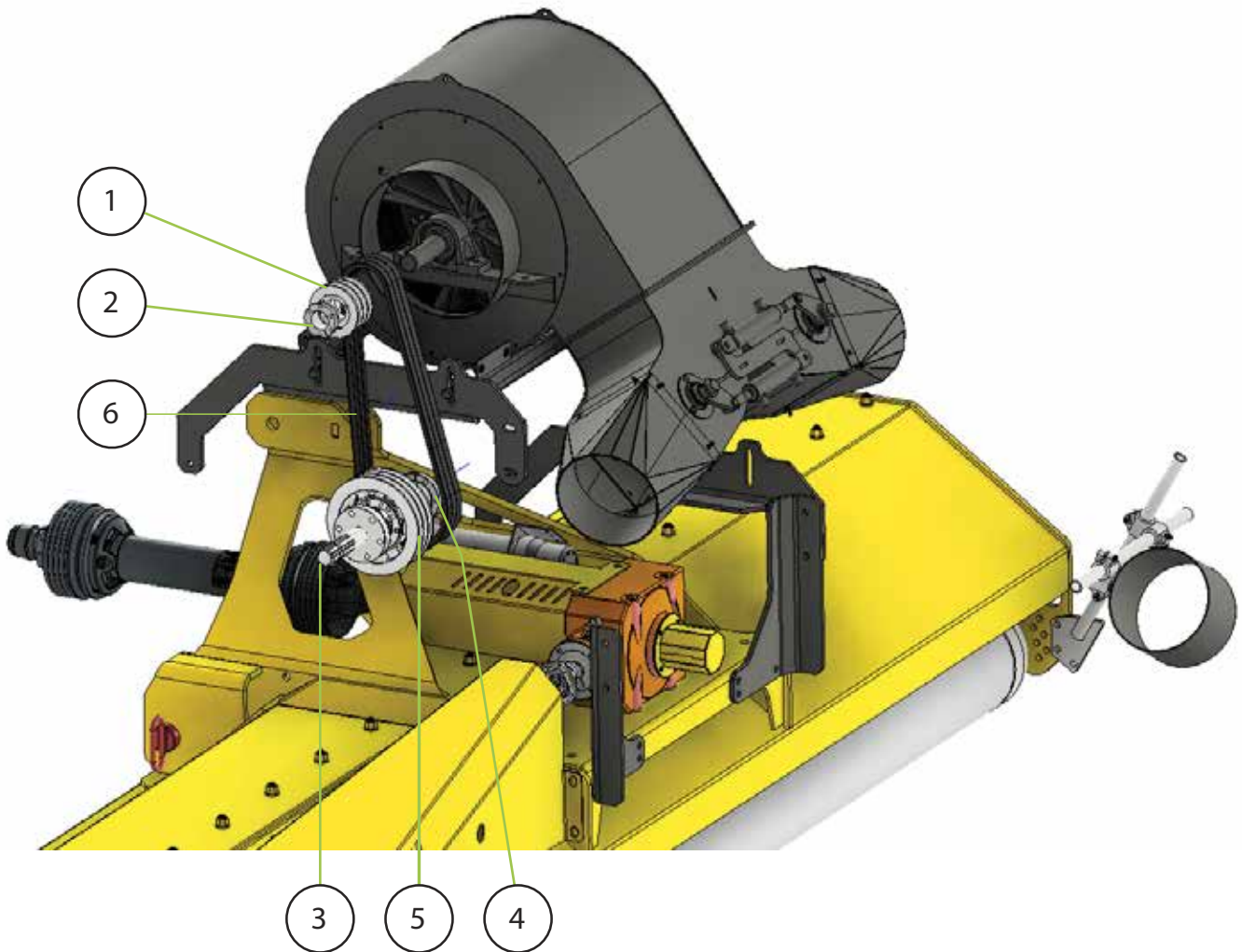

Blower Housing

ITEM	DESCRIPTION	MODEL	PART NUMBER	QTY
1	ASY WLDMT FAN BL24 V3	All	09847	1
2	BEARING 1.5 PILLOW BLOCK	All	50-BLSTBRG-150	2
3	12 CYL HYD HCI 4IN STRK	All	SPE1004-HC	1
4	SHAFT WELDMENT RH BUTTERFLY VALVE 8X8	All	05810	1
5	SHAFT WELDMENT LH BUTTERFLY VALVE 8X8	All	05815	1
6	OUTPUT DUCT 8X8 TO ROUND WELDMENT	All	05768	2
7	STAMPED FALNGE BEARING	All	50-BLSTRDOORBRG	4

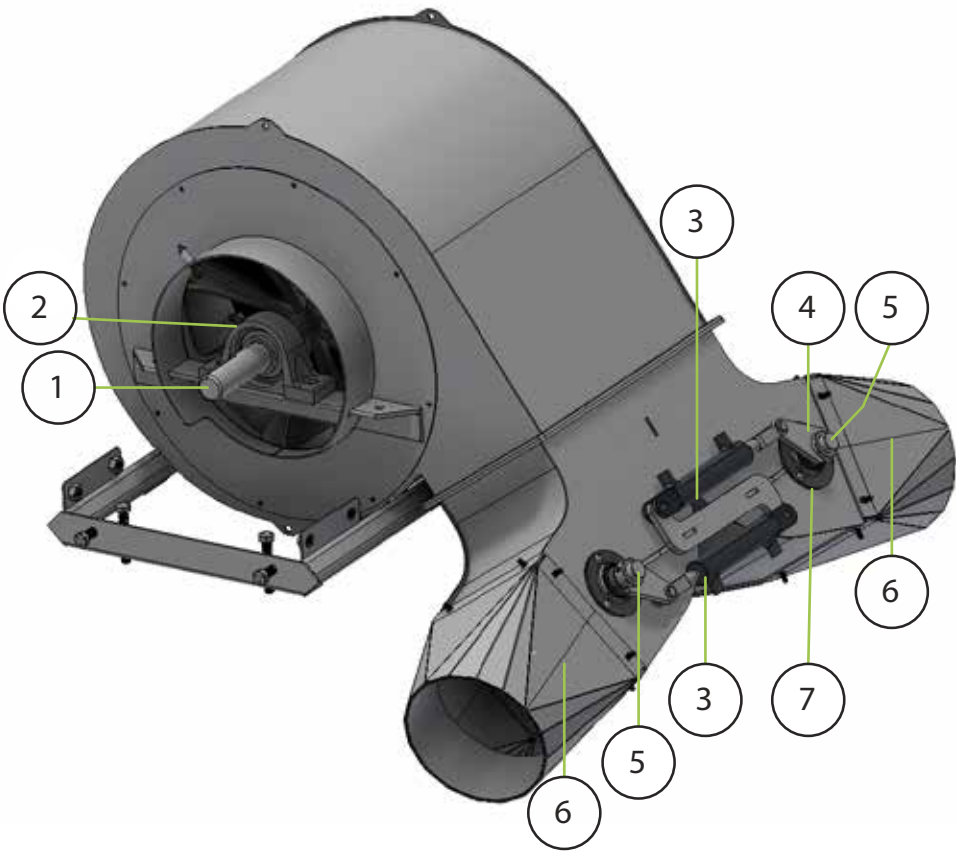

Control Valves

ITEM	DESCRIPTION	MODEL	PART NUMBER	QTY
1	SHAFT WELDMENT LH BUTTERFLY VALVE 8X8	All	05815	1
2	CYL HYD HCI 4IN STRK	All	SPEI004-HC	2
3	SHAFT WELDMENT RH BUTTERFLY VALVE 8X8	All	05810	1
4	STAMPED FALNGE BEARING	All	50-BLASTDOOTBRG	4
5	ASY BUTTERFLY VALVE WELDMENT	All	05809	2

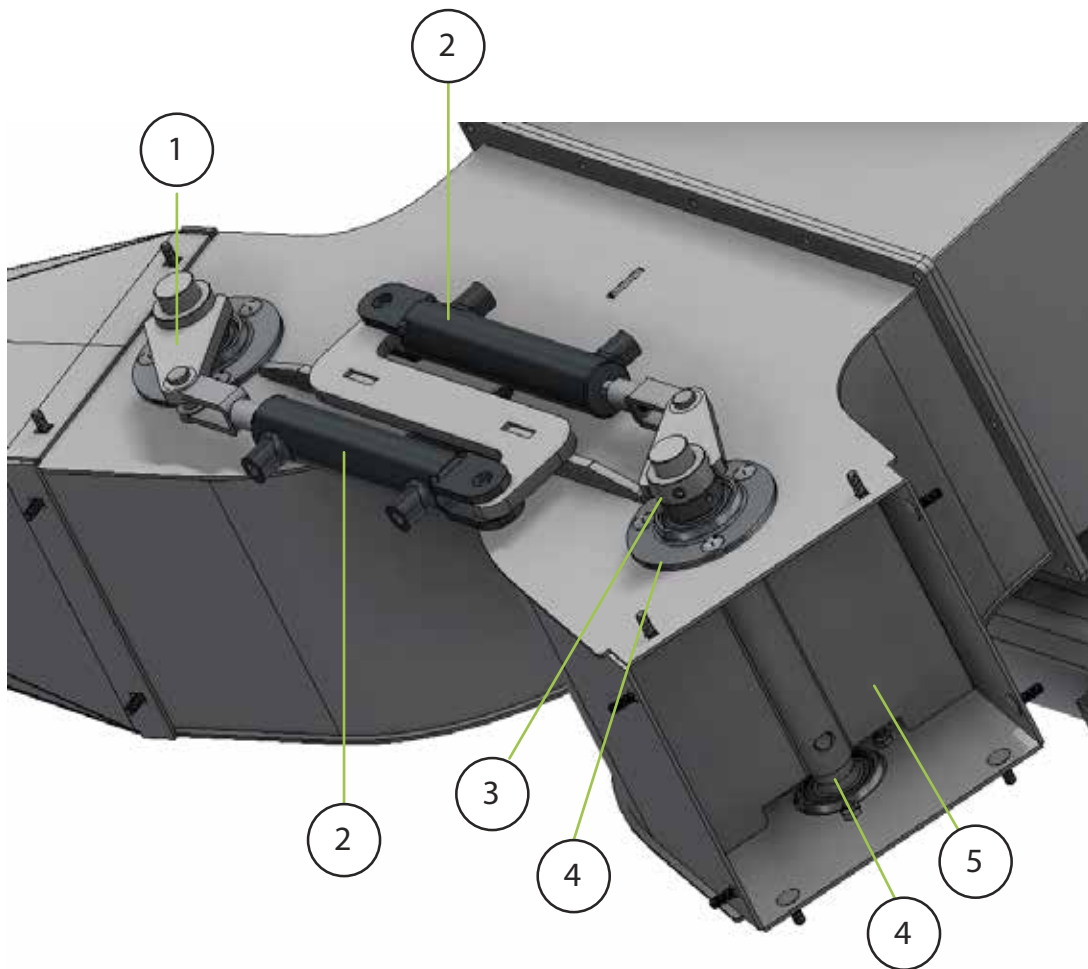

Sanitizer Install Left

ITEM	DESCRIPTION	MODEL	PART NUMBER	QTY
1	ASY GUARD WELDMENT INPUT	All	05952	1
2	BLOWER LH MOUNT PLATE	All	05824	1
3	NOZZLE MOUNT HORIZONTAL TUBE 1.0 OD	All	05782	2
4	FRAMING FTG XOVR THROUGH CONNECTOR	All	50-BLSTFLEX192	2
5	NOZZLE MOUNT VERTICAL TUBE WELDMENT	All	07205	2
6	OUTPUT NOZZLE 8IN WELDMENT	All	05781	2
7	GUARD TOP SHAFT FOR BERM BLOWER	SANITIZER	09475	1

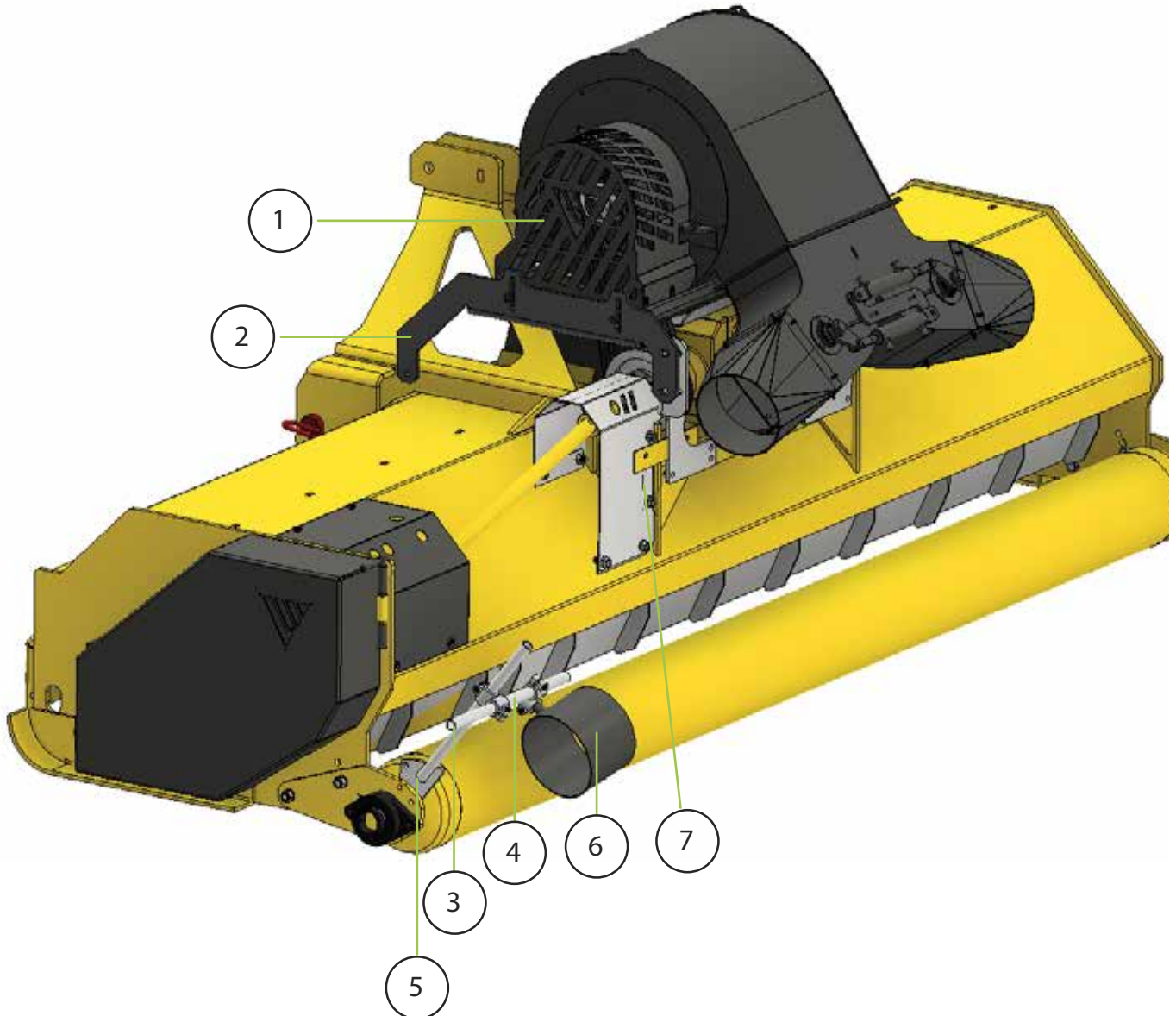

Sanitizer Install Right

ITEM	DESCRIPTION	MODEL	PART NUMBER	QTY
1	ASY IDLE GUARD LP BERM BLOWER	All	05947	1
2	BLOWER RH MOUNT PLATE	All	05826	1
3	FRAMING FTG XOVR THROUGH CONNECTOR	All	50-BLSTFLEX192	2
4	NOZZLE MOUNT HORIZONTAL TUBE 1.0 OD	All	05782	2
5	OUTPUT NOZZLE 8IN WELDMNT	All	05781	2
6	NOZZLE MOUNT VERTICAL TUBE WELDMNT	All	07205	2

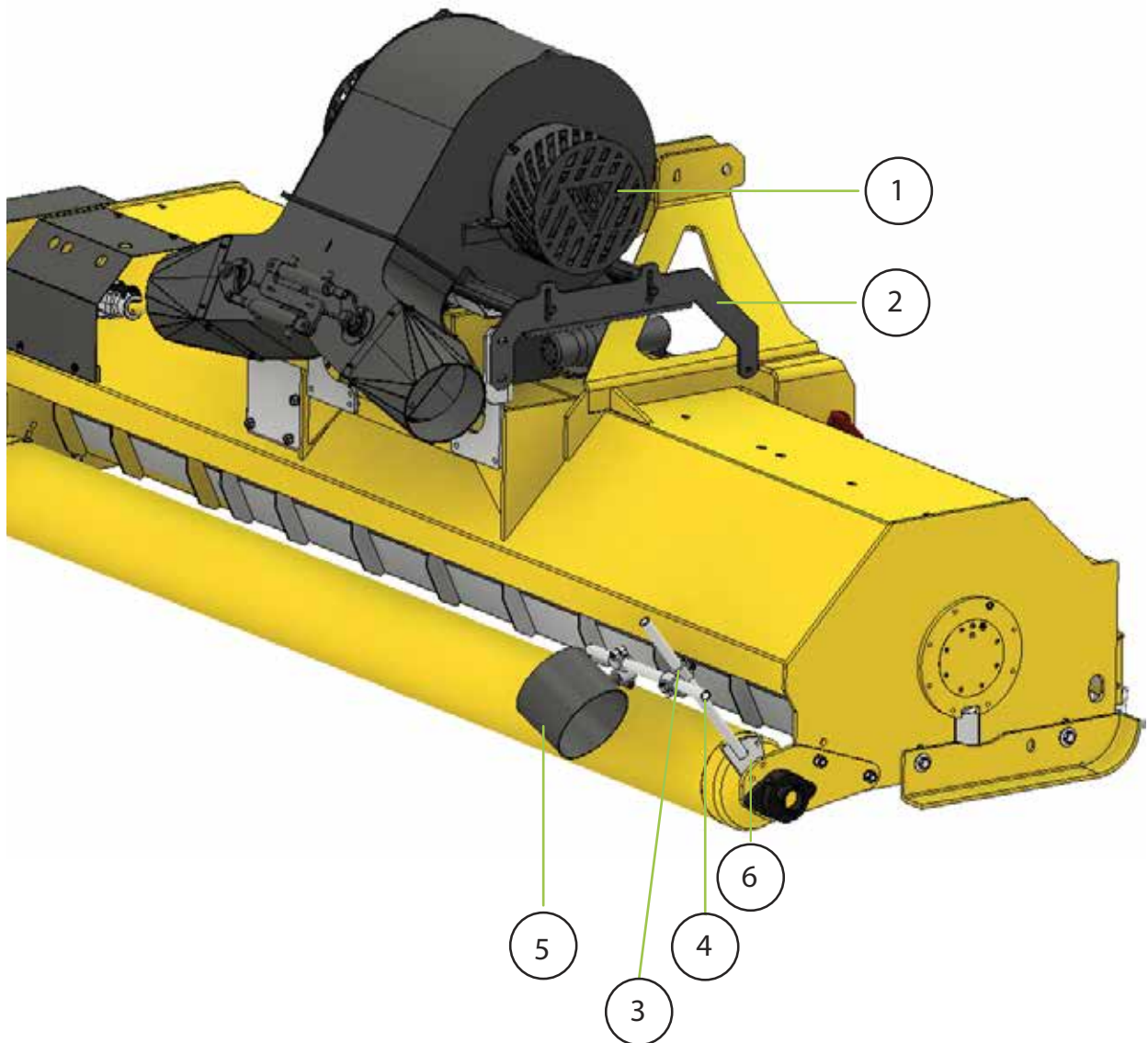

Decals

ITEM	DESCRIPTION	MODEL	PART NUMBER	QTY
1	VRISIMO LOGO SM	All	DC-119	1
2	READ BEFORE OPERATING	All	DC-220	1
3	GREASE 10 HOURS	All	DC-236	2
4	CAUTION MOVING PARTS	All	DC-268	1



BL-Series Orchard Blower
Owner's Manual
REV251023



BL-SERIES ORCHARD BLOWER OWNER'S MANUAL



VALLEY TOOL
MANUFACTURING COMPANY

PO Box 220 | 2507 Tully Road | Hughson, CA 95326 | 800-426-5615
www.valleytoolmfg.com