

MiniMax Flail Mower  
Owner's Manual

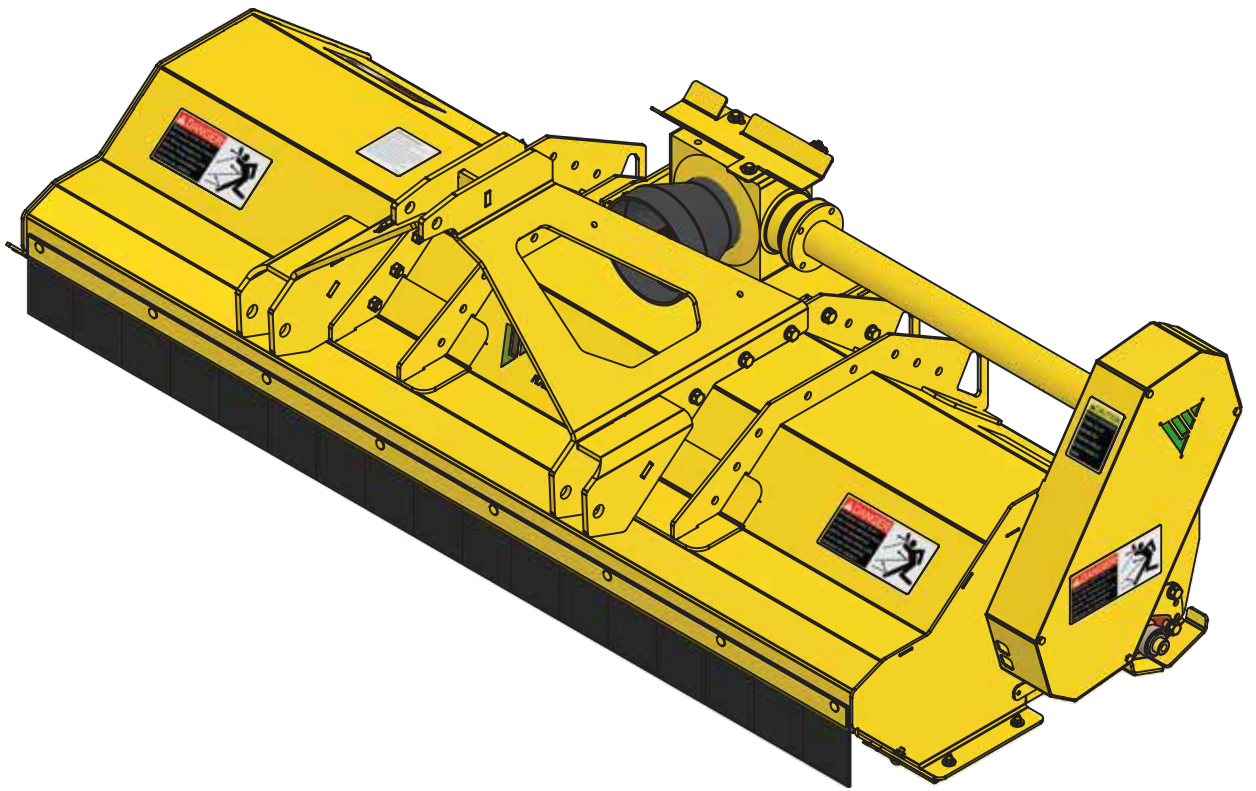

MINIMAX OWNER'S MANUAL



**VALLEY TOOL**  
MANUFACTURING COMPANY

PO Box 220 | 2507 Tully Road | Hughson, CA 95326 | 800-426-5615  
[www.valleytoolmfg.com](http://www.valleytoolmfg.com)



## Table of Contents

<b>Introduction</b>	
Thank You	1
Warranty	2
<b>Safety</b>	
Operational Safety	3
Maintenance Safety	4
<b>Basic Operation</b>	
Attaching to Power Unit/Starting Procedure	5
Running the Attachment/Shut Down	6
<b>Adjustments &amp; Maintenance</b>	
Cut Adjustments/Wear Components	7-8
Lubrication	9
<b>Transport</b>	
Transport/Removal/Storage	10
<b>Frequently Asked Questions</b>	
Frequently Asked Questions	11
<b>Parts Book</b>	
Base Assembly 72	13-15
Idle Pulley Assembly	17
PTO Shaft Assembly	18
Gearbox Assembly	19
Torque Specifications	20
Decals	21

# Thank You

---

Dear Customer,

We appreciate your purchase of a Vrisimo attachment. The purpose of this manual is to familiarize you with the operation, adjustment, and maintenance of your new attachment. It was meticulously designed and constructed in accordance with the highest industry standards to provide you with years of dependable service. Before endeavoring to operate the machine, you must read this manual thoroughly and comprehend its operation. Vrisimo reserves the right to make modifications to design and specifications, as well as additions and enhancements to its product, without incurring any obligation to retrofit previously manufactured items. If you ever require additional information, please contact your authorized dealer or customer service.



PO Box 220 | 2507 Tully Road | Hughson, CA 95326

1-800-426-5615

[www.valleytoolmfg.com](http://www.valleytoolmfg.com)

Vrisimo designed this attachment with operator safety as one of its primary considerations. This attachment was designed with shielding, simple adjustments, and other safety features whenever practicable. Ensure that you and your employees read and comprehend this manual. Only responsible individuals who have been trained to operate in a secure manner and who have read and comprehend this manual should operate any machinery.

***Before accepting the equipment, verify the pre-delivery checklist thoroughly with the sales representative. See pg.5***

***Ensure that you have a comprehensive understanding of the operation, adjustment, and safety principles outlines in this manual.***

Vrisimo Attachments is solely owned by Valley Tool and Manufacturing.

Visit: [www.valleytoolmfg.com](http://www.valleytoolmfg.com)

***Product Registration***



Valley Tool & Mfg. warrants each product to be free of manufacturing defects for a period of twelve months (ninety days for rental units) from the date of delivery to the original user/owner, subject to the limitations stated in this policy.

This warranty does not apply to defects caused in whole or in part by unreasonable use while the product is in the user's possession, including but not limited to: failure to properly set up product; failure to provide reasonable and necessary maintenance; normal wear; routine tune-ups or adjustments; improper handling or accidents; operation at speed or load conditions contrary to published specifications; improper or insufficient lubrication; improper storage. This warranty also does not guarantee that the efficacy of every product will meet the purchaser's expectations.

Valley Tool & Mfg. shall not be liable for consequential damages of any kind, including, but not limited to, consequential labor costs or transportation charges associated with the replacement or repair of defective parts; lost time or expenses incurred as a result of said defects. Valley Tool & Mfg.'s total liability is limited to the purchase price of the product.

Valley Tool & Mfg. provides no warranty for trade accessories or any component or accessory of the product that was not manufactured by Valley Tool & Mfg., including any purchased components. These are subject to the respective manufacturer's warranties. If the product or any part of the product is modified or repaired in any manner not expressly authorized by Valley Tool & Mfg., or if closed components are disassembled prior to return, the warranty will be void. Closed components include gearboxes, hydraulic pumps, motors, cylinders, and actuators, among others.

Our obligation under the warranty is expressly limited, at our option, to the replacement or repair at Valley Tool & Mfg., of Hughson, California, or at a service facility specified by us, of the defective part or parts as determined by inspection.

We are not liable for unauthorized replacements or repairs. Warranty pre-approval is required. Authorized supplies will be sent to the dealer at no cost via UPS Ground. The duration of any implied or statutory warranties, such as warranties of merchantability or fitness for a particular purpose, is expressly limited to the duration of this written warranty. No one is authorized to make any other express or implied warranties on our behalf. This warranty cannot be extended, expanded, or altered unless authorized in writing by Valley Tool & Mfg. No warranty will be processed without a timely, signed "Product Registration"

The attachment owner is responsible for the travel time of mechanics and conveyance of the product to the authorized service dealer for warranty work.

The most reasonable and dealer-friendly return policy on the market is provided by Valley Tool & Mfg. The return policies for each of our brands are listed below. We accept returns within 30 days of the date of original shipment. Prior to return shipment, all returns must be approved by Valley Tool & Mfg, and a return authorization number must be issued. Returns must be in "like-new" condition and accompanied by all original factory packaging, including instruction manuals. If an item is received that is not in "like-new" condition or in its original packaging, additional fees will apply. After our staff has completed a thorough inspection of a return, refunds will be issued less shipping fees and any other potential damage fees. Please allow up to 30 business days for the processing of your account refund credit.

Please direct all return-related questions to [sales@valleytoolmfg.com](mailto:sales@valleytoolmfg.com).

# Safety

Safety messages are provided in this manual to describe possible risk during operation, maintenance and transportation. These messages are intended to convey known hazards but cannot be construed to describe all possible risks.

Signal words in Safety Messages:

## DANGER

Danger: Indicates immediate risk of serious injury or death.

## WARNING

Warning: Indicates possibility of serious injury or death.

## CAUTION

Caution: Indicates possibility of minor injury.

## NOTICE

Notice: Indicates possibility of property damage, possible machine failure but no immediate risk to

Failure to heed any of these warnings may result in personal injury or death.

## Operational Safety

Before operating this machinery read the owner's manual thoroughly. Properly train all Operators. It is the Owner's responsibility to ensure all Operators are properly trained in the appropriate language. Use OSHA approved eye, ear and head protection to protect the Operator from flying debris and noise. Never use drugs or alcohol before or during operation of this machine. Only operate this machine when it is in good working order on an appropriate power unit that is in good working order, and with all guards and safety devices in place and functioning. Never allow children or other people to ride on this machine.

## DANGER

Keep bystanders and children of the clear work area during operation as debris can be discharged and cause serious injury or death. Maintain a minimum distance of 300 ft.

## DANGER



**Keep Safe Distance**

DC-363

## DANGER

Risk of death or injury if moving parts are touched, or are brought into contact with any person. Keep away from all moving parts. Keep guards in place while operating.

Operate only with clear visibility, never in dusty, foggy conditions or at night. Risk of collision or contact with personnel. Crushing, piercing or cutting hazard.



## WARNING

Avoid operation that would allow hydraulic lines to be pinched or severed. In the event of a hydraulic leak, hydraulic fluid may have sufficient force to penetrate skin. Do not use any body part to check for leaks. High pressure oil can cause severe injury or death.

Disengage hydraulics, shut off engine and allow all movement to stop before leaving the operator's position to adjust, lubricate, clean or unclog the machine. Do not try to uncouple hydraulic hoses unless the pressure has adequately dissipated.

Risk of serious injury or death due to thrown debris or broken knives. Do not operate closer than 300 ft to people, unprotected roadways or public areas without properly securing or warning protecting against accidental ingress. Risk of fire due to knife contact with stones, concrete, steel or other hard objects. Sparks can ignite dry grass, wood chips or other flammable material. Do not operate in dry grass, severe fire risk areas or in an area actively burning or recently burned. Consult local requirements around operation during Fire Weather Watch or Red Flag Warning conditions.

## CAUTION

Rotating parts, Hydraulic hoses, motors and valves generate heat when operating. Do not touch when hot. Allow to cool before maintaining.

Risk of crushing, pinching or cutting due to motion of machine while maintaining. Ensure all energy is dissipated from hydraulic lines before maintaining. Secure power unit and attachment against motion with wheel chocks, or appropriately sized stands as required.

Remove key from power unit and read manual before maintaining. Risk of accidental motion if key is engaged on power unit. Knives wear parts and damaged components can have sharp edges that cause cuts or lacerations. Wear protective gear and handle these parts with care.

## CAUTION



**Keep Guards In Place**

DC-296

# Basic Operation

---

## Attaching to the Power Unit

### Pre-Delivery Checklist

- Check all nuts and bolts for correct torque.
- Check for shipping damage. If damaged, do not use the attachment until parts have been replaced or repaired.
- Check that all hydraulic hoses and fittings are tight.
- Check that all warning signs (decals) and safety treads are on the attachment and in their correct location. Replace any damaged signs or safety treads.

## NOTICE

Only trained operators should attach the MiniMax. Perform the attachment on flat, clear ground. Keep hands clear of pinch points and blades. Set the tractor's draw bar to its shortest position or remove it if needed. For tractors with load and depth control, use the "free float" setting.

- Back the tractor up to the front of the machine so that the lift links are in line with mower's hitch pins.
- Shut off the engine and disengage the PTO. Block the tractor's wheels before any person goes between the tractor and the attachment.
- Attach the tractor's left and right links to the corresponding hitch pins of the attachment, securing both connections with lynch pins.
- Adjust the sway bars so that there is a minimum side slack and be sure the stabilizers are tight.
- Attach the tractor's top link to the "A" frame of the attachment and adjust the top link to the approximate desired cutting height.
- Attach the PTO to the tractor. The tube end goes to the attachment and the bar end goes to the tractor.
- With the attachment and PTO line connected, check the drive shaft through the entire lifting range checking for binding, bottoming, uncoupling or attachment contact

### Starting Procedure

The Operator should be properly trained on the use of your Vrisimo Attachment and wearing the appropriate safety gear. Do not start the Power Unit until the Attachment has been checked for proper assembly and installation. This includes the appropriate connection of the hitch and PTO connections as well as the proper functioning of all safety devices on both the Power Unit and the Attachment. Clear the work area of all bystanders and children:

- Check that the attachment is in the down position and the blades are not in contact with ground. Start engine and set throttle to idle. Never engage the PTO with the motor above idle speed.
- With the motor at low RPM engage the PTO output.
- Slowly bring the throttle up to 540 PTO RPM. If the Attachment produces excessive vibration, disengage the PTO and shut down the Power Unit immediately. Determine the cause of the problem and correct it before continuing.
- Attachment is ready for operation.

# Basic Operation

## Running The Attachment

- Determine ground speed based on terrain and material being cut. This will typically fall within the 0-5 mph range.
- Position skid shoes between 1/2-3" off the ground; skid shoes are not meant to run on the ground.
- The mower and skid shoes should be level or angled slightly upward with the ground. The height of the mower can be adjusted with the back gauge roller.

## Shut Down Procedure

- Disengage the PTO drive and position it for storage or transport (See the "Transport, Removal, and Storage" Section for details on proper storage). Shut off Power Unit and set parking brake, wait for the attachment to stop rotating.
- Visually inspect the PTO shaft, all the bearings and gearbox for excessive heat or leaks.

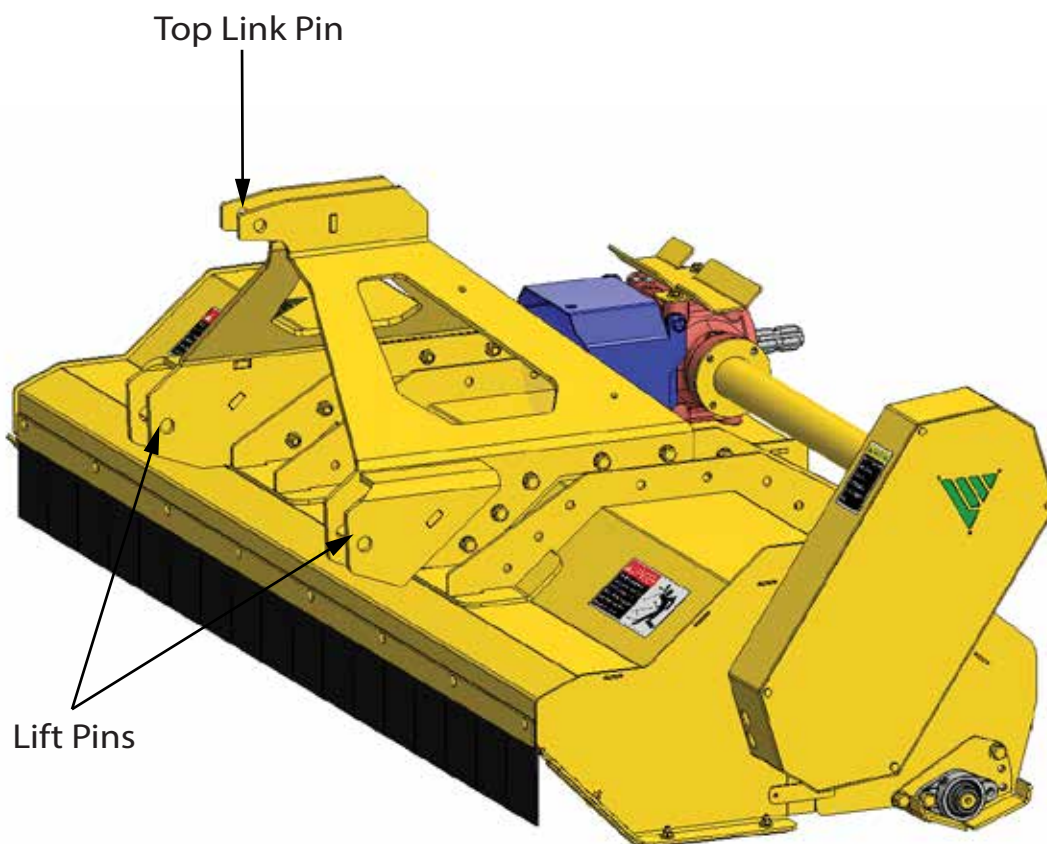

# Adjustments & Maintenance

## NOTICE

Before performing maintenance, ensure all motion has stopped and that the Power Unit is powered down with ignition key removed. Before working on or underneath the mower, place blocks on both sides of the Power Unit's tires and underneath both ends of the mower to prevent accidental lowering of the machine.

### Cut Height Adjustments

- The cutting height of the mower can be adjusted from 0-4". Adjusting is done by shortening or lengthening the top-link. Under no circumstances should the knives contact the ground.
- The entire weight of the mower should be on the back gauge roller. The skid shoes should be adjusted so there is 1/2"-3" clearance between them and the ground. The shoes are for added protection against tree roots, ridges or borders and are not designed to slide on the ground. Adjust the back gauge roller by removing the bolts from both sides and setting it to the correct height.

### Wear Components

Wear components such as knives, belts and bearings may wear at different rates and so each should be inspected for wear independently.

- Knives should be replaced when they are dull.
- When individual knives, bolts or spacers become worn or damaged they must be replaced with hardware saved from your previous knife replacement. Replacing an individual station with new hardware could cause the cutter drum to run out of balance. When replacing hardware at all the stations, some old hardware should be saved to replace future broken hardware.

- Replacing the knives is done by disconnecting the mower and tipping it up on its front or rear end to gain access to the underside of the mower. Knives are individually removed by unbolting them from their connecting ears.

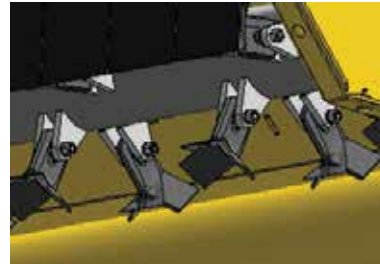

- Skid shoes should be replaced as needed.
- Belt adjustment is done by adjusting the tension arm.

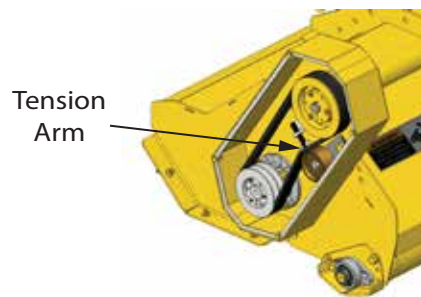

### Cleaning Your Mower

- Check for excessive grease in bearing areas on the pulley side of the mower. Make sure that grease is not allowed to get into the belt areas.
- Clean any clippings from the gearbox areas on the pulley side of the mower. Make sure that grease is not allowed to get into the belt areas.
- Clean the inside of the mower with a pressure washer. Make sure the inside of the mower is kept free from mud and compact grass. Keep in mind that mud built up on the cutter drum can cause imbalance.
- Preserve damaged decals or replace them if they are unreadable. Decal kits can be obtained from your local Vrisimo dealer.

# Adjustments & Maintenance

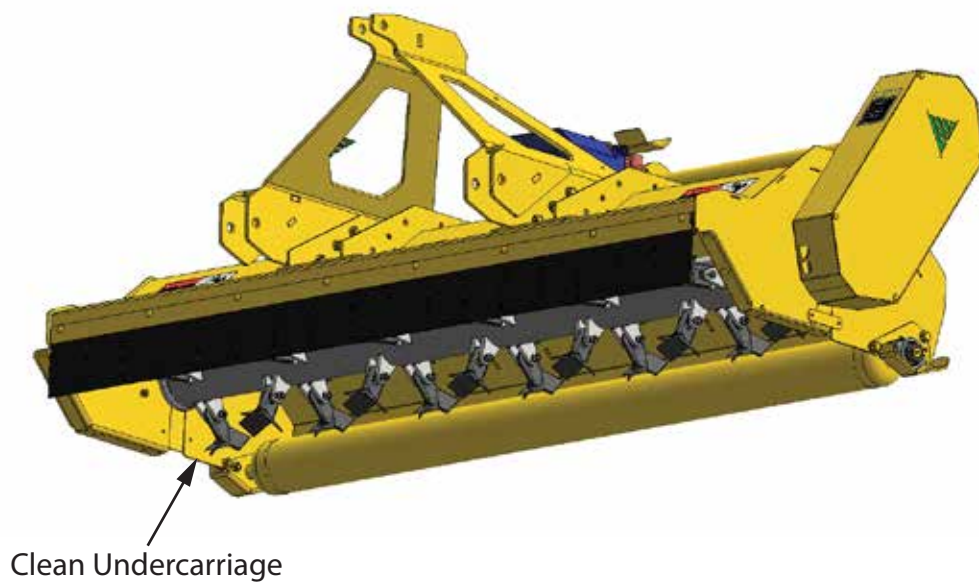
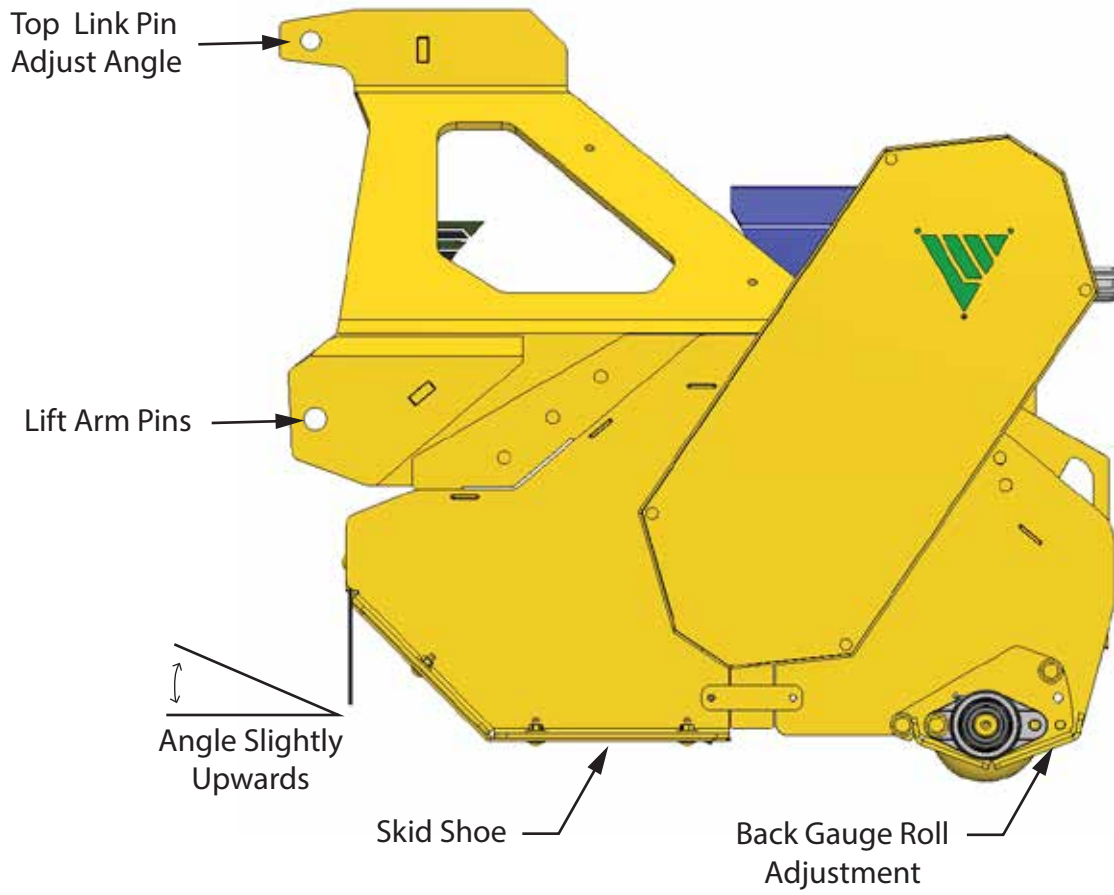

# Adjustments & Maintenance

## Lubrication

### Cutter Drum

- There are two Grease zerk fitting to lubricate per bearing housing. There is an outer and inner zerk on each side of the mower.
- Valley Tool recommends greasing with **NLGI 2 ISO VG100**, any lithium based NLGI Grade 2 grease that is ISO 100 VG and of high quality will work. DO NOT use grease designed for tractor pins and bushings.
- The CD-3001 is factory assembled with grease for over 300 hours of operation, and only required 6 pumps of grease every 300 hours of operation. Use of a pneumatic grease guns is not recommended as it is difficult to control the amount of grease being applied. While it is not necessary to “run-in” the bearing with each grease interval, if an excessive amount of grease has been applied the risk of failure can be mitigated by allowing the bearing another “run-in” period.

### Back Roller

The Back roller uses a four bolt flange style bearing. There is one on either side of the back roller. Grease daily as the back roller is exposed to the most debris,

The back roller bearing use **NLGI 1.5 ISO VG460** grease and should be grease after each time used. Depending on conditions back roller bearings may require more or less grease.

LUBRICATION	FLUID	HRS
Top Shaft Bearings	NLGI 1.5 ISO VG460	10
Backroll Bearings	NLGI 1.5 ISO VG460	10
Driveshaft Yokes	NLGI 1.5 ISO VG460	10
Driveshaft Slides	NLGI 1.5 ISO VG460	10
Cutter Drum Bearing	NLGI 2 ISO VG100	50
Gearbox	SAE 80W-90	300

### Top Shaft

- All top shaft bearings and yokes need to be greased weekly with **NLGI 1.5 ISO VG460**.

### PTO

- Greased daily as the PTO shaft can be over greased. PTO shaft and tractor can be damaged if run dry. PTO shaft will bind up and not telescope in and out properly.
- The PTO shaft should be grease with any standard grease as long as it is **NLGI 1.5 ISO VG460**.

### Gearbox

- Check gearbox oil level periodically and refill as required. Replace gearbox oil every 300 hours.
- Use quality oil level periodically and refill as required. Replace gearbox oil every 300 hours.
- Use quality **SAE 80W-90** gear oil. Be sure gearbox is in level position and remove side plug. See FAQ.

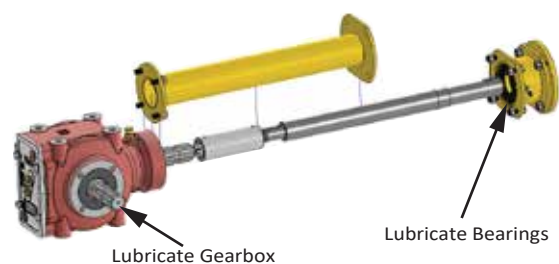

# Transport, Removal, and Storage

## Transport, Removal, Storage

Disengage PTO and shut off engine allowing all movement to stop before leaving the operators position to adjust, lubricate, clean or unclog the machine. Before working on or underneath the mower, place blocks on both sides (front and rear) of tractor tires and under each end of the machine. Also remove the ignition key from the tractor and allow all movement to stop before beginning work.

## Transport on Power Unit

- Chain down attachment even if unit is still attached to tractor, secure PTO shaft.
- Remove the adjustable top link from the tractor and mower.
- Disconnect the drive shaft from the tractor and mower.
- Remove the safety pins from the lower two link points. Remove the tractor ams from pin locations and re-insert the pins for storage.

## Storage

- Put the drive shaft away in a clean, dry place
- Clean the mower thoroughly (See the "Cleaning Your Mower" Section for details).
- Relax belt tension (See the "Adjustments & Maintenance" section for details).
- Lubricate the mower as recommended (See the "Lubrication" section for details).
- Check oil level in gearbox and fill as required (See the "Lubrication" section for details).
- Check for worn parts and replace so you will be ready to mow when necessary (See the "Adjustments & Maintenance" section for details).
- Store in a clean, dry place.

Transport

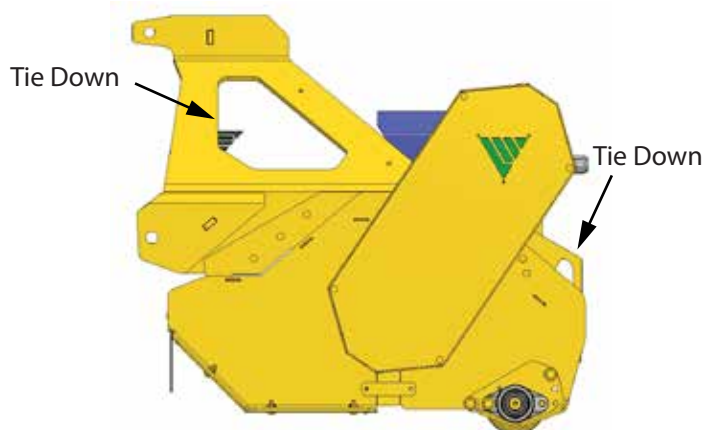

Belt Tension

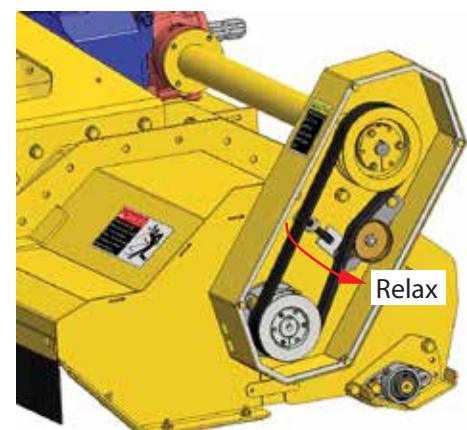

# Frequently Asked Questions

---

## Questions & Answers

Q. Where are replacement parts sold?

A. Check local dealer or ask to order from Valley Tool.

Q. How often knives be replaced?

A. When the cut begins to be inconsistent or rough, consider replacing the knives. It is recommended to keep an extra set of knives on hand to reduce downtime.

Q. How often should belts be replaced?

A. If your are experiencing repeated slipping or breaking of belts, increase belt tension. If this does not remedy the problem, replace the belt. Consider having an extra belt on hand.

Q. Do I need to fill the gearbox with oil before I use the mower?

A. No, the gearbox comes full with oil. Use 90 weight oil when replacing.

Q. What to do if belts are wearing out too fast or burning up?

A. Check belt tension (about 3/8" of deflection) and adjust as needed. If slipping continues, raise the cutting height and slow travel speed, especially when mowing grass over two feet tall.

Q. What to do if skid shoes are wearing out too fast?

A. Operate the mower with the side skid shoes 0.5-3" off the ground. The side skid shoes are meant to collide only with mounds or objects in the field. The rear roller is the only part of the mower that should touch the ground during operation.

Q. How to prevent PTO shaft from coming off during operation?

A. Make sure shaft id slid all the way on and the safety pin is in the locked position.

Q. When replacing gearbox oil, how much should be added.

A. Fill from the Upper-middle fitting and when oil begins to come out, the box is full.

Q. Are there any advantages to reversing cutter drum rotation?

A. Rotation type depends on the application. Normally, reverse rotation throws debris toward the tractor. Reversing rotation is only beneficial for industrial or front-mount use such as mowing near highways or in debris-heavy areas. It offers safety benefits rather than improved cutting quality.

Q. How do I replace my knives?

A. Replacing the knives may vary depending on your model of mower. See the Adjustments/Maintenance section for detailed information.

Q. When connecting the PTO shaft, can it go on either way or should a specific side go to the mower and the other to the tractor?

A. The PTO shafts for these mowers are side specific. The tube half of the PTO Shaft goes to the mower and the bar half of the PTO shaft goes to the tractor.

MiniMax Flail Mower  
Parts Book

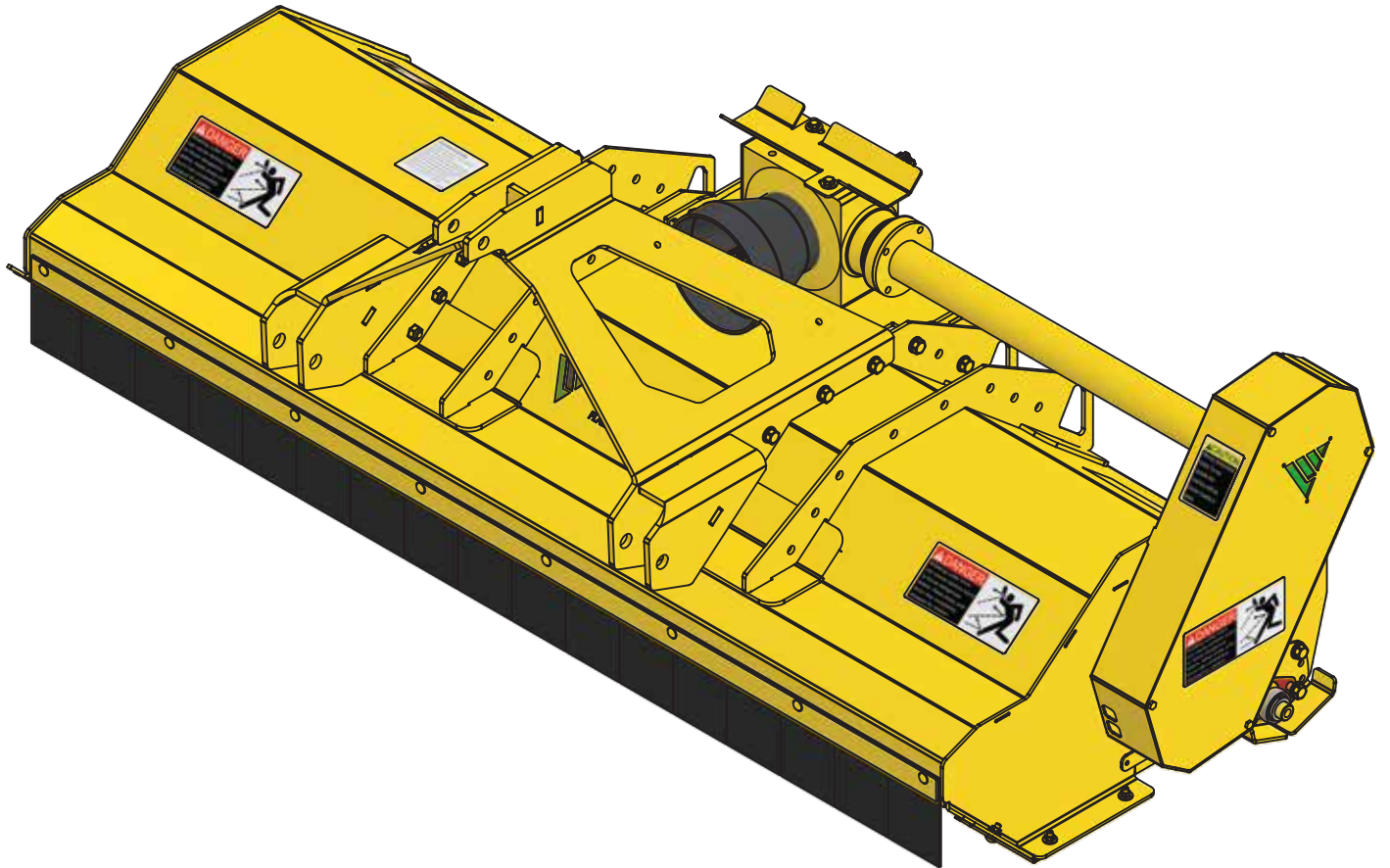

**VALLEY TOOL**

MANUFACTURING COMPANY

**Order Parts Online**  
[shop.valleytoolmfg.com](http://shop.valleytoolmfg.com)

- Shop OEM Parts
- Fast Shipping
- Easy Checkout

QUESTIONS: [Parts@Valleytoolmfg.com](mailto:Parts@Valleytoolmfg.com)



# Base Assembly 72

ITEM	DESCRIPTION	PART NUMBER	QTY
1	BACK ROLL MOUNT - LEFT	S-221	1
2	5/16-18 UNC 3/4" CARRIAGE BOLT	40185A581	14
3	RUBBER SKIRT 72	RB-72MM	1
	RUBBER SKIRT 48	RB-48MM	1
	RUBBER SKIRT 60	RB-60MM	1
4	PTO HOLDER	04170	1
5	BACK ROLL BEARING BR-110	BR-110	3
6	3:1 GEARBOX - 40 HP	BP-2600	1
7	A-FRAME HITCH	7P-240	1
8	BACK ROLL MOUNT - RIGHT (NOT SHOWN)	S-220	1
9	SLOT GUARD	04053	2

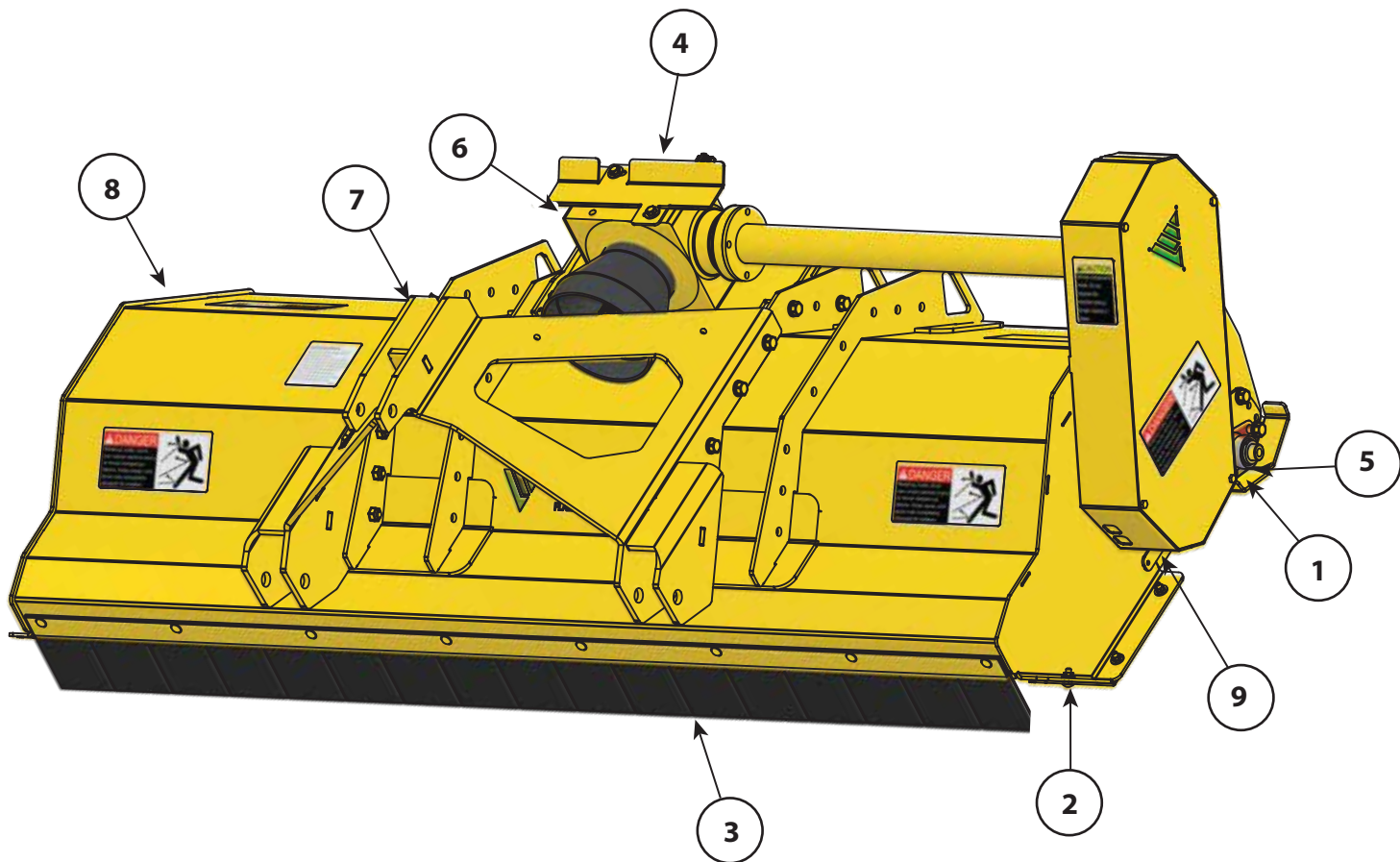

# Base Assembly 72

ITEM	DESCRIPTION	PART NUMBER	QTY
1	PLASTIC GUARD PTO	BP-2728	1
2	SKID SHOE (OPTIONAL)	S-72	2
3	BACK ROLL BEARING	BR-110	2
4	TOP SHAFT GUARD	04646	1
5	IDLE BEARING COVER	04024	1

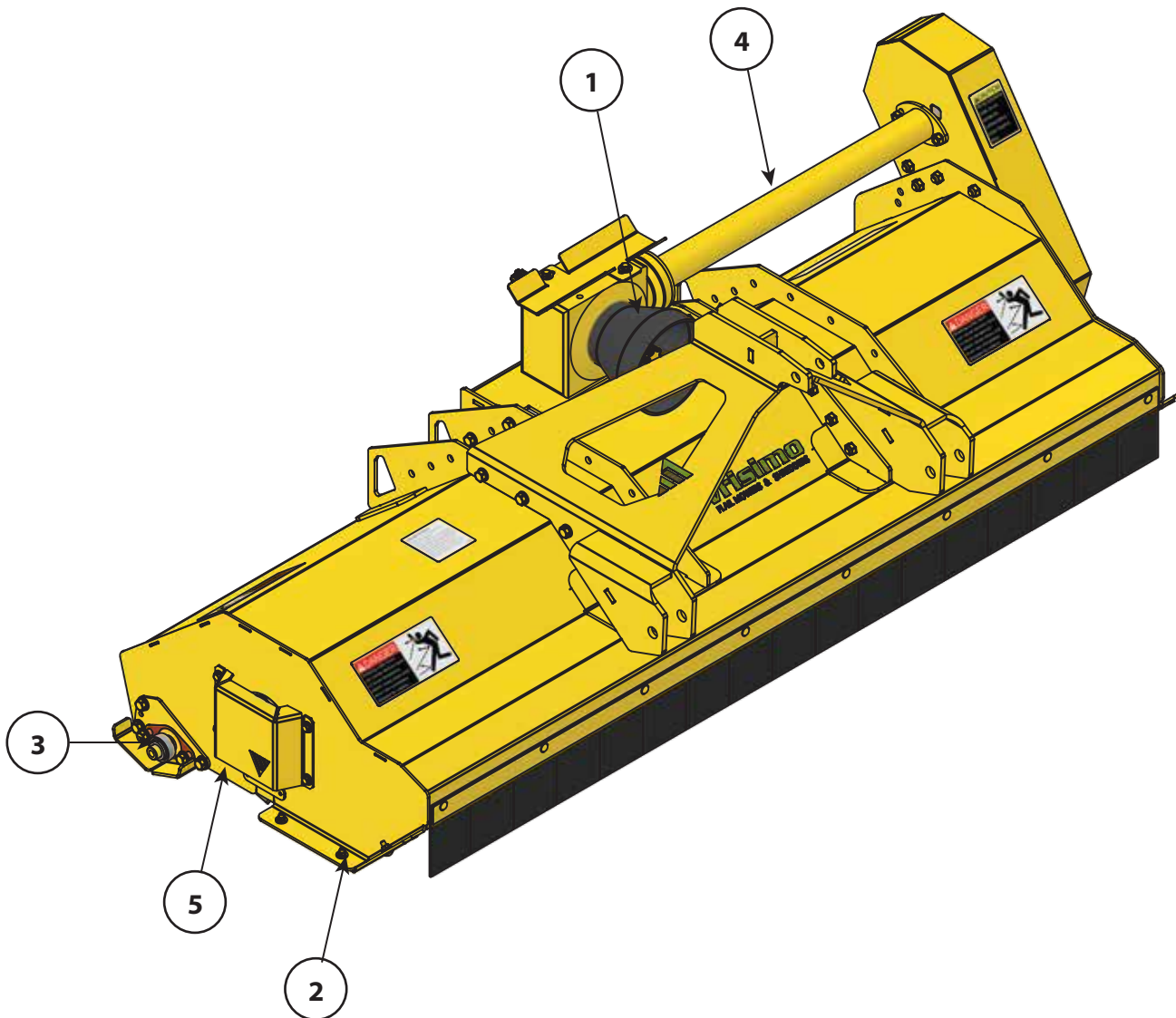

# Base Assembly 72

ITEM	DESCRIPTION	PART NUMBER	QTY
1	MINIMAX CUTTER DRUM BEARING	CD-3060	2
2	TOP SHAFT MM72	TS-1901	1
	TOP SHAFT MM48 (NOT SHOWN)	TS-1902	1
	TOP SHAFT MM60 (NOT SHOWN)	TS-1900	1
3	RUBBER SKIRT SUPPORT MM72 (PRICE/FT)	RB-1701	1
	RUBBER SKIRT SUPPORT MM48 (NOT SHOWN)	RB-1701	1
	RUBBER SKIRT SUPPORT MM60 (NOT SHOWN)	RB-1701	1
4	SHEAVE 2-GROOVE 2B44 SH	P-900	1
5	BUSHING 1-7/16" SH	TL-902	1
6	PULLEY 2B56 SDS	P-123	1
7	1 IN SDS BUSHING	TL-139	1
8	SPINE COUPLER	TS-129	1
9	BELT B42	B42	2ea

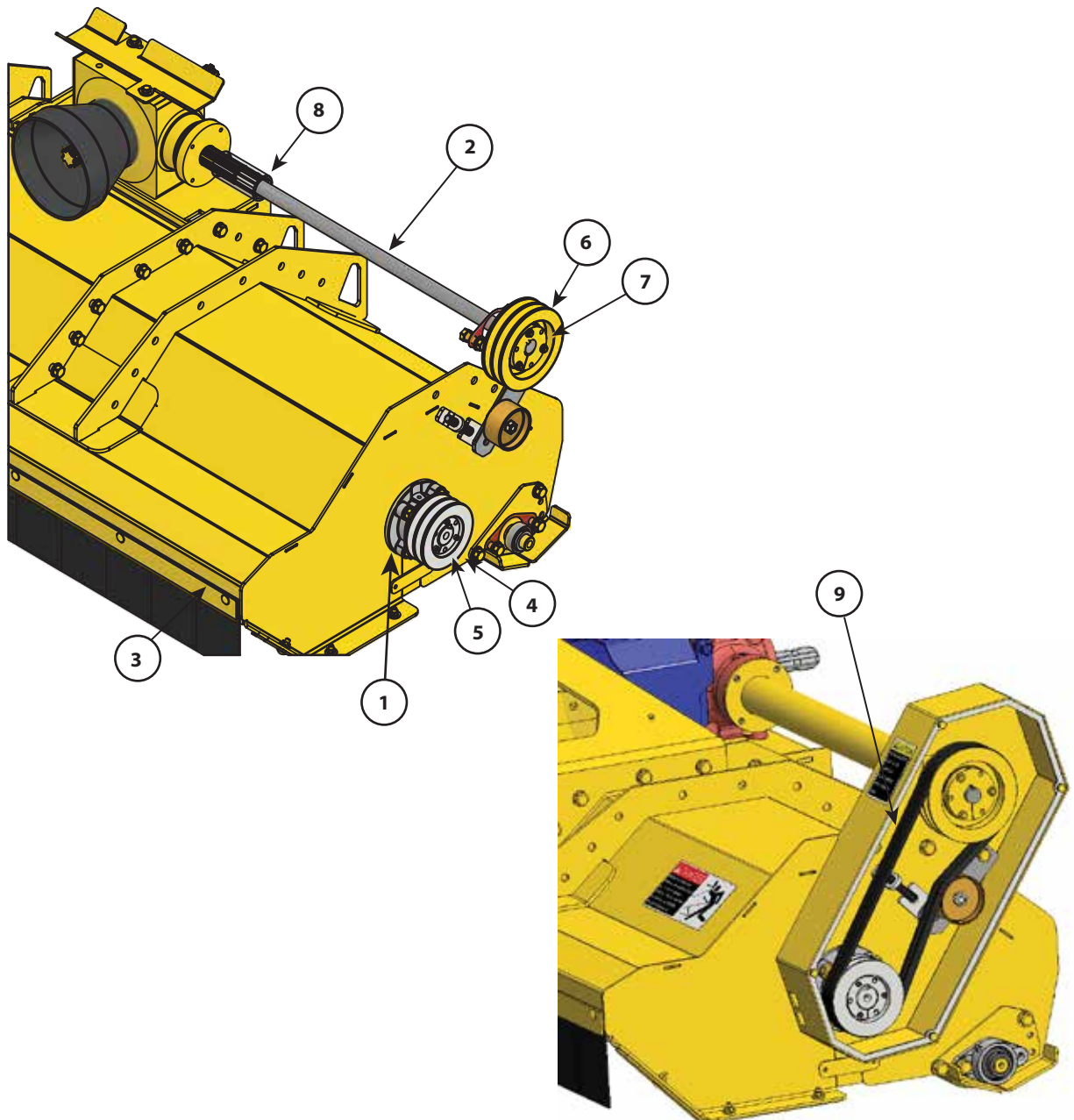

# Base Assembly 72

ITEM	DESCRIPTION	PART NUMBER	QTY
1	MINIMAX CUTTER DRUM BEARING	BR-172	1
	TOP SHAFT MM72	BR-148	1
	TOP SHAFT MM48 (NOT SHOWN)	BR-160	1
2	TOP SHAFT MM60 (NOT SHOWN)	S-221	1
3	RUBBER SKIRT SUPPORT MM72 (PRICE/FT)	S-220	1
4	RUBBER SKIRT SUPPORT MM48 (NOT SHOWN)	04025	2
5	RUBBER SKIRT SUPPORT MM60 (NOT SHOWN)		1
	SHEAVE 2-GROOVE 2B44 SH	P-900	1
	BUSHING 1-7/16" SH	TL-902	1

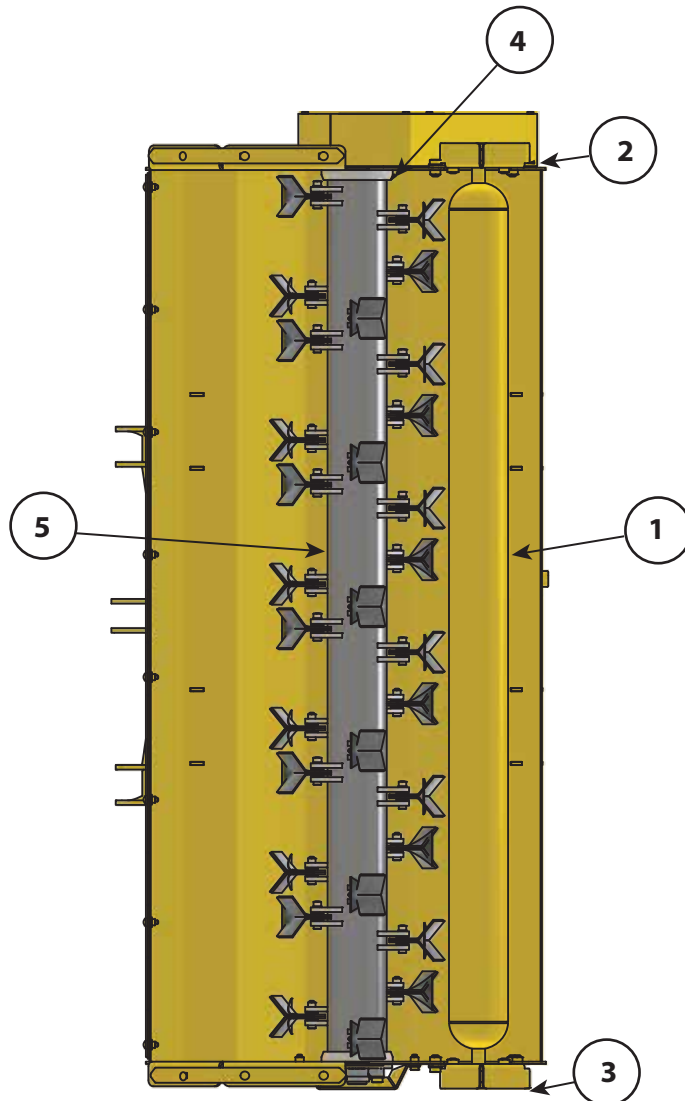

# Idle Pulley Assembly

ITEM	DESCRIPTION	PART NUMBER	QTY
1	MINIMAX IDLER ARM	IP-125	1
2	IDLE PULLEY 3"	IP-525	1

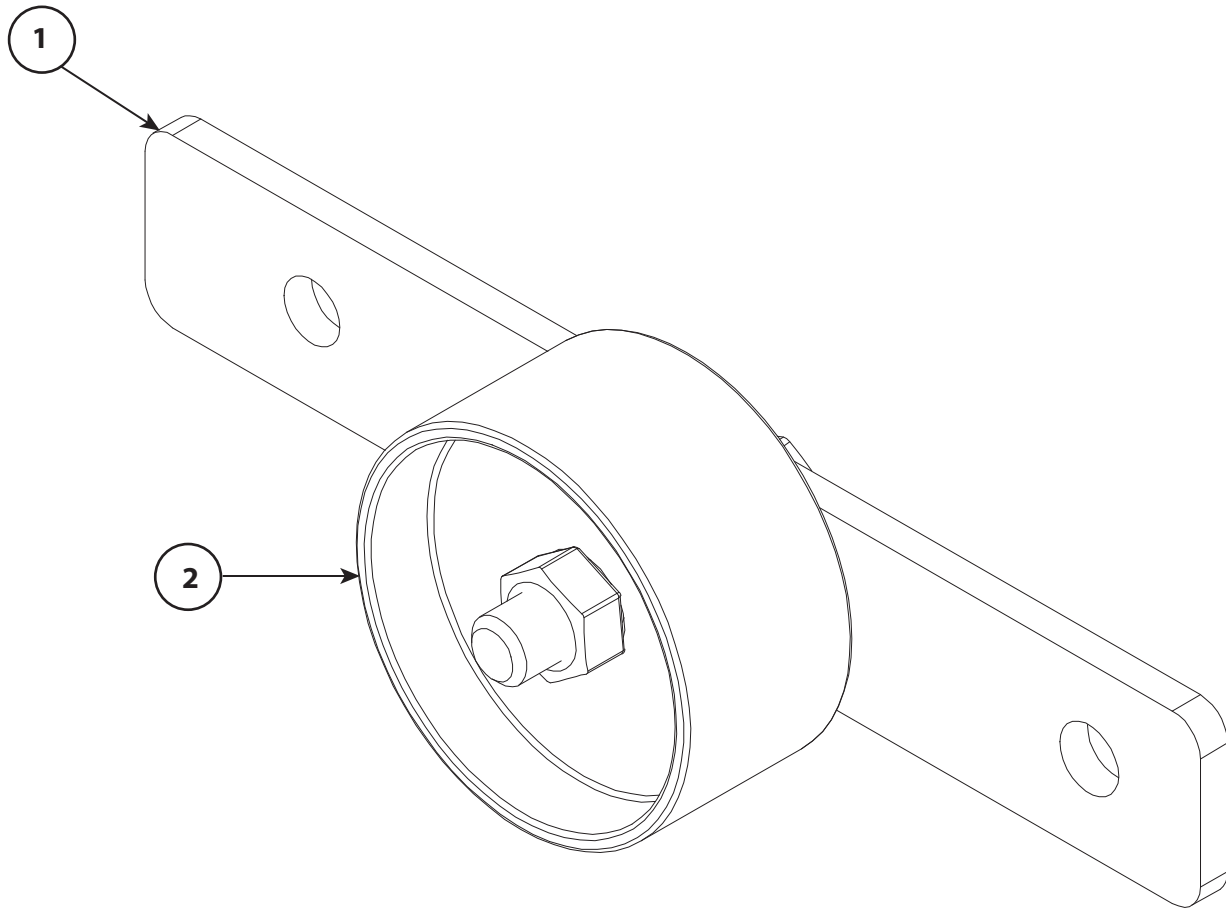

# PTO Shaft Assembly

ITEM	DESCRIPTION	PART NUMBER
1	YOKE	DS-151
2	CROSS KITS	DS-152
3	YOKE	DS-153
4	ROLL PIN	DS-154
5	CARDAN TUBE	DS-155
6	CARDAN TUBE	DS-156
7	ROLL PIN	DS-157
8	YOKE	DS-158
9	COMPLETE SHIELD KIT	DS-159
10	DRIVE LINE	DS-140

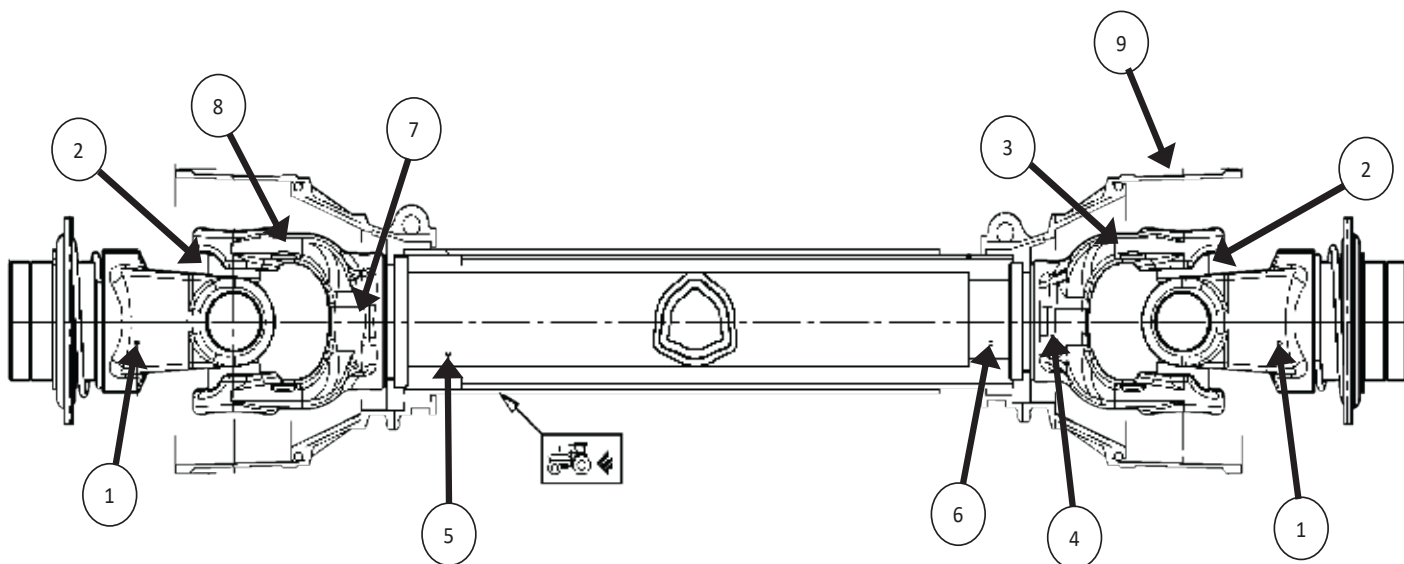

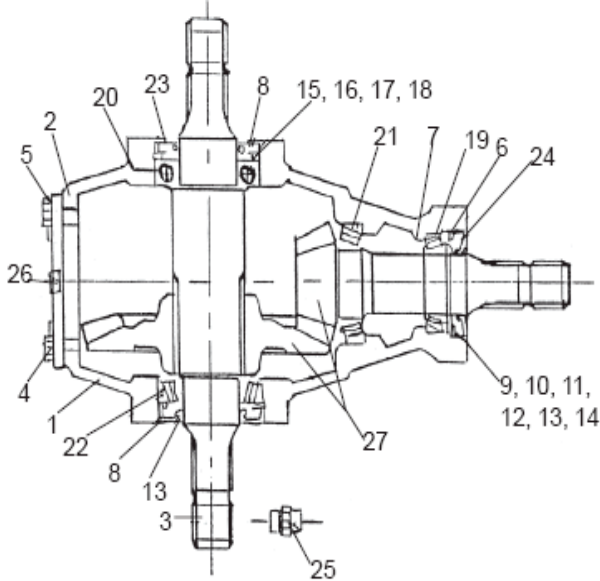

# Gearbox Assembly

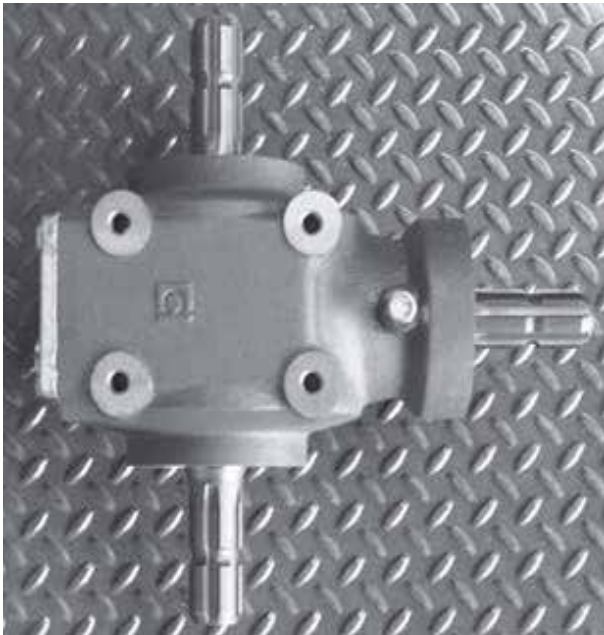

ITEM	DESCRIPTION	PART NUMBER	QTY
1	MAIN HOUSING	BP-2601	1
2	REAR COVER	BP2602	1
3	INPUT SHAFT	BP-2603	1
4	CAP SCREW	BP-2605	4
5	WASHER	BP-2606	4
6	SNAP RING	BP-2606	1
7	SNAP RING	BP-2607	2
8	SNAP RING	BP-2608	2
9	SHIM OUTPUT SHAFT 0.5MM	BP-2609	A/R
10	SHIM OUTPUT SHAFT 0.8MM	BP-2610	A/R
11	SHIM OUTPUT SHAFT 1.0MM	BP-2611	A/R
12	SHIM OUTPUT SHAFT 0.3MM	BP-2612	A/R
13	SHIM OUTPUT SHAFT 0.4MM	BP-2613	A/R
14	SHIM OUTPUT SHAFT 0.2MM	BP-2614	A/R
15	SHIM INPUT SHAFT 0.6MM	BP-2615	A/R
16	SHIM INPUT SHAFT 0.8MM	BP-2616	A/R
17	SHIM INPUT SHAFT 1.0MM	BP-2617	A/R
18	SHIM INPUT SHAFT 0.3MM	BP-2618	A/R
19	BALL BEARING	BP-2620	1
20	BALL BEARING	BP-2621	1
21	TAPERED BEARING ASSEMBLY	BP-2622	1
22	TAPERED BEARING ASSEMBLY	BP-2623	1
23	OIL SEAL, INPUT SHAFT	BP-2624	2
24	OIL SEAL, OUTPUT SHAFT	BP-2725	1
25	BREATHER	BP-2730	1
26	OIL PLUG	BP-2726	4
27	RING AND PINION GEAR SET	BP-2627	1
28	COMPLETE GEARBOX ASSEMBLY	BP-2600	1



# Torque Specifications

Nominal Dia. (in)	Threads per inch	 SAE J429 Grade 5			 SAE J429 Grade 8			 Holo-Krome Grade 9	
		Tightening Torque			Tightening Torque			Tightening Torque	
		Ecoguard	K=0.15	K=0.20	Ecoguard	K=0.15	K=0.20	Ecoguard	
Unified Coarse Thread Series									
1/4	20	66 in-lbs	76 in-lbs	101 in-lbs	93 in-lbs	107 in-lbs	143 in-lbs	109 in-lbs	
5/16	18	136	157	209	192	221	295	225	
3/8	16	20 ft-lbs	23 ft-lbs	31 ft-lbs	28 ft-lbs	33 ft-lbs	44 ft-lbs	33 ft-lbs	
7/16	14	32	37	49	45	52	70	53	
1/2	13	49	57	75	69	80	106	81	
9/16	12	71	82	109	100	115	154	117	
5/8	11	98	113	150	138	159	212	161	
3/4	10	173	200	267	245	282	376	287	
7/8	9	279	322	429	394	455	606	462	
1	8	418	483	644	591	681	909	692	
1 1/4	7	728	840	1121	1181	1363	1817	1384	
1 3/8	6	955	1102	1469	1548	1786	2382	1815	
1 1/2	6	1267	1462	1950	2055	2371	3162	2409	
Fine Thread Series									
1/4	28	75 in-lbs	87 in-lbs	116 in-lbs	106 in-lbs	123 in-lbs	164 in-lbs	125 in-lbs	
5/16	24	150	174	231	212	245	327	249	
3/8	24	23 ft-lbs	26 ft-lbs	35 ft-lbs	32 ft-lbs	37 ft-lbs	49 ft-lbs	38 ft-lbs	
7/16	20	36	41	55	51	58	78	59	
1/2	20	55	64	85	78	90	120	91	
9/16	18	79	91	121	111	128	171	130	
5/8	18	110	127	170	156	180	240	183	
3/4	16	193	223	297	273	315	420	320	
7/8	14	308	355	474	435	502	669	509	
1	14	470	542	722	663	765	1020	777	
1 1/4	12	806	930	1241	1308	1509	2012	1533	
1 3/8	12	1087	1254	1672	1763	2034	2712	2066	
1 1/2	12	1426	1645	2194	2312	3557	3557	2710	

# Decals

ITEM	DESCRIPTION	PART NUMBER	QTY
1	VRISIMO DECAL SM	DC-119	2
2	KEEP SAFE DISTANCE	DC-363	4
3	READ BEFORE OPERATING	DC-220	1
4	CAUTION MOVING PARTS	DC-270	1
5	KEEP GUARDS IN PLACE	DC-296	2
6	QR CODE PRODUCT REGISTRATION	DC-354	1
7	PROP 65 WARNING	DC-308	1
8	540 RMP	DC-348	1





MiniMax Flail Mower  
Owner's Manual  
REV: 260225

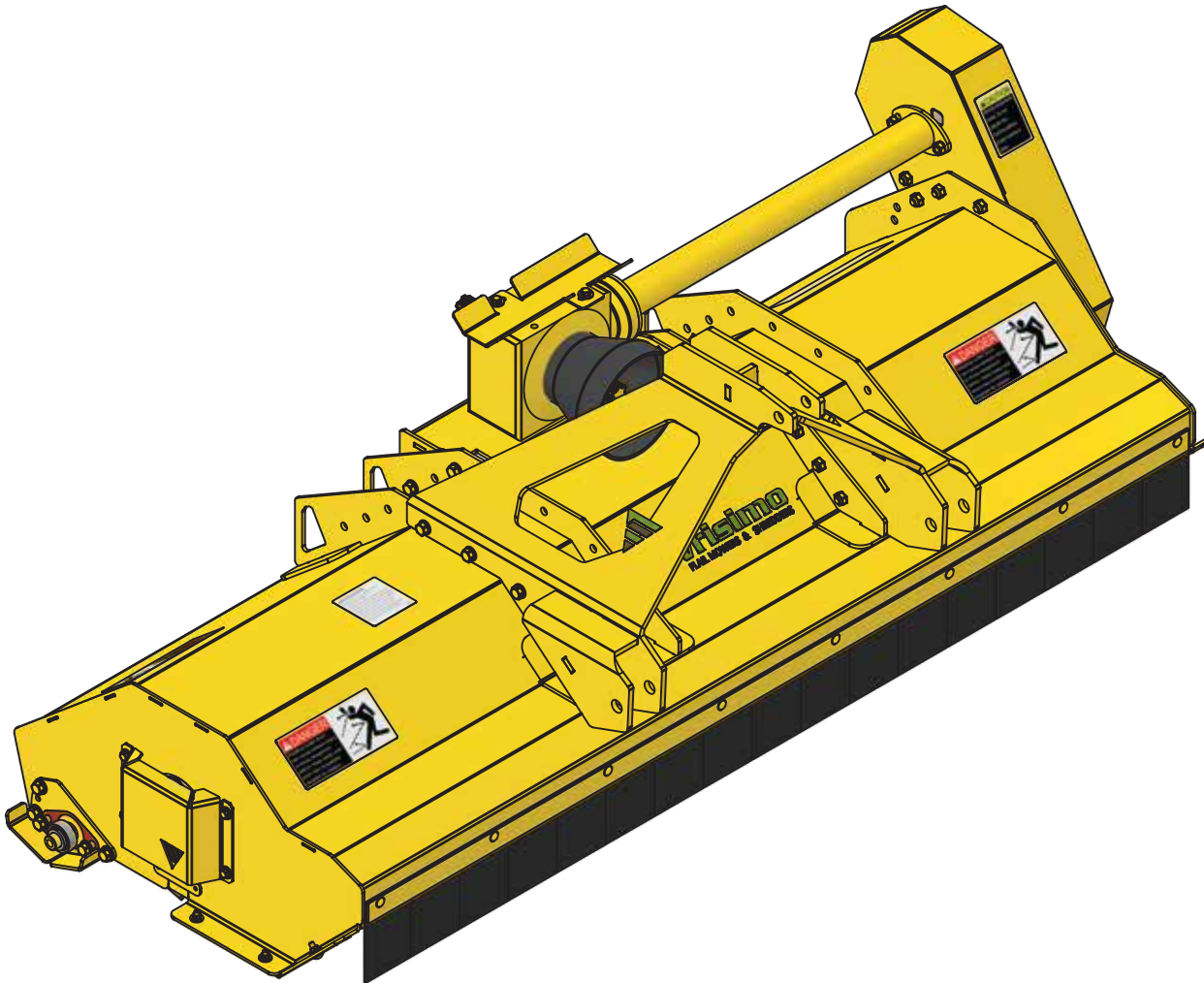

MINIMAX OWNER'S MANUAL



**VALLEY TOOL**  
MANUFACTURING COMPANY

PO Box 220 | 2507 Tully Road | Hughson, CA 95326 | 800-426-5615  
[www.valleytoolmfg.com](http://www.valleytoolmfg.com)