

Sanitizer Orchard Mulcher  
Owner's Manual



**Vrisimo**  
FLAIL MOWERS & SHREDDERS



**VALLEY TOOL**  
MANUFACTURING COMPANY

PO Box 220 | 2507 Tully Road | Hughson, CA 95326 | 800-426-5615  
[www.valleytoolmfg.com](http://www.valleytoolmfg.com)



## Table of Contents

### Introduction

Thank You	1
Warranty	2

### Safety

Operational Safety	3
Maintenance Safety	4

### Basic Operation

Attaching to Power Unit	5
Starting Procedure	6
Running Attachment/Shut Down Procedure	7

### Adjustments & Maintenance

Lubrication	8
Cutting Height Adjustments	9
Wearable Components	10
Cleaning the Attachment	11

### Transport, Removal, Storage

Transport, Removal, Storage	12
-----------------------------	----

### Frequently Asked Questions

Frequently Asked Questions	13
----------------------------	----

### Parts Book

Top Level Front	15
Top Level Rear	16
Cutter Drum	17
Drive Bearing Housing	18
Idle Bearing Housing	19
Top Shaft Extension	20
Linch Pin	21
Knife Assembly	22
BackRoller/Cutter Drum Assembly	23
PTO Shaft Assembly	24
Gearbox Assembly	25
Scraper Assembly	26
Decals	27

# Thank You

---

Dear Customer,

We appreciate your purchase of a Vrisimo attachment. The purpose of this manual is to familiarize you with the operation, adjustment, and maintenance of your new attachment. It was meticulously designed and constructed in accordance with the highest industry standards to provide you with years of dependable service. Before endeavoring to operate the machine, you must read this manual thoroughly and comprehend its operation. Vrisimo reserves the right to make modifications to design and specifications, as well as additions and enhancements to its product, without incurring any obligation to retrofit previously manufactured items. If you ever require additional information, please contact your authorized dealer or customer service.



PO Box 220 | 2507 Tully Road | Hughson, CA 95326

1-800-426-5615

[www.valleytoolmfg.com](http://www.valleytoolmfg.com)

Vrisimo designed this attachment with operator safety as one of its primary considerations. This attachment was designed with shielding, simple adjustments, and other safety features whenever practicable. Ensure that you and your employees read and comprehend this manual. Only responsible individuals who have been trained to operate in a secure manner and who have read and comprehend this manual should operate any machinery.

***Before accepting the equipment, verify the pre-delivery checklist thoroughly with the sales representative. See page 5.***

***Ensure that you have a comprehensive understanding of the operation, adjustment, and safety principles outlines in this manual.***

Vrisimo Attachments is solely owned by Valley Tool and Manufacturing.

Visit: [www.valleytoolmfg.com](http://www.valleytoolmfg.com)

***Product Registration***



Valley Tool & Mfg. warrants each product to be free of manufacturing defects for a period of twelve months (ninety days for rental units) from the date of delivery to the original user/owner, subject to the limitations stated in this policy.

This warranty does not apply to defects caused in whole or in part by unreasonable use while the product is in the user's possession, including but not limited to: failure to properly set up product; failure to provide reasonable and necessary maintenance; normal wear; routine tune-ups or adjustments; improper handling or accidents; operation at speed or load conditions contrary to published specifications; improper or insufficient lubrication; improper storage. This warranty also does not guarantee that the efficacy of every product will meet the purchaser's expectations.

Valley Tool & Mfg. shall not be liable for consequential damages of any kind, including, but not limited to, consequential labor costs or transportation charges associated with the replacement or repair of defective parts; lost time or expenses incurred as a result of said defects. Valley Tool & Mfg.'s total liability is limited to the purchase price of the product.

Valley Tool & Mfg. provides no warranty for trade accessories or any component or accessory of the product that was not manufactured by Valley Tool & Mfg., including any purchased components. These are subject to the respective manufacturer's warranties. If the product or any part of the product is modified or repaired in any manner not expressly authorized by Valley Tool & Mfg., or if closed components are disassembled prior to return, the warranty will be void. Closed components include gearboxes, hydraulic pumps, motors, cylinders, and actuators, among others.

Our obligation under the warranty is expressly limited, at our option, to the replacement or repair at Valley Tool & Mfg., of Hughson, California, or at a service facility specified by us, of the defective part or parts as determined by inspection.

We are not liable for unauthorized replacements or repairs. Warranty pre-approval is required. Authorized supplies will be sent to the dealer at no cost via UPS Ground. The duration of any implied or statutory warranties, such as warranties of merchantability or fitness for a particular purpose, is expressly limited to the duration of this written warranty. No one is authorized to make any other express or implied warranties on our behalf. This warranty cannot be extended, expanded, or altered unless authorized in writing by Valley Tool & Mfg. No warranty will be processed without a timely, signed "Product Registration"

The attachment owner is responsible for the travel time of mechanics and conveyance of the product to the authorized service dealer for warranty work.

The most reasonable and dealer-friendly return policy on the market is provided by Valley Tool & Mfg. The return policies for each of our brands are listed below. We accept returns within 30 days of the date of original shipment. Prior to return shipment, all returns must be approved by Valley Tool & Mfg, and a return authorization number must be issued. Returns must be in "like-new" condition and accompanied by all original factory packaging, including instruction manuals. If an item is received that is not in "like-new" condition or in its original packaging, additional fees will apply. After our staff has completed a thorough inspection of a return, refunds will be issued less shipping fees and any other potential damage fees. Please allow up to 30 business days for the processing of your account refund credit.

Please direct all return-related questions to [sales@valleytoolmfg.com](mailto:sales@valleytoolmfg.com).

# Safety

Safety messages are provided in this manual to describe possible risk during operation, maintenance and transportation. These messages are intended to convey known hazards but cannot be construed to describe all possible risks.

Signal words in Safety Messages:

## **DANGER**

Danger: Indicates immediate risk of serious injury or death.

## **WARNING**

Warning: Indicates possibility of serious injury or death.

## **CAUTION**

Caution: Indicates possibility of minor injury.

## **NOTICE**

Notice: Indicates possibility of property damage, possible machine failure but no immediate risk to personal injury.

Failure to heed any of these warnings may result in personal injury or death.

## Operational Safety

Before operating this machinery read the owner's manual thoroughly. Properly train all Operators. It is the Owner's responsibility to ensure all Operators are properly trained in the appropriate language. Use OSHA approved eye, ear and head protection to protect the Operator from flying debris and noise. Never use drugs or alcohol before or during operation of this machine. Only operate this machine when it is in good working order on an appropriate power unit that is in good working order, and with all guards and safety devices in place and functioning. Never allow children or other people to ride on this machine.

## **DANGER**

Keep bystanders and children of the clear work area during operation as debris can be discharged and cause serious injury or death. Maintain a minimum distance of 300 ft.



## **DANGER**

Risk of death or injury if moving parts are touched, or are brought into contact with any person. Keep away from all moving parts. Keep guards in place while operating.

Operate only with clear visibility, never in dusty, foggy conditions or at night. Risk of collision or contact with personnel. Crushing, piercing or cutting hazard.

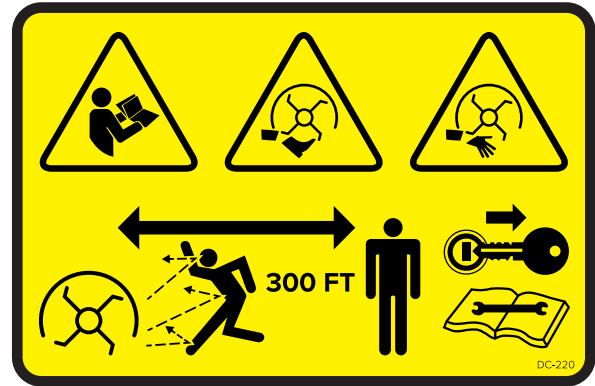

## **WARNING**

Avoid operation that would allow hydraulic lines to be pinched or severed. In the event of a hydraulic leak, hydraulic fluid may have sufficient force to penetrate skin. Do not use any body part to check for leaks. High pressure oil can cause severe injury or death.

Disengage hydraulics, shut off engine and allow all movement to stop before leaving the operator's position to adjust, lubricate, clean or unclog the machine. Do not try to uncouple hydraulic hoses unless the pressure has adequately dissipated.

Risk of serious injury or death due to thrown debris or broken knives. Do not operate closer than 300 ft to people, unprotected roadways or public areas without properly securing or warning protecting against accidental ingress. Risk of fire due to knife contact with stones, concrete, steel or other hard objects. Sparks can ignite dry grass, wood chips or other flammable material. Do not operate in dry grass, severe fire risk areas or in an area actively burning or recently burned. Consult local requirements around operation during Fire Weather Watch or Red Flag Warning conditions.

## **CAUTION**

Rotating parts, Hydraulic hoses, motors and valves generate heat when operating. Do not touch when hot. Allow to cool before maintaining.

Risk of crushing, pinching or cutting due to motion of machine while maintaining. Ensure all energy is dissipated from hydraulic lines before maintaining. Secure power unit and attachment against motion with wheel chocks, or appropriately sized stands as required.

Remove key from power unit and read manual before maintaining. Risk of accidental motion if key is engaged on power unit. Knives wear parts and damaged components can have sharp edges that cause cuts or lacerations. Wear protective gear and handle these parts with care.



# Basic Operation

## Pre-Delivery Checklist

- Check all nuts and bolts for correct torque.
- Check for shipping damage. If damaged, do not use the attachment until parts have been replaced or repaired.
- Check that all hydraulic hoses and fittings are tight.
- Check that all warning signs (decals) and safety treads are on the attachment and in their correct location. Replace any damaged signs or safety treads.

Review all safety information outlined in safety section of manual before proceeding with any operation of attachment.

## Attaching to Power Unit

The Sanitizer Orchard Mulcher can be hooked up to any 3-point hitch within its category and 540 PTO tractors. The tractor's drawbar should be placed to its shortest point. If there is still insufficient clearance, then it should be removed. On tractors with load and depth control, lock out control so it will not function but still be in "free float".

- Back the tractor so the lift link are in-line with the mower's hitch pins.
- Shut off engine and disengage PTO. Block tractor wheels before you place yourself between the tractor and the mower.
- Attach the tractor's left and right links to the corresponding hitch pins of the mower. Secure both connections with lynch pins.
- Adjust the sway bars so that there is a minimum side slack and be sure the stabilizers are tight.

- Attach the tractor's top link to the "A" frame of the attachment and adjust the top link to the approximate desired cutting height.
- Attach the PTO to the tractor by pushing in on the quick disconnect pin. Remember, the tube end goes to the tractor.

## NOTICE

Before operating the mower under power, operate the drive shaft through the entire lifting range to assure that there is no binding, bottoming, or uncoupling of the shaft connection.

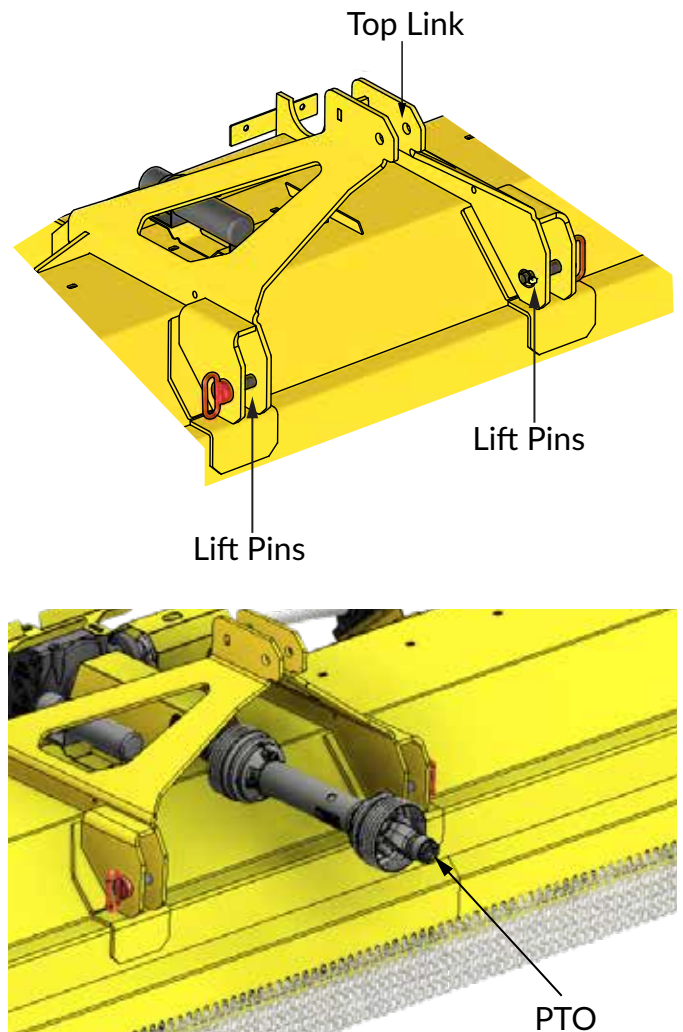

## Starting Procedure

### NOTICE

Do not start the tractor until mower has been carefully checked for correct assembly and installation. Be sure all observers are clear of the machine.

- Check to see that the attachment is in the down position and blades are not touching the ground. Never engage the PTO with the motor above idle speed.
- With the motor at low RPM engage the PTO output slowly bring the throttle up to 540 RPM.

### NOTICE

If excessive vibration occurs, disengage the PTO immediately. Shut off the tractor, find the cause, and fix it. The rotor shaft is electronically balanced to within 2 mils and must stay that way for the machine's life.

- Shut off tractor engine, shut off PTO, put tractor in park, set parking brake and check PTO shaft, all bearings and gearbox for excess heat or oil leaks.



# Basic Operation

## Running the Attachment

### NOTICE

The mower should be run at a 540 RPM PTO speed unless it has been specifically designed to run at a higher PTO speed.

- Ground speed should range anywhere from 0-5 miles per hour.
- The skid shoes should be 1/2" to 3" off the ground. Skid shoes are not made to run on the ground.
- The attachment and skid shoes should be level with the ground, the height of the attachment can be adjusted with the back roller which runs along the ground.
- Adjust the sway bars so that there is a minimum side slack and be sure the stabilizers are tight.
- Attach the tractor's top link to the "A" frame of the attachment and adjust the top link to the approximate desired cutting height.
- Attach the PTO to the tractor. The tube end goes to the attachment and the bar end goes to the tractor.

### NOTICE

Before operating the mower under power, be sure to check the drive shaft through the entire lifting range to assure that there is no binding, bottoming, or uncoupling of the shaft connection.

## Shut Down Procedure

- When work is completed, disengage the PTO drive and position it for storage or transport (See the "Transport, Removal and Storage" section for details on proper storage). Shut off Power Unit and set parking brake, wait for the attachment to stop rotating.
- Visually inspect the PTO shaft, all the bearings and gearbox for excessive heat or leaks.

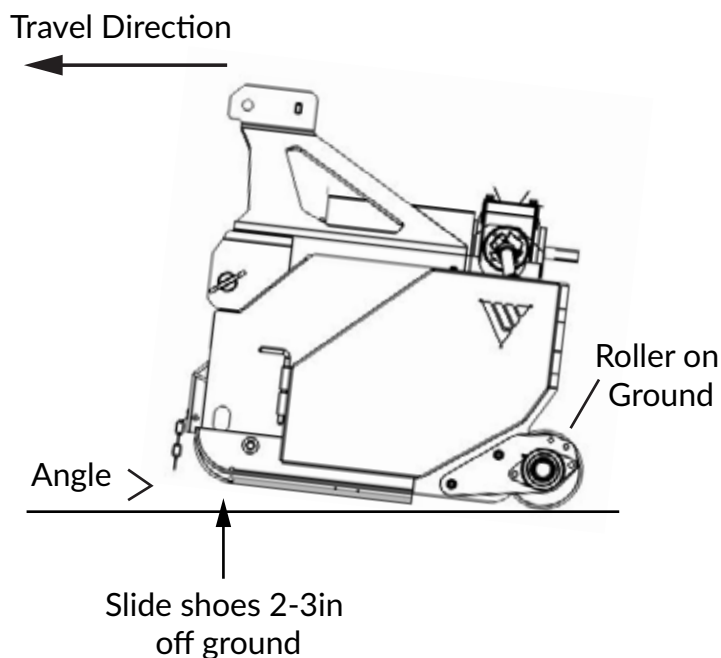

# Adjustments & Maintenance

## Lubrication

### Cutter Drum

1. There are two Grease zerk fittings to lubricate per bearing housing. There is an outer and inner zerk on each side of the mower.
2. Valley Tool recommends greasing with **NLGI 2 ISO VG100**. Any lithium based NLGI 2 grease that is ISO 100 VG and of high quality will work. **DO NOT** use grease designed for tractor pins and bushings.
3. The CD-3001 is factory assembled with grease for over 300 hours of operation, and only requires 6 pumps of grease every 300 hours of operation. Use of pneumatic grease guns is not recommended as it is difficult to control the amount of grease being applied. While it is not necessary to “run-in” the bearing with each grease has been applied the risk of failure can be mitigated by allowing the bearing another “run-in” period.

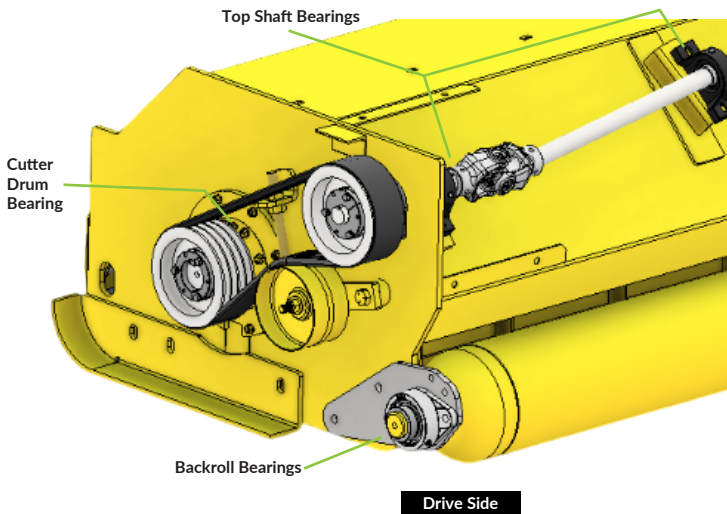

### Note Belt Routing

### Maintenance Table

LUBRICATION	FLUID	HRS
Top Shaft Bearings	NLGI 1.5 ISO VG460	10
Backroll Bearings	NLGI 1.5 ISO VG460	10
Driveshaft Yokes	NLGI 1.5 ISO VG460	10
Driveshaft Slides	NLGI 1.5 ISO VG460	10
Cutter Drum Labyrinth	NLGI 2 ISO VG100	10
Cutter Drum Bearing	NLGI 2 ISO VG100	300
Gearbox	SAE 80W-90	300

### Back Roller

1. The back roller uses a four bolt flange style bearing. There is one on either side of the back roller. Grease daily as the back roller is exposed to the most debris.
2. The back roller bearing uses **NLGI 1.5 ISO VG460** grease and should be greased after each time used. Depending on conditions back roller bearings may require more or less grease.

### Top Shaft

1. All top shaft bearings and yokes need to be greased weekly with **NLGI 1.5 ISO VG460**.

### PTO

1. Grease daily as the PTO shaft can not be over greased. PTO shaft and tractor can be damaged if run dry. PTO shaft will bind up and not telescope in and out properly.
2. The PTO shaft should be greased with any standard grease as long as it is **NLGI 1.5 ISO VG460**.

### Gearbox

1. Check gearbox oil level periodically and refill as required. Replace gearbox oil every 300 hours.
2. Use quality **SAE 80W-90** gear oil. Be sure gearbox is in level position and remove side plug to fill. See FAQ for detail.

# Adjustments & Maintenance

---

## Cutting Height Adjustments

- The cutting height of the attachment can be adjusted from 0-4".
- Adjusting is done shortening or lengthening the top link.
- Under no circumstances should the knives contact the ground.
- The entire weight of the mower should be on the back gauge roller
- The skid shoes should be adjusted so there is 1/2"-3" clearance between them and the ground.
- The shoes are for added protection against tree roots, ridges or borders and are not designed to slide on the ground.
- Adjust the roller by removing the bolts from both sides and resetting it to the correct height.

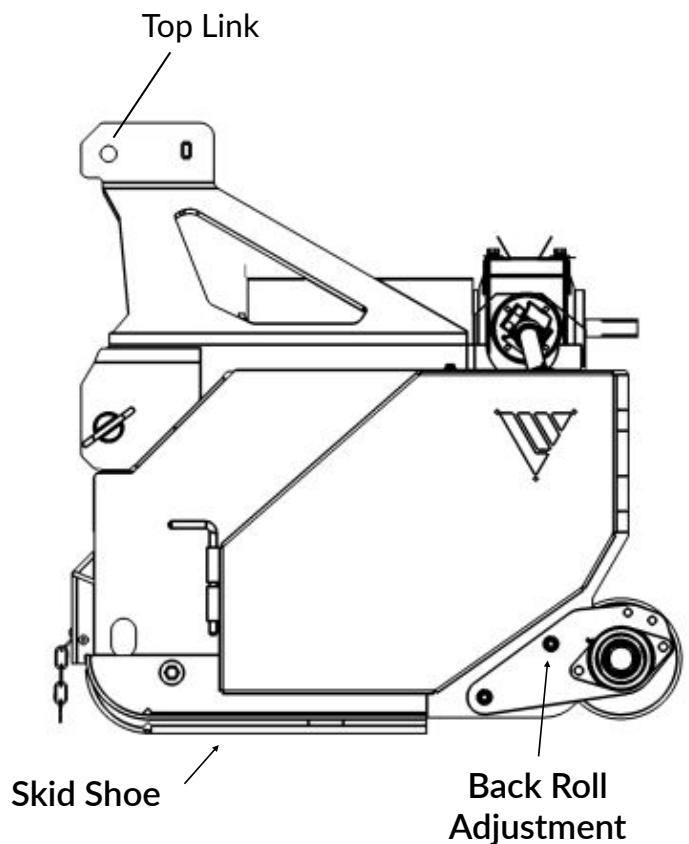

# Adjustments & Maintenance

## Wearable Components

### NOTICE

Wear components such as knives, belts and bearings may wear at different rates so each should be inspected for wear independently. Gloves should always be worn when handling or replacing knives to reduce chance of injury.

- Knives should be replaced when they are worn, lost or broken.
- When individual knives, bolts or spacers become worn or damaged they must be replaced with hardware saved from previous knife replacement.
- Replacing an individual station with new hardware could cause the cutter drum to run out of balance.
- When replacing hardware at all the stations, some old hardware should be saved to replace future broken hardware.
- Replacing the complete knife assembly is done by removing the skid shoes to access Hanger Rods.
- Remove the hanger rod and remove old knife assembly in its station.
- Decals that are no longer visible, damaged, or lost should also be replaced.
- Replaced skid shoes as needed.
- Belt adjustment is done by adjusting the tension rod.

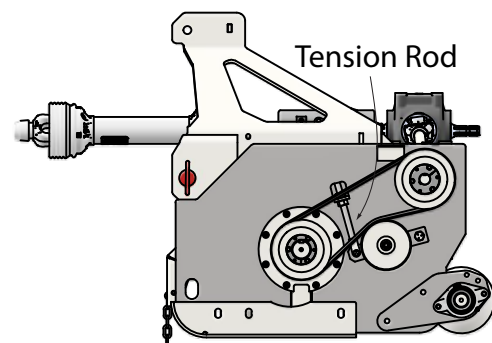
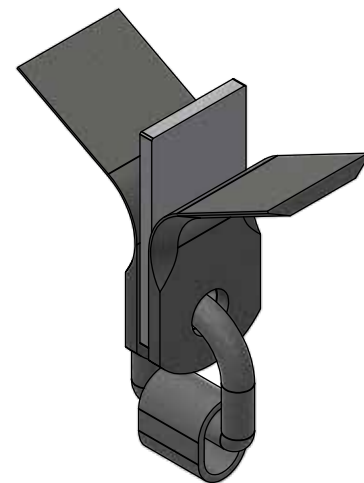
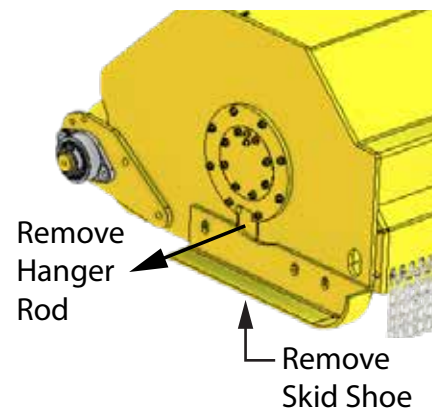

Note: Belt Routing

# Adjustments & Maintenance

## Cleaning the Attachment

### NOTICE

To preserve life of paint and decals, wash the mower after each use. The preservation of your mower's decals is essential to safety.

- Check for excessive grease in bearing areas on the pulley side of the mower. Make sure that grease is not allowed to get into the belt areas.
- Clean any clippings from gearbox areas, pulley areas and anywhere else that is prone to excessive heat where fires can start.
- Clean the inside of the mower with a pressure washer. Make sure the inside of the cutter drum is kept free from mud and compact grass. Mud build up on the cutter drum can cause imbalance.
- Preserve damaged decals or replace them if they are unreadable. Decal kits can be obtained from your local Vrisimo dealer.

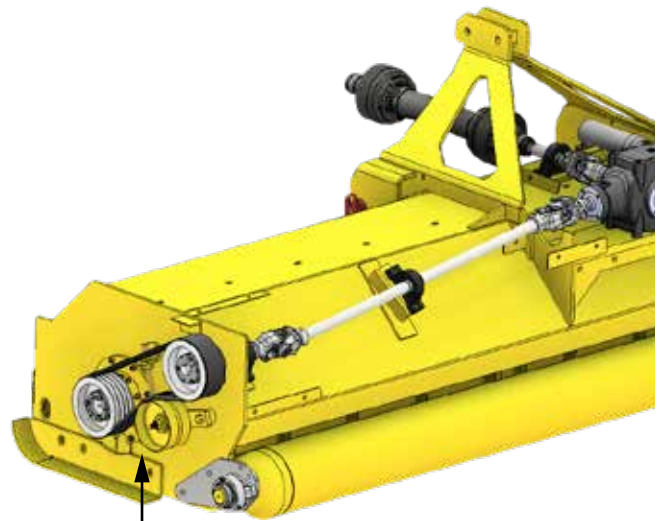

Remove debris from belt

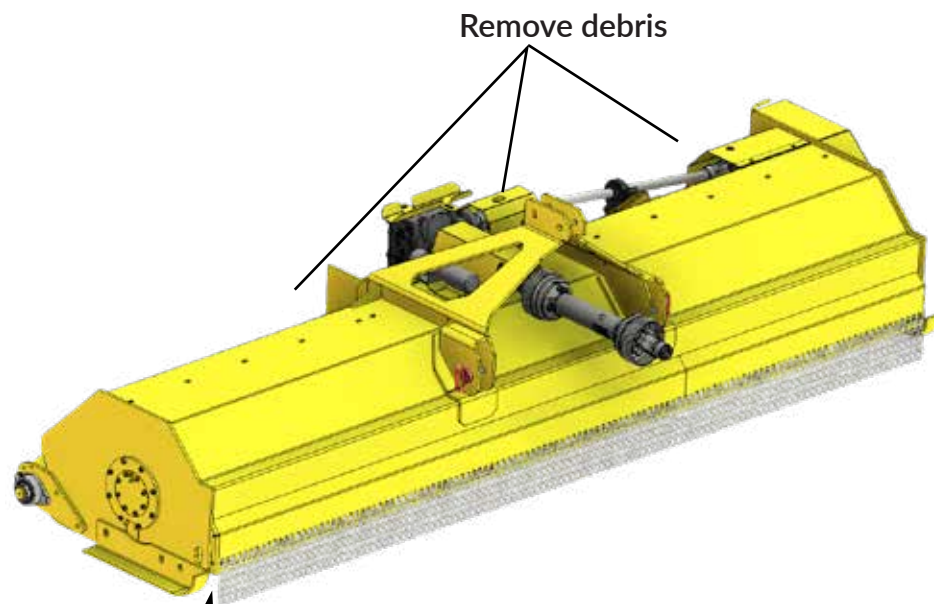

Remove debris

Keep Undercarriage Clean

# Transport, Removal, & Storage

## Transport, Removal, and Storage

### **WARNING**

To Transport, disengage PTO lever before lifting mower to highest transport position. Raising the mower while the PTO is engaged will cause the shaft to bind or break and may cause injury to the operator.

### Transport in Power Unit

- PTO must be disengaged, unit lifted off the ground.

### Transport on Trailer

- Chain down attachment even if unit is still attached to tractor, secure PTO shaft.

### Removal

- Remove the adjustable top link from the tractor and mower.
- Disconnect the drive shaft, store in a clean, dry place.
- Remove the safety pins from the lower three point arm pins and pull the arms off the pins.

### Storage

- Put the drive shaft away in a clean dry place.
- Clean the thoroughly.
- Relax belt tension.
- Lubricate the mower as recommended.
- Check oil level in gearbox and fill as required.
- Check for worn parts and replace so you will be ready to work when necessary.
- Store in a clean, dry place.

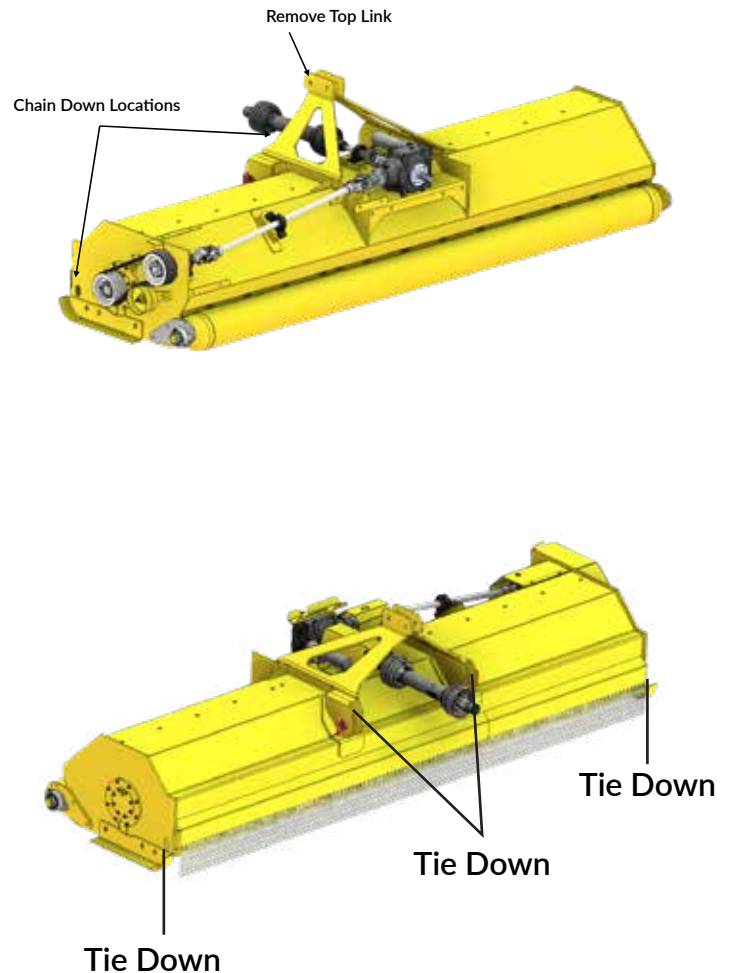

# Frequently Asked Questions

---

## Frequently Asked Questions

**Q. Where is the serial number located on the machine?**

A. The serial number is located on the top of the attachment.

**Q. Where are replacement parts sold?**

R. Check local dealer or ask to order from Valley Tool.

**Q. How often should knives be replaced?**

A. When the cut begins to be inconsistent or rough, consider replacing the knives. It is recommended to keep an extra set of knives on hand to reduce downtime.

**Q. Does the gearbox need to be filled with oil before use?**

A. No, the gearbox comes full with oil. Use 90 weight oil when replacing.

**Q. When should gear oil be replaced?**

A. When replacing gear oil, fill from the Upper Fitting. When oil level reaches Lower Middle Fitting, the box is full.

**Q. What to do if belts are wearing out too fast and burning up?**

A. Check belt tension (about 3/8" of deflection) and adjust as needed. If slipping continues, raise the cutting height and slow travel speed, especially when mowing grass over tow feet tall.

**Q. What to do if skid shoes are wearing out too fast?**

A. Operate the attachment with the skid shoes 0.5-3 inches off the ground.

**Q. How to prevent PTO Shaft from coming off during operation?**

A. Make sure the shaft is slid all the way on and the safety pin is in the locked position.

**Q. Are there any advantages to reversing cutter drum rotation?**

A. Reversing the cutter drum depends on the application. Most mowers (except the Roadsider) use reverse rotation, which throws material toward the tractor. Reversing rotation is useful mainly for industrial mowing—such as along freeways, in debris-heavy areas, or with front-mount or Roadsider models—offering safety benefits rather than cutting-quality improvements.

**Q. How to replace knives?**

A. Refer to the Adjustments and Maintenance Section for a detailed explanation.

**Q. When connecting the PTO shaft, can it go on either way?**

A. The PTO shafts for these mowers are side specific. The tube half of the PTO shafts for these mowers and the bar half of the PTO shaft goes to the tractor.

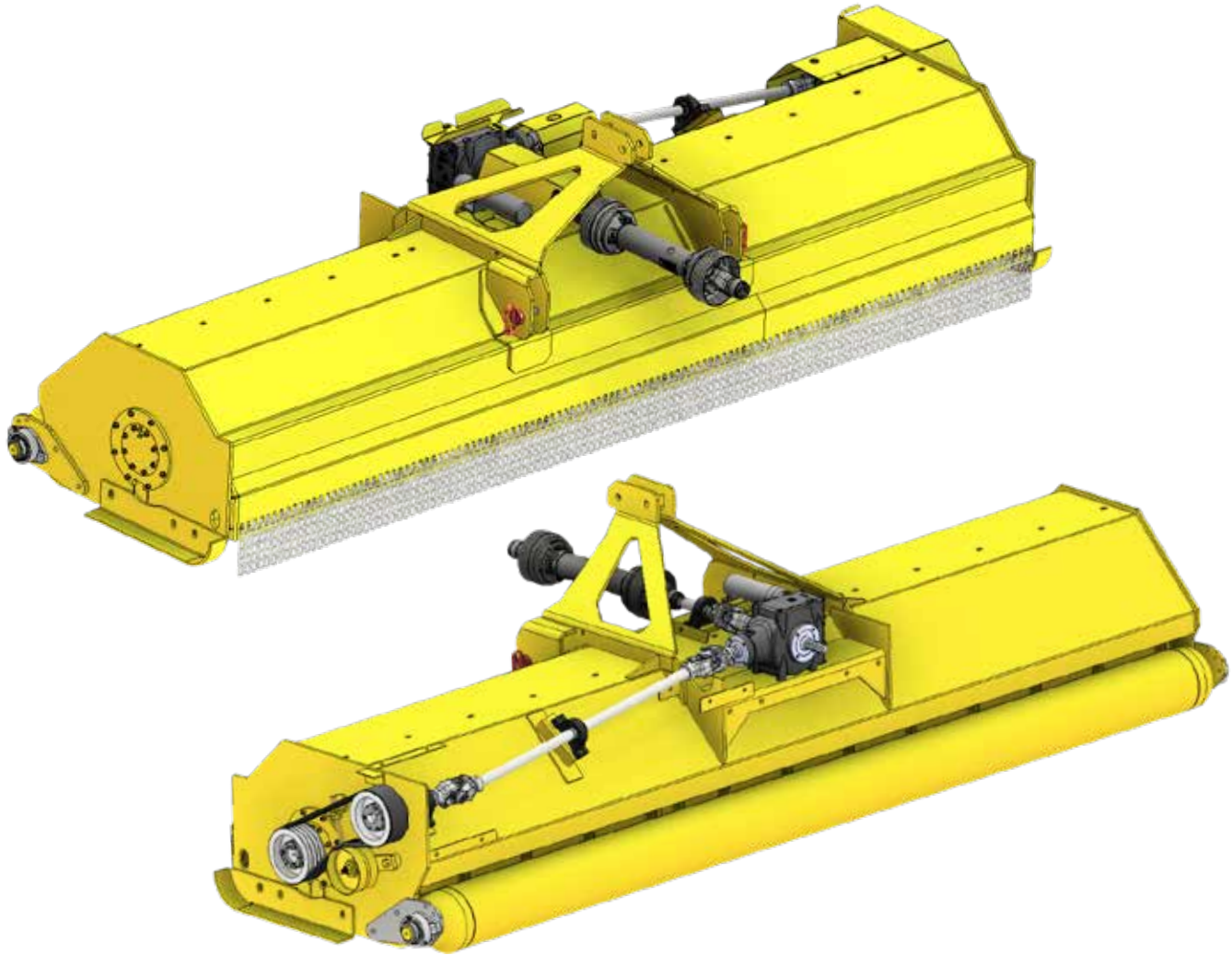

**VALLEY TOOL**  
MANUFACTURING COMPANY

**Order Parts Online**  
[shop.valleytoolmfg.com](http://shop.valleytoolmfg.com)

- Shop OEM Parts
- Fast Shipping
- Easy Checkout

QUESTIONS: [Parts@Valleytoolmfg.com](mailto:Parts@Valleytoolmfg.com)



# Top Level Front

ITEM	DESCRIPTION	PRODUCT NUMBER	QTY
3	Sanitizer Shield Weldment SM2144	11667	1
4	ASY SKID SHOE LH	11670	1
5	ASY SKID SHOE RH	11671	1
9	Assembly - Belt Guard	PA-8006	1
13	PTO Shaft Holder	2503-VR-3	1
14	Guard - PTO Input	0513-VR-3	1
15	Guard - PTO Output	0564-VR-3	1
16	Guard - Top Shaft Extension	M-4016	1
20	DRIVESHAFT LP PTO 75HP 1.38 Z6	DS-2600	1
22	Document Holder- Large	DC-100	1
26	Category 2 Pin	TP-2810	2
35	BEARING 1 3/8 IN 2 BOLT FLANGE		1
36	CHAIN 1/4X1 6 LINK FOR FH	09611	120

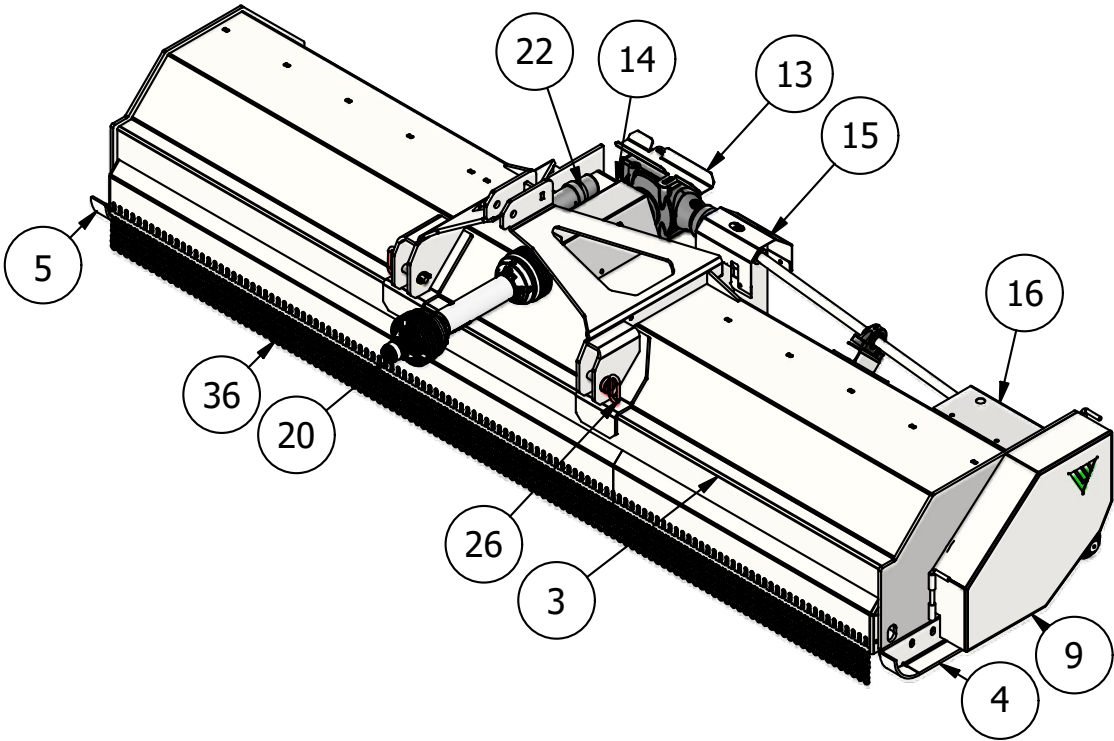

# Top Level Rear

ITEM	DESCRIPTION	PRODUCT NUMBER	QTY
8	Assembly - Drive Bearing Housing-CD-3002	CD-3002	1
12	Top Shaft 2144	2462-VR-2	1
	Top Shaft 2120	2460-VR-2	1
17	Back Roller Mounting Plate-Sanitizer	04303	2
18	U Joint - 1.375 Spline X 1.375 Spline	DS-2226	1
19	UJOINT TS-1085 1.375 KEYED TO 1.375 Z6	TS-1085	1
21	BANDED BELT 4-GROOVE	B-1745A	1
24	GEAR BOX ASS'Y	BP-2800	1
25	Bushing SK-QD Bushing	TL-1550	1
27	U-JOINT 1 3/8 SMOOTH X2	TS-1084	1
28	Pillow Block Bearing	TS-1300	3
29	Center Shaft LP PTO Input	0758-VR-1	1
33	Sheave 7.4	P-1460	2
35	BEARING 1 3/8 IN 2 BOLT FLANGE		1
37	BEARING 2BLT FLG 1IN BALL ECC LK		2
38	QD Bushing	TL-1540	1

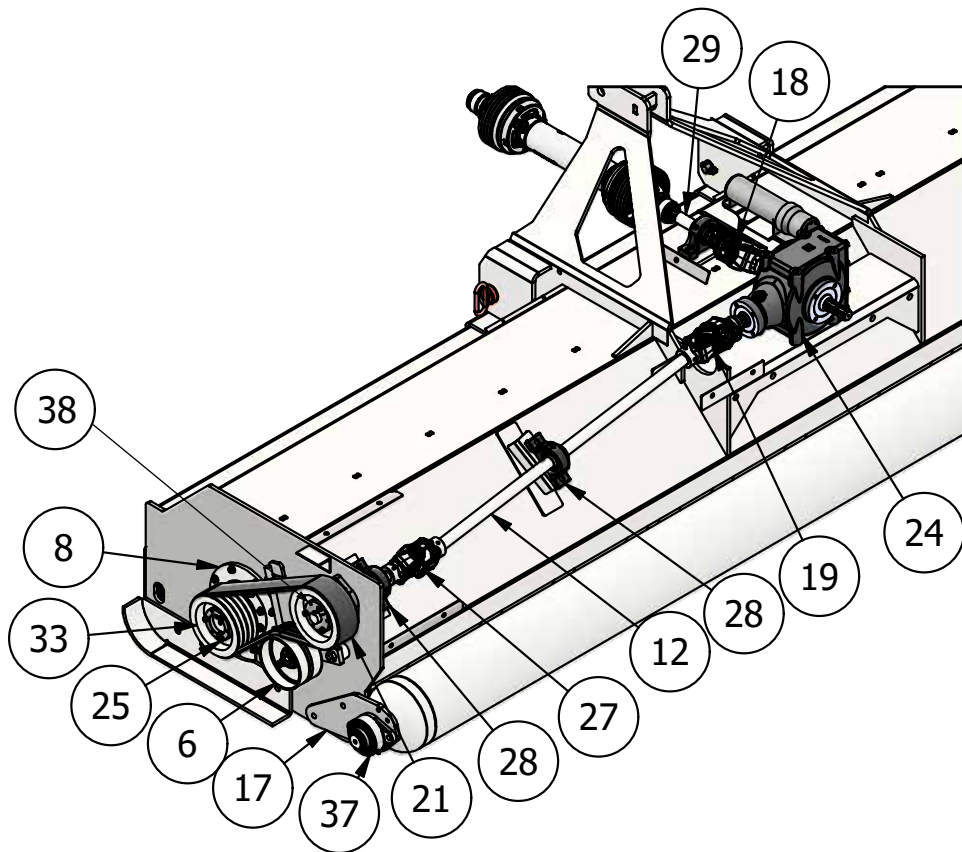

# Cutter Drum Assembly

ITEM	DESCRIPTION	PRODUCT NUMBER	QTY
1	Assembly - Sanitizer Knife	06114	68
2	Hanger Rod LP2144 Cutter Drum	CD-1970	4
	Hanger Rod 2120		4
3	SM2144 Cutter Drum Weldment	06105	1
	SM2120 Cutter Drum Weldment		1
4	Chain Hanger Rod-SM.2144	11672	1

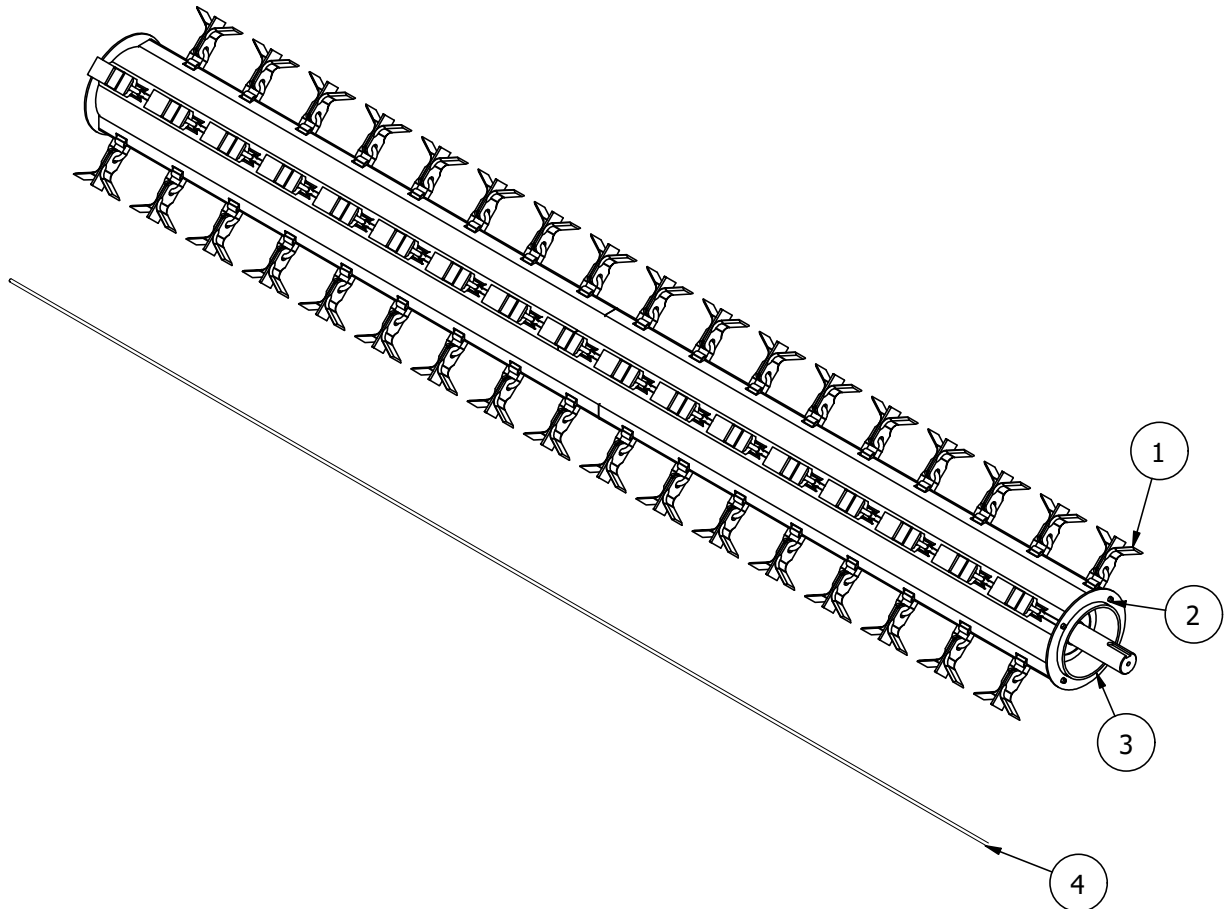

# Drive Bearing Housing

ITEM	DESCRIPTION	PRODUCT NUMBER	QTY
1	FHCS 3/8-16 X 1.5 GR5 CL ZN	92979A352	16
2	Dichtomatik Shaft Seal - LP Housing	243354SA	2
3	BEARING SPHR 2.4375 W22213EC-39	CD-3100	1
4	GPB-Grease Nipples	HY-2441	2
5	4-3/4" Internal Retaining Ring	SR-1200	1
6	Bearing Housing	2655-VR-1	1
7	Wire Guard LP SERIES	2659-VR-3 A	1
8	Housing Cover - Drive	2657-VR-3	1

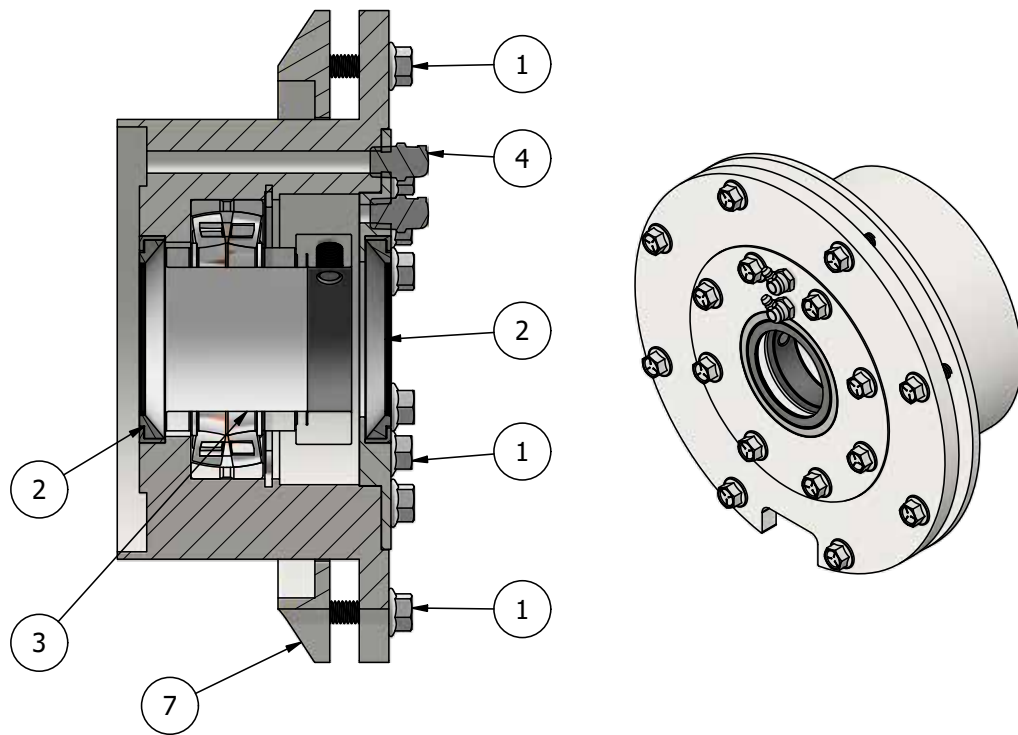

# Idle Bearing Housing

ITEM	DESCRIPTION	PRODUCT NUMBER	QTY
1	Wire Guard LP SERIES	2659-VR-3	1
2	FHCS 3/8-16 X 1.5 GR5 CL ZN	92979A352	16
3	Dichtomatik Shaft Seal - LP Housing	243354SA	1
4	BEARING SPHR 2.4375 W22213EC-39	CD-3100	1
5	Grease Zirk - 1/4" MNPT Straight	HY-2440	2
6	Bearing Housing	SR-1200	1
7	Wire Guard LP SERIES	2655-VR-1	1
8	Housing Cover - Idle	2656-VR-3	1

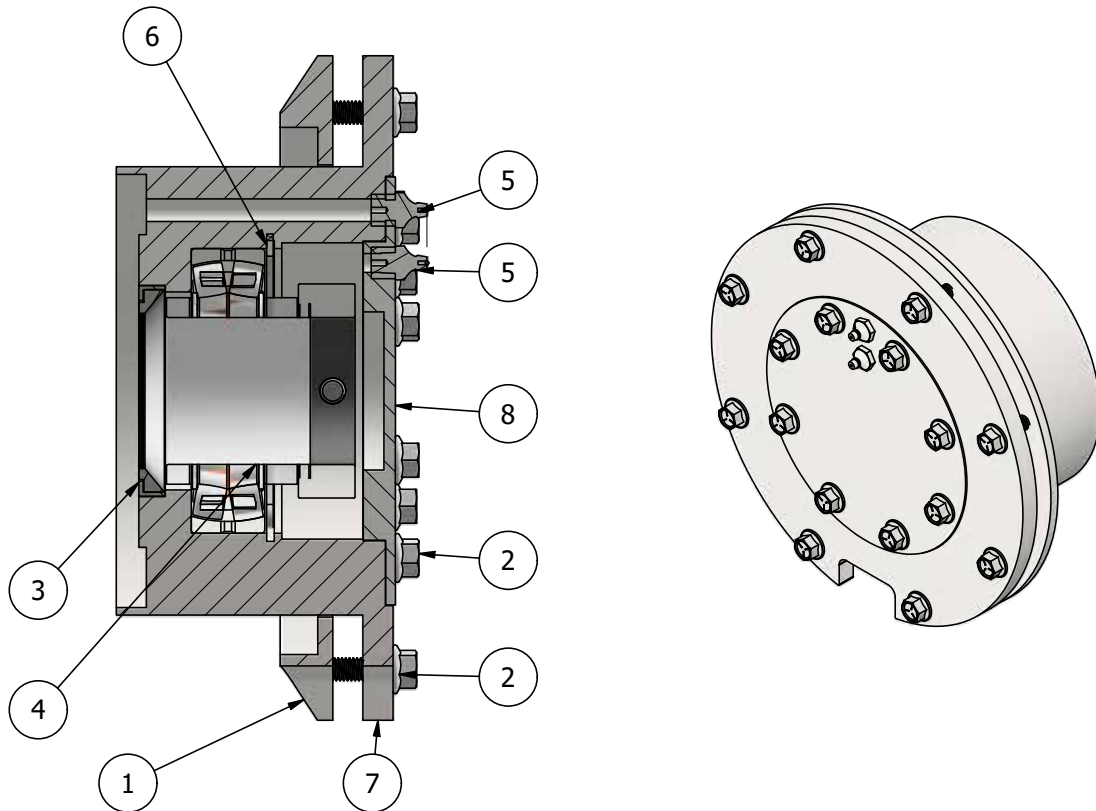

# Top Shaft Extension

ITEM	DESCRIPTION	PRODUCT NUMBER	QTY
1	Top Shaft Extension	147-VR-2	1

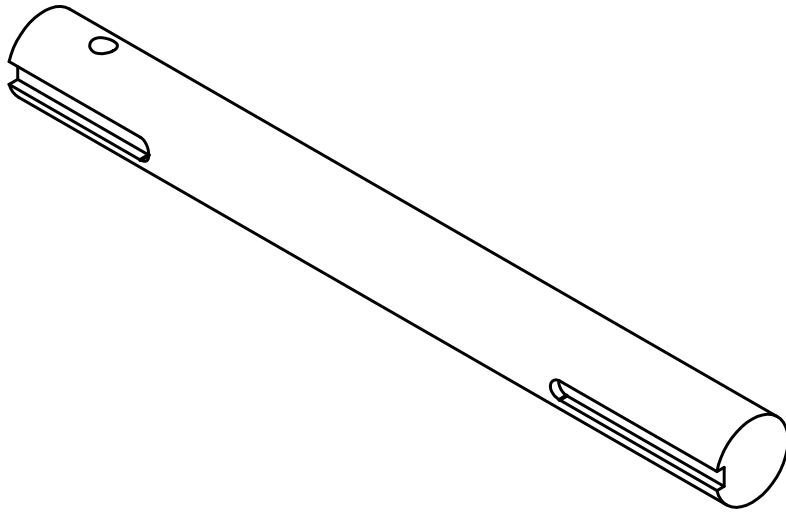

# Linch Pin

ITEM	DESCRIPTION	PRODUCT NUMBER	QTY
1	LINCH PIN 7/16IN	P-791	1

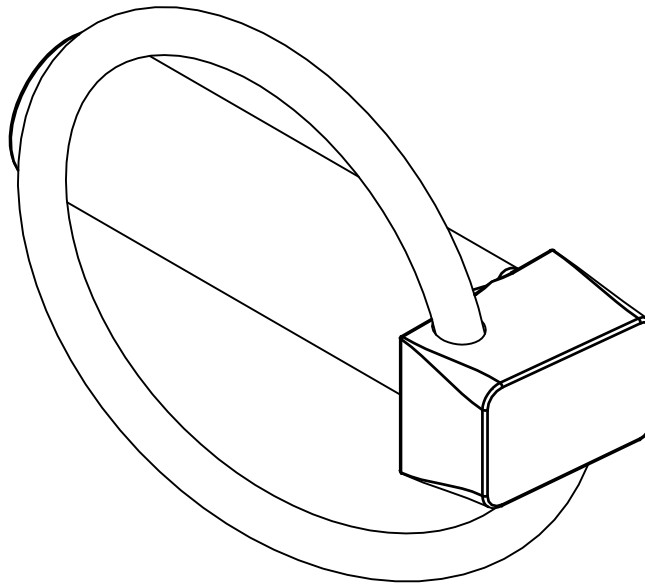

# Knife Assembly

ITEM	DESCRIPTION	PRODUCT NUMBER	QTY
1	Standard Hanger	CD-2120	1
2	1/2 in D-Ring	CD-2135H	1
3	KNIFE INDUSTRIAL FLAIL	CD-2700	2
4	Sanitizer Mower Center Knife	1917-VR-3	1

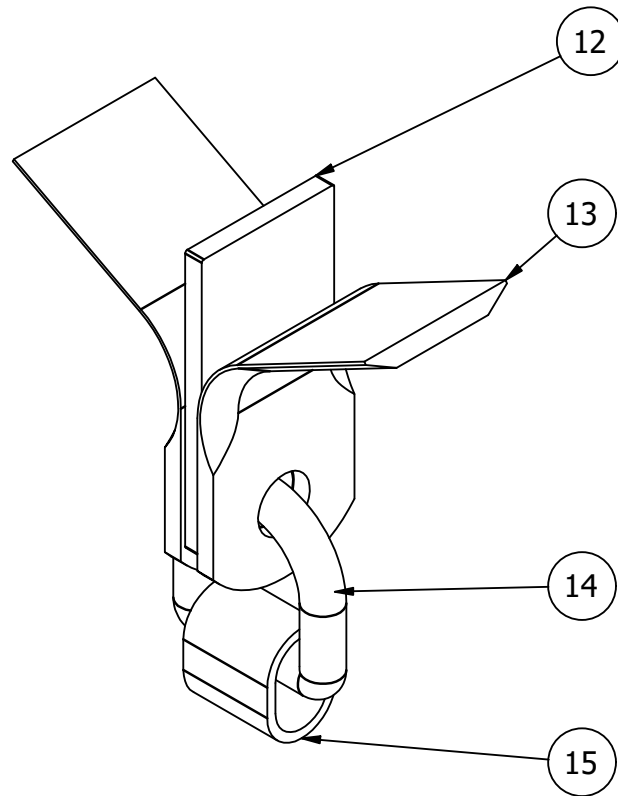

# Back Roller/Cutter Drum Assembly

ITEM	DESCRIPTION	PRODUCT NUMBER	QTY
1	BACK ROLLER MOUNTING PLATE	04303	2
2	BACK ROLLER BEARING	BR-2403	2
3	BACK ROLLER (NOT SHOWN) (SM2120)	04304	1
4	BACK ROLLER (SM2144)	04305	1

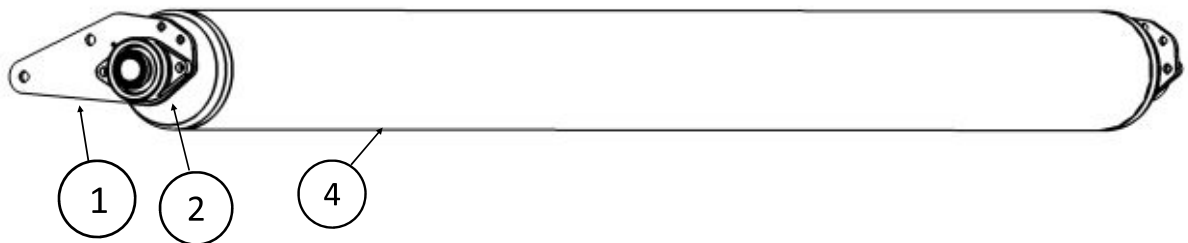

# PTO Shaft Assembly

ITEM	DESCRIPTION	QTY
	12'-15' PTO 2600	1
A	JOINT & SHAFT HALF ASSEMBLY. WITH GUARD	1
B	JOINT & SHAFT HALF ASSEMBLY	1
C	JOINT & TUBE HALF ASSEMBLY. WITH GUARD	1
D	JOINT AND & TUBE HALF ASSEMBLY	1
1	SSL/ AUTO-LOCK REPAIR KIT DRIVE LINE	1
2	SAFETY SLID LOCK YOKE ASSEMBLY	2
3	35E CROSS & BEARING KIT	2
4	YOKE & SHAFT	1
5	GUARD REPAIR KIT	1
6	SAFETY SIGN	1
7	OUTER GUARD	1
8	INNER GUARD	1
9	SAFETY SIGN	1
10	GUARD REPAIR KIT	1

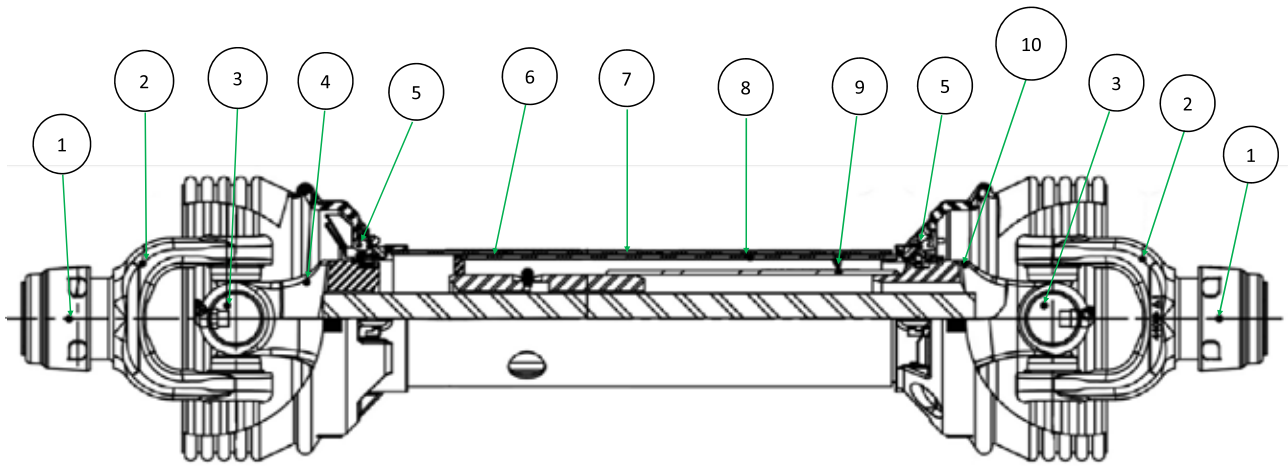

# Gearbox Assembly

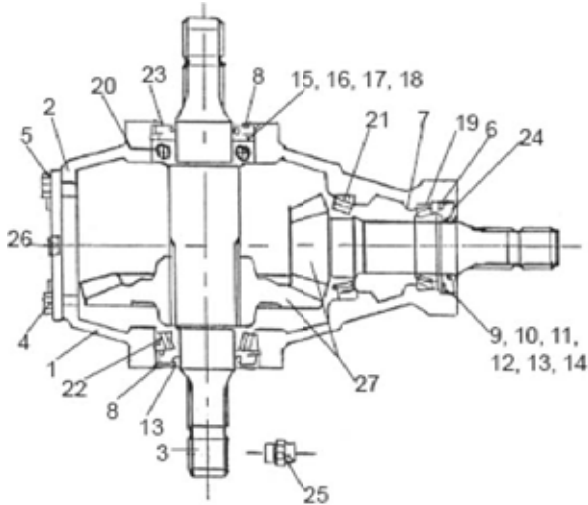

ITEM	DESCRIPTION	PRODUCT NUMBER	QTY
1	MAIN HOUSING	BP-2801	1
2	REAR COVER	BP-2802	1
3	Top Shaft LP2144	BP-2803	1
4	CAP SCREW	BP-2805	4
5	WASHER	BP-2806	4
6	SNAP RING	BP-2806	1
7	SNAP RING	BP-2807	2
8	SNAP RING	BP-2808	2
9	SHIM OUTPUT SHAFT 0.5MM	BP-2809	A/R
10	SHIM OUTPUT SHAFT 0.8MM	BP-2810	A/R
11	SHIM OUTPUT SHAFT 1.0MM	BP-2811	A/R
12	SHIM OUTPUT SHAFT 0.3MM	BP-2812	A/R
13	SHIM OUTPUT SHAFT 0.4MM	BP-2813	A/R
14	SHIM OUTPUT SHAFT 0.2MM	BP-2814	A/R
15	SHIM INPUT SHAFT 0.6MM	BP-2815	A/R
16	SHIM INPUT SHAFT 0.8MM	BP-2816	A/R
17	SHIM INPUT SHAFT 1.0MM	BP-2817	A/R
18	SHIM INPUT SHAFT 0.3MM	BP-2818	A/R
19	BALL BEARING	BP-2820	1
20	BALL BEARING	BP-2821	1
21	TAPERED BEARING ASSEMBLY	BP-2822	1
22	TAPERED BEARING ASSEMBLY	BP-2823	1
23	OIL SEAL, INPUT SHAFT	BP-2824	2
24	OIL SEAL, OUTPUT SHAFT	BP-2725	1
25	BREATHER	BP-2730	1
26	OIL PLUG	BP-2726	4
27	RING AND PINION GEAR SET	BP-2627	1
28	COMPLETE GEARBOX ASSEMBLY	BP-2800	1





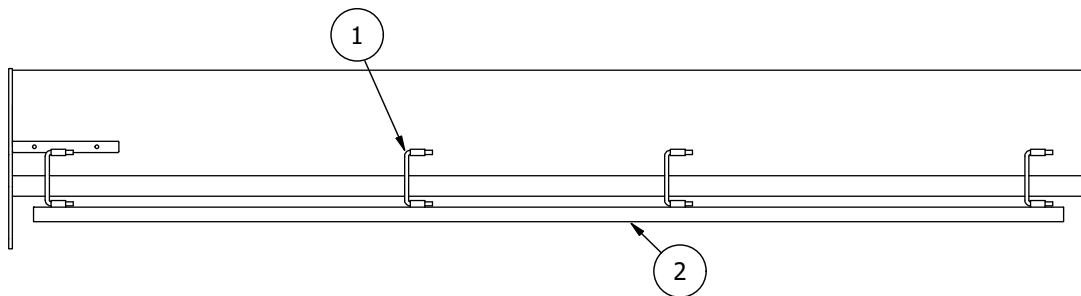













# Scraper Assembly

ITEM	DESCRIPTION	PRODUCT NUMBER	QTY
1	HOOK, BACKROLL SCRAPER	04397	4
2	12' ANGLE, BACKROLL SCRAPER	04399	4
3	10' ANGLE, BACKROLL SCRAPER	04398	1



# Decals

ITEM	DESCRIPTION	PRODUCT NUMBER	QTY
1	VRISIMO SANITIZER LOGO	DC-135	2
2	DANGER ROTATING CUTTER DRUM	DC-101	4
3	READ BEFORE OPERATING	DC-220	1
4	KEEP GUARDS IN PLACE	DC-296	5
5	ROTATING DRIVESHAFT	DC-106	1
6	VRISIMO ICON	DC-113	1
7	BELT TENSION	DC-250	1
8	CAUTION MOVING PARTS	DC-270	1
9	GREASE 200 HOURS	DC-249	1
10	540 RPM	DC-348	1
11	GREASE 300 HOURS	DC-238	3
12	GREASE 10 HOURS	DC-236	10
13	TIE DOWN POINT	DC-232	4
14	GREASE PTO 10 HOURS	DC-240	1
15	SANITIZER STRIPE FRONT	DC-136	1
16	SANITIZER STRIPE BACK	DC-137	1
17	PROP 65 WARNING	DC-308	1
18	PRODUCT REGISTRATION QR CODE	DC-354	1

1 	2 	3 	4 	5 
6 	7 	8 	9 	10 
11 	12 	13 	14 	15 
16 	17 	18 		

Sanitizer Orchard Mulcher  
Owner's Manual  
REV260323



**Vrisimo**  
FLAIL MOWERS & SHREDDERS



**VALLEY TOOL**  
MANUFACTURING COMPANY

PO Box 220 | 2507 Tully Road | Hughson, CA 95326 | 800-426-5615  
[www.valleytoolmfg.com](http://www.valleytoolmfg.com)

SANITIZER ORCHARD MULCHER OWNER'S MANUAL